



Quick Delivery Lab Furnishings Catalog



We have what you need, when you want it!



We have the lab furnishings you need when you want them. Our quick delivery lab furnishings program is much more than just the availability of product. Our experienced team of Furniture Specialists, Project Designers, and Project Managers are ready & available to lead you through the completion of your fast track lab renovation, or new lab project.

Our Furniture Team is organized into focused and coordinated units that offer:

- Clear and easy communication
- In depth planning for every kind of lab
- An extensive inventory of top-quality furniture and components
- Comprehensive project supervision from initial planning through the final installation of your project

Table of Contents

Casework

CornerStone Inset Steel Casework	3-11
Wood Casework	12-21

Hoods and Enclosures

Isolator ³ Bench Top Fume Hoods	22-23
Isolator Walk In Fume Hoods	24-25
Fume Hood Fittings and Accessories	26-27
Variable Air Volume Fume Hood	
Controller	28
Auto Sash Controller	29
Exhaust System Recommendations	30
Ductwork and Accessories	31-32
Fume Hood Fans	33
Exhaust Snorkels	34-35

Shelving Systems

Brushed Zinc Bench Shelving System	37-38
Shelves, Retaining Lips and Reagent Poles	39
Painted Bench Shelving System	40-41

Lab Workstations and Tables

Heavy Duty Steel Tables	42-43
Envision Workstations	44-47
Lab Workstations	48-49
Balance Tables	50
Technical Workstations	51-53
Technical Workstation Accessories	54-55

Work Surfaces

Modular Work Surfaces	56-58
-----------------------	-------

Fittings and Faucets

Faucets	59
Service Valves	60
Electrical and Pegboards	62

Emergency Equipment

Eyewashes and Showers	61
-----------------------	----

Sinks

Epoxy and Stainless Steel Hand Wash Sinks	63
Stainless Steel Sinks	64

Seating

Chairs	65-68
Stools	67

Lab Furniture Accessories

Raceways and Task Lighting	69
Cylinder Restraints	70
Bio-Trapper Waste Container	71

Lab Design Guidelines

Design Considerations and Goals	72-75
Elements of an Efficient Lab	76
Lab References and Standards	77

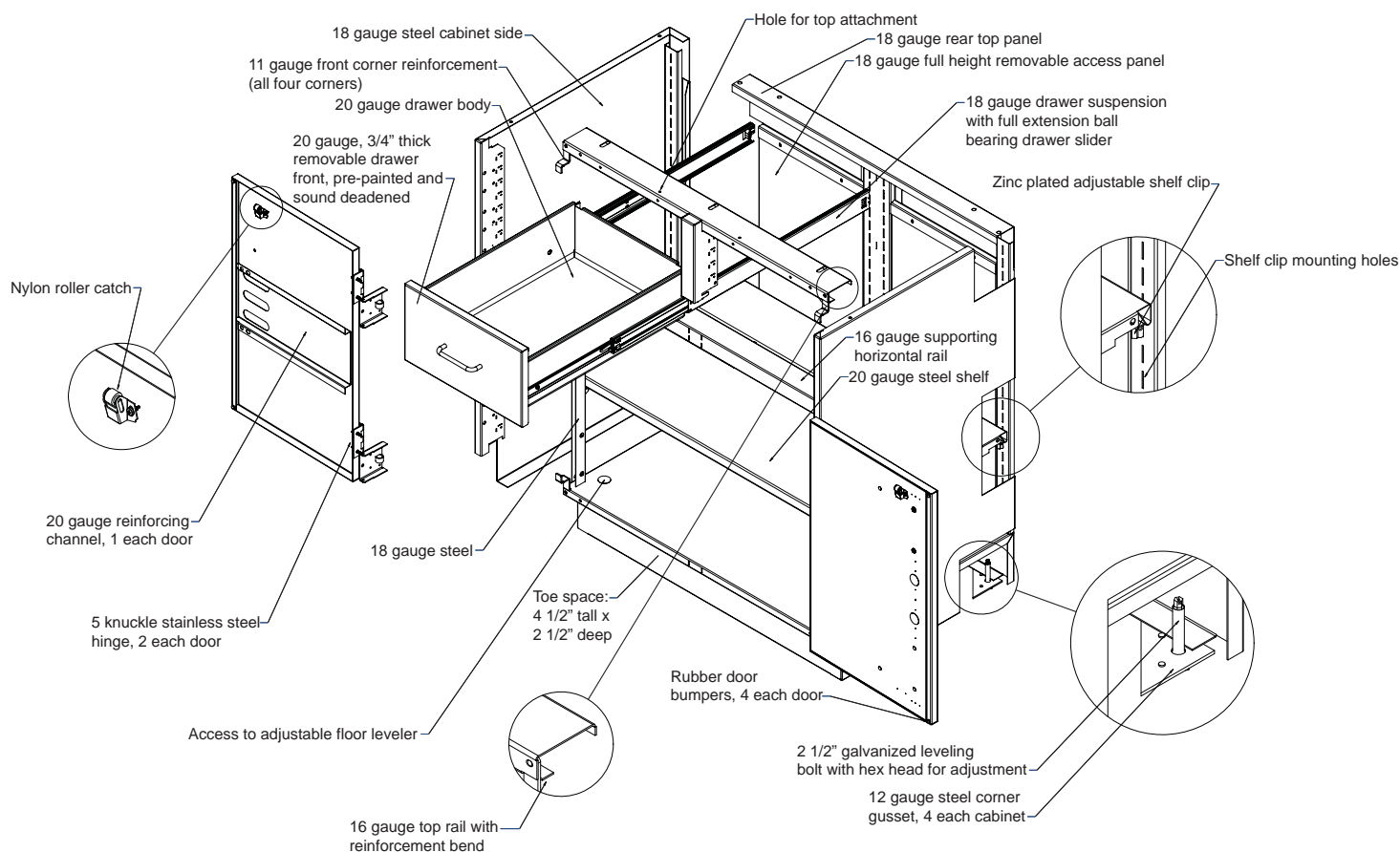
CornerStone Door and Drawer Size Code

Mod Letter	Height	
Drawers		
A	1 1/4"	3.2 cm
B	2 9/16"	6.5 cm
C	3 13/16"	9.7 cm
D	5 1/8"	13 cm
E	6 3/8"	16.2 cm
F	7 5/8"	19.4 cm
G	8 13/16"	22.4 cm
H	10 3/16"	25.9 cm
I	11 1/2"	29.1 cm
J	12 3/4"	32.4 cm
Doors		
K	19 3/16"	48.7 cm
L	23"	58.4 cm
M	28 1/16"	71.3 cm
N	30 5/8"	77.8 cm

Design Appearance:

- Our quick delivery cabinetry is offered in a flush inset style. All cabinet component parts of the sectional units are manufactured ensuring uniformity, interchangeability and accurate alignment.

Color:

- Our quick delivery cabinetry is offered in a neutral color of "Pearl White"

Field Convertible:

- Field convertible design allows for conversion of cabinet door and drawer front styles, drawer body suspension and cabinet horizontal and vertical rails, with the use of simple hand tools.

LEED Compliance:

- Environmental compliant paints, glues and adhesives are specifically formulated to safeguard indoor air quality

Industry Compliance:

- SEFA 8 Metal, NFPA 30, UL listed and FM approved

Drawer Slide:

- 100 lbs. full extension, Standard

Standard Features:

- Stainless Steel Wire Pull
- Stainless Steel Five Knuckle Hinge
- Nylon Roller Door Catch

Casework

CornerStone Inset Steel Casework



Standard Product Features Include:

- Modular design allows for simple field conversion from inset to overlay, door and drawer re-configurations and hardware component changes
- Durable construction provides SEFA 8 Metal compliant load-bearing capacity for years of dependable usage
- Flush overlay and inset styling offered in steel
- “Pearl White” color is a urethane powder coating that provides reliable chemical and abrasion resistance
- Drawer suspension 100 lb. full extension
- SEFA 8 tested and approved by an independent third party

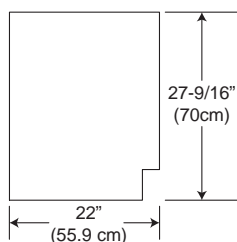

CornerStone Sitting Height Base Cabinet

- Order work surfaces separately
- Provided without locks
- 27.6" (70 cm) Tall
- Standard Color: Pearl White
- All door and combination cabinets have a removable back
- All drawer cabinets have a cutout for service access

Door Cabinets

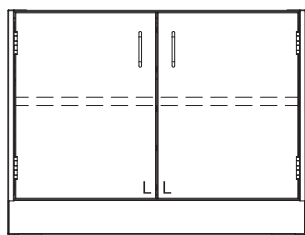

163-36TS	36" W (91.4 cm)
----------	-----------------

Drawer Cabinets

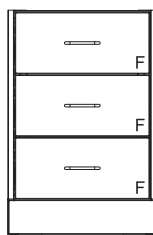

174-18TS	18" W (45.7 cm)
----------	-----------------

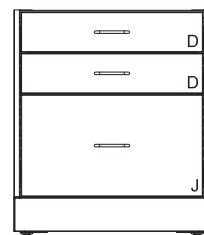

070-24TS	24" W (61 cm)
----------	---------------

Door and Drawer Cabinets

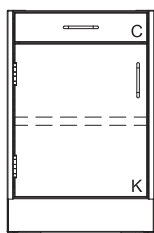

Left Hinged

169-18TS	18" W (45.7 cm)
----------	-----------------

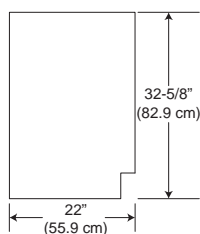

CornerStone ADA Height Base Cabinet

- Order work surfaces separately
- Provided without locks
- 32.6" (82.8 cm) Tall
- Standard Color: Pearl White
- All door and combination cabinets have a removable back
- All drawer cabinets have a cutout for service access

Drawer Cabinets

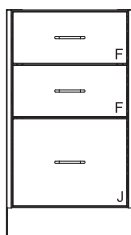

925-18TS	18" W (45.7 cm)
----------	-----------------

Sink Cabinet

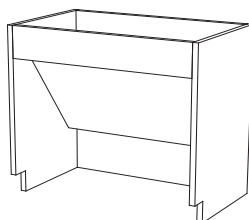

981ACC-36TS	36" W (91.4 cm)
-------------	-----------------

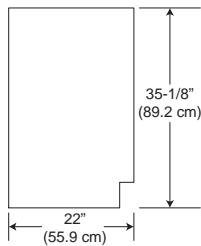

CornerStone Standing Height Base Cabinet

- Order work surfaces separately
- Provided without locks
- 36.1" (91.8 cm) Tall
- Standard Color: Pearl White
- All door and combination cabinets have a removable back
- All drawer cabinets have a cutout for service access

Door Cabinets

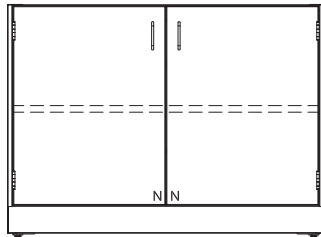

103-30TS	30" W (76.2 cm)
103-36TS	36" W (91.4 cm)
103-48TS	48" W (121.9 cm)

Drawer Cabinets

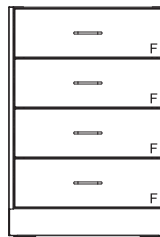

122-18TS	18" W (45.7 cm)
122-24TS	24" W (61 cm)

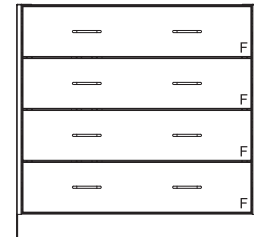

121-36TS	36" W (91.4 cm)
----------	-----------------

Drawer Cabinets

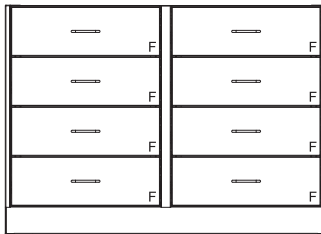

124-48TS	48" W (121.9 cm)
----------	------------------

Door/Drawer Cabinets

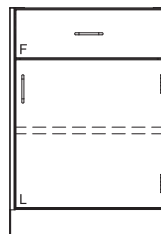

Right Hinged	
118-18TS	18" W (45.7 cm)
118-24TS	24" W (61 cm)

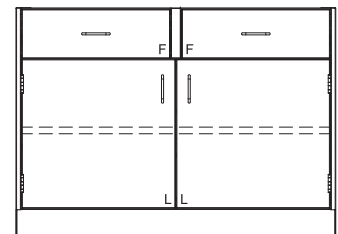

106-36TS	36" W (791.4 cm)
106-42TS	42" W (106.7 cm)
106-48TS	48" W (121.9 cm)

Corner/Sink Cabinet

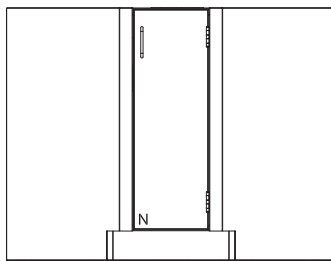

Right Hinged	
TS190-32SE	32-7/8" W (83.5 cm)

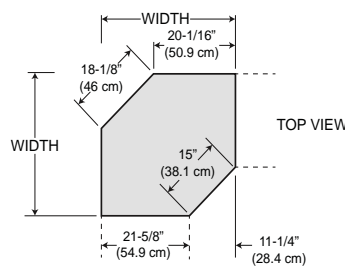

Corner Cabinet Plan View

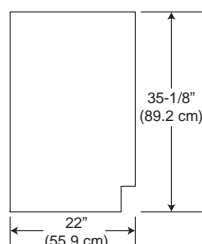

CornerStone Standing Height Base Cabinet

- Order work surfaces separately
- Provided without locks
- 36.1" (91.8 cm) Tall
- Standard Color: Pearl White
- All door and combination cabinets have a removable back
- All drawer cabinets have a cutout for service access

Sink Cabinets

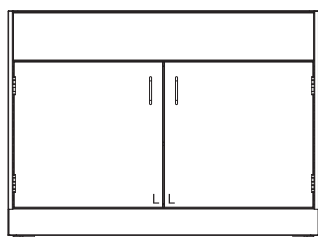

181-36TS	36" W (91.4 cm)
181-48TS	48" W (121.9 cm)

End Island Sink Cabinets

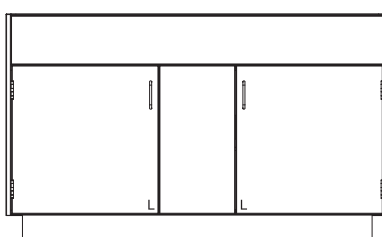

186-52TS	52" W (132.1 cm)
186-58TS	58" W (147.3 cm)

Sink Supports

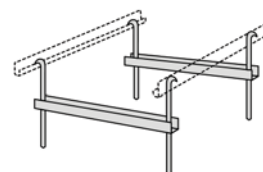

535-36TS	36" W (91.4 cm)
535-48TS	48" W (121.9 cm)
535-52TS	52" W (132.1 cm)
535-58TS	58" W (147.3 cm)

Acid Storage Cabinets

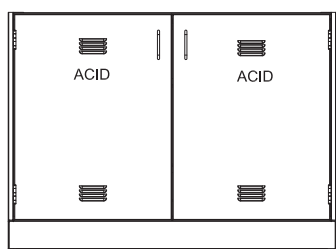

- Full-Height doors are lined with 1/8" thick polyethylene
- Chemical resistant 3/16" thick molded Polyethylene lining with coved corners and 2" lip at front of cabinet opening
- Includes vent kit
- One half-depth shelf

TS185-24GG (Left Hinged)	24" W (61 cm)
TS188-36GG	36" W (91.4 cm)
TS188-48GG	48" W (121.9 cm)

Solvent Storage Cabinets

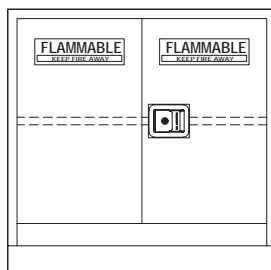

- Construction meets requirements listed by UFC, OSHA, and NFPA No. 30-1993
- Two 2" pipe threaded vent outlets on back
- Rear and top access panels
- Lock is included
- Self-closing

TS189-24SLAS (Right Hinged)	24" W (61 cm)
TS189-36SLASY	36" W (91.4 cm)
TS189-48SLASY	48" W (121.9 cm)

Standard Hood Cabinets

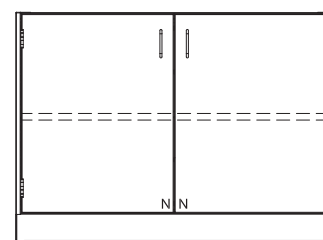

103-30TS	30" W (76.2 cm)
103-36TS	36" W (91.4 cm)
103-48TS	48" W (121.9 cm)

Apron Frame with Drawer

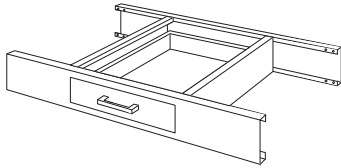

- Apron frame is 4 1/2" (11.4cm) tall
- Use to span knee space area between two cabinets
- Attachment hardware included
- Can be cut to fit in the field

TS3022-1	30" W (76.2 cm)	21-5/8" D (54.9 cm)
----------	--------------------	------------------------

Apron Rail

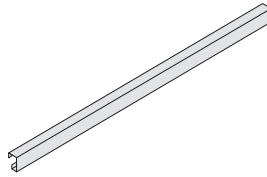

TSR-3002	30" W (76.2 cm)
TSR-3602	36" W (91.4 cm)
TSR-4802	48" W (121.9 cm)
TSR-7202	72" W (182.9 cm)

Apron Rail

- Height of apron rails is 2" (5.1cm)
- Use to span knee space area between two cabinets
- Attachment hardware included
- Can be cut to fit in the field

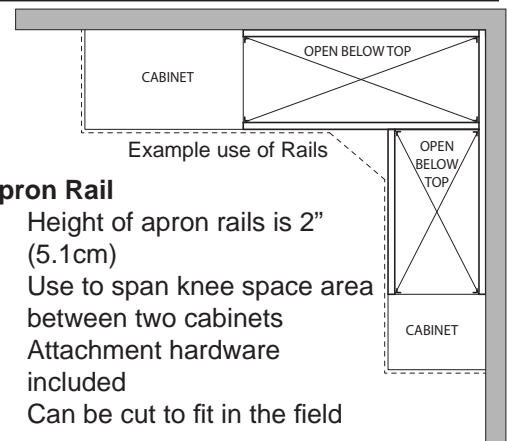

Panel End Supports

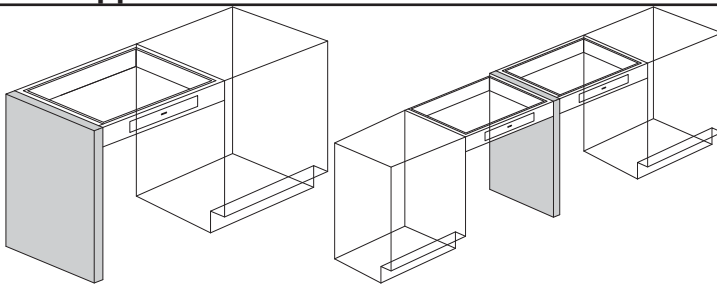

- Use in place of a cabinet at one end of a cabinet run to support drawer frames or apron rails
- Can be used to support the intersection of two aprons or rails
- Each panel has 2 leveling feet and is 2" (5.1 cm) wide

Sitting Height		
TSTPO-2822	22" D (55.9 cm)	27.565" H (70 cm)
ADA Height		
TSTPO-3222	22" D (55.9 cm)	32.605" (82.8 cm)
Standing Height		
TSTPO-3522	22" D (55.9 cm)	36.125" (91.8 cm)

Heavy Duty Wall Mount Bracket Countertop Support

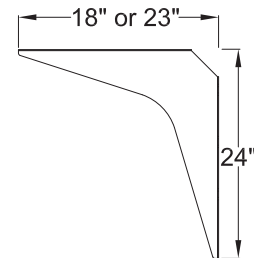

- In-wall blocking required
- 2" (5.1 cm) wide return flange with mounting holes at top and rear

TSWS18	18" D (45.7 cm)
TSWS23	23" D (58.4 cm)

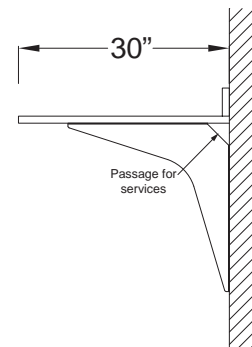

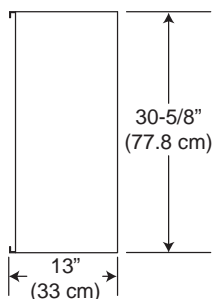

CornerStone Wall Cabinets

- Provided without locks
- 30.6" (77.8 cm) Tall x 13" (33 cm) Deep
- Standard Color: Pearl White
- Two adjustable shelves
- Flush Bottom

Solid Door Wall Cabinets

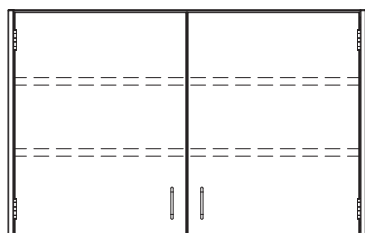

203-36TS	36" W (91.4 cm)
203-48TS	48" W (121.9 cm)

Framed Glass Wall Cabinets

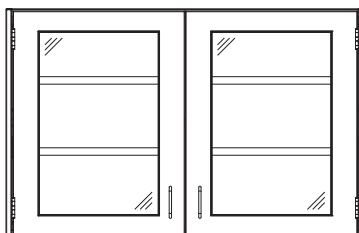

206-36TS	36" W (91.4 cm)
206-48TS	48" W (121.9 cm)

Rear Wall Cabinet Filler

TS1372N0124P

Solid Door Tall Cabinets

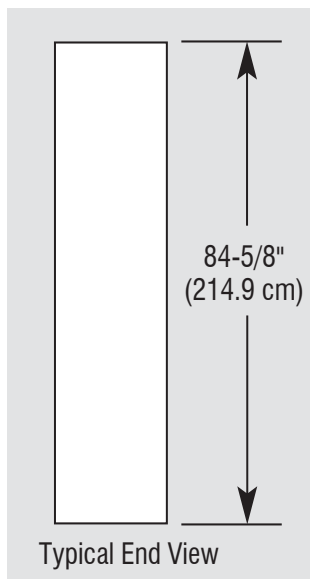

CornerStone Steel Tall Cabinet

- Standard without locks
- Five shelves are included and are adjustable in half-inch increments
- Must be anchored to wall
- When installing tall cases under soffits, 85-1/2" (217.2 cm) minimum height is required from finished floor to finished soffit
- 84-5/16" Tall x 22" Deep
- Color: Pearl White

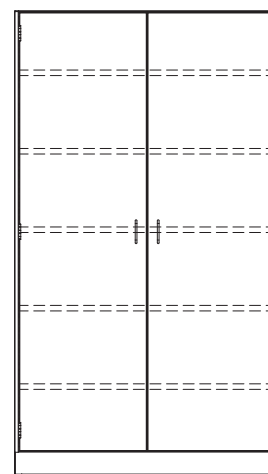

303-36TS	36" W (91.4 cm)
303-48TS	48" W (121.9 cm)

Knee Space Panels for use with Drawer Aprons

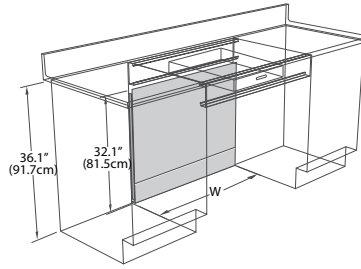
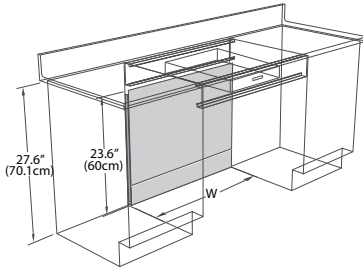

Sitting Height

TSKSL-3004	30" W (76.2 cm)
------------	-----------------

Standing Height

TSKSH-3004	30" W (76.2 cm)
------------	-----------------

Knee Space Panels for use with 2" High Apron Rails

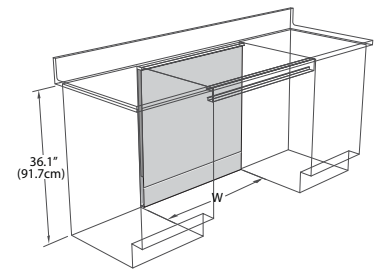
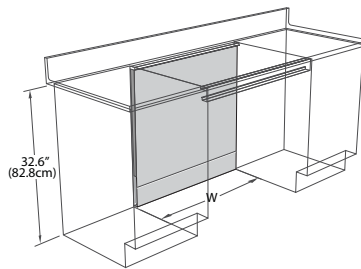
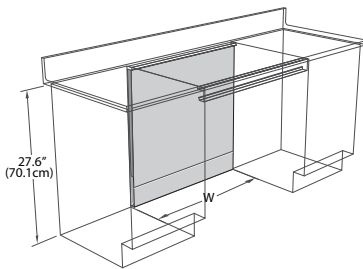

Sitting Height

TKSL-ADJ*	ADJUSTABLE 12"-48" W (30.5 cm - 121.9 cm)
-----------	---

ADA Height

TKSA-ADJ*	ADJUSTABLE 12"-48" W (30.5 cm - 121.9 cm)
-----------	---

Standing Height

TKSH-30	30" W (76.2 cm)
TKSH-36	36" W (91.4 cm)
TKSH-ADJ*	ADJUSTABLE 12"-48" W (30.5 cm - 121.9 cm)
TKSH-72ADJ*	ADJUSTABLE 12"-72" W (30.5 cm - 182.9 cm)

* Cut to fit and includes slip fit trim angle

* Cut to fit and includes slip fit trim angle

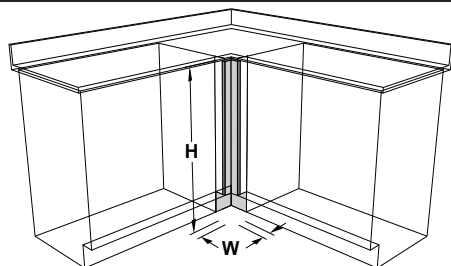
Corner Fillers

Standing Height - 36.1"	
TSFCH-01	1" W (2.5 cm)
TSFCH-ADJ*	ADJUSTABLE 2"-12" (5.1 cm - 30.5 cm)

* Cut to fit and includes slip fit trim angle

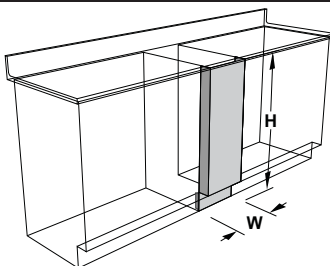
Front Fillers Panels

- For use between adjacent base cabinets or between a cabinet and the wall

Sitting Height - 27.6"	
TSFFL-ADJ*	2"-18" W (5.1 cm - 45.7 cm)
Standing Height - 36.1"	
TSFFH-01	1" W (2.5 cm)
TSFFH-04	4" W (10.2 cm)
TSFFH-08	8" W (20.3 cm)
TSFFH-ADJ*	2"-18" W (5.1 cm - 45.7 cm)

* Cut to fit and includes slip fit trim angle

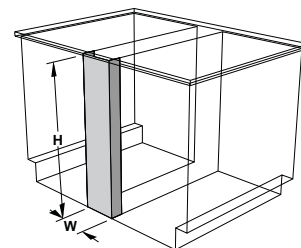
Rear and Center Fillers Panels

- For use between back-to-back base cabinets or to close space at the rear of the cabinet

Sitting Height - 27.6"	
TSFRL-07	7 3/8" W (18.7 cm)
ADA Height - 32.6"	
TSFRA-07	7 3/8" W (18.7 cm)
Standing Height - 36.1"	
TSFRH-01	1 3/8" W (3.5 cm)
TSFRH-07	7 3/8" W (18.7 cm)
TSFRH-08	8 3/8" W (21.3 cm)
TSFRH-14	14 3/8" W (36.5 cm)
TSFRH-ADJ*	2" - 19 3/8" W (5.08 cm - 49.2 cm)

* Cut to fit and includes slip fit trim angle

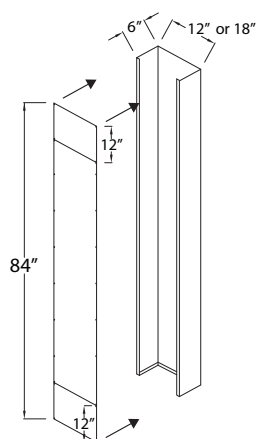
Pipe Enclosures - Steel

- Used to provide a cover for pipes running from the ceiling to the work surface
- Can be used for island or perimeter locations
- Can support pegboards or water purification systems
- Cover is pre-punched for attachment and is furnished in three sections for ease of access after installation

TS509-1284	83-1/2" T x 12" W x 6" D (212.1cm x 30.5cm x 15.2cm)
TS509-1884	83-1/2" T x 18" W x 6" D (212.1cm x 45.7cm x 15.2cm)

Tier One Premier Wood Cabinets



**The perfect blend of old world craftsmanship and
modern design**

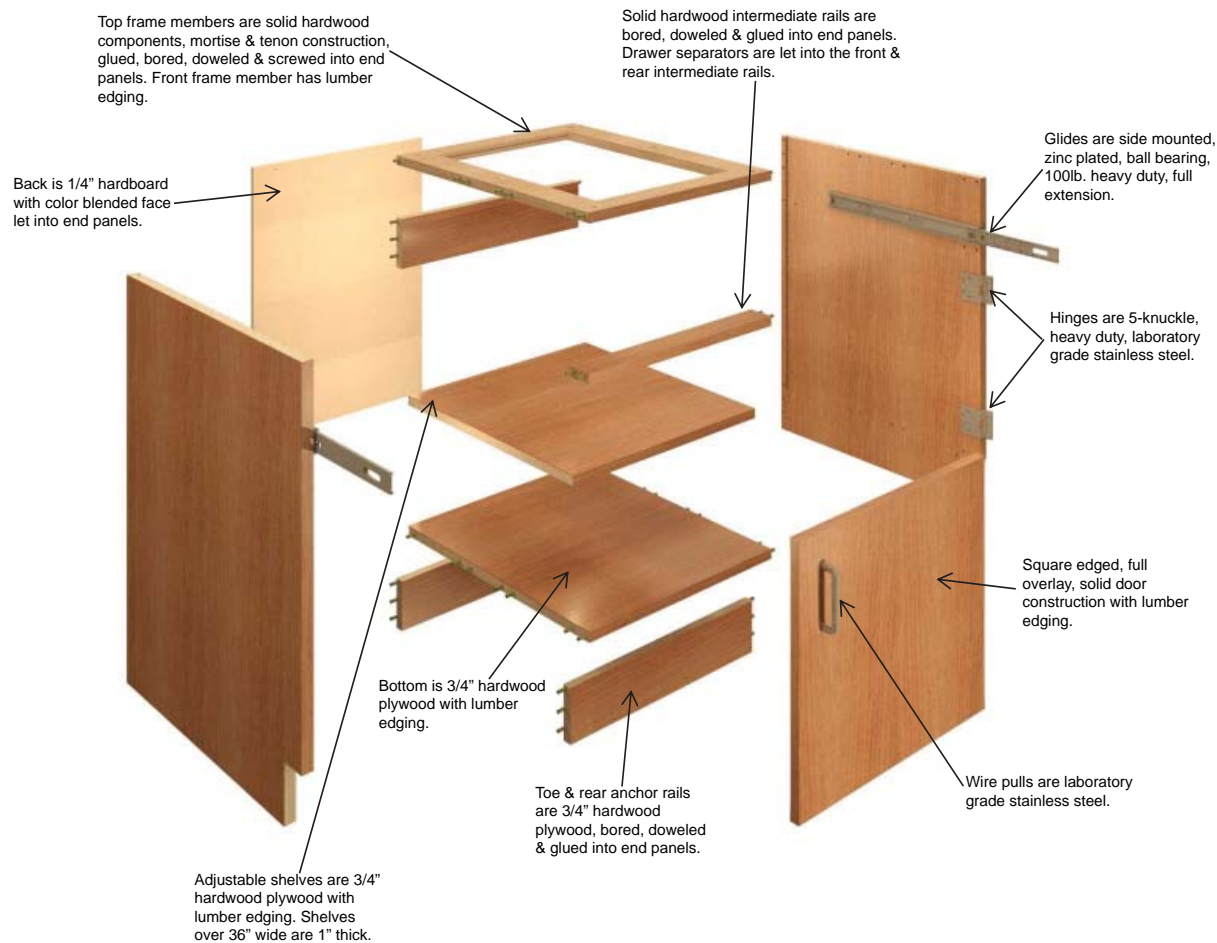

ICI Scientific's University and Research wood laboratory cabinets are made from hand selected premium rift cut oak grade A veneers, featuring a solid mortise/tenon top frame, doweled, glued and screwed European construction. Robotically applied environmental finishes are chemically resistant resulting in beautiful board room quality furniture. Cabinets are stained inside and out allowing for relocation during laboratory refits. Drawer glides are full extension heavy duty designed for commercial/industrial applications. Cabinet pulls and hinges are laboratory grade stainless steel. ICI's wood laboratory furniture has been independently tested and is SEFA 8 compliant. All of our products are supported by a 3 year warranty. We bring quality, warmth and durability to your laboratory. All **INSTOCK** wood laboratory cabinets come in ICI's chemically resistant "Amber" finish.

Please contact your Account Manager for current lead times, as they vary per season.

Our complete program includes: Maples, Oaks, Cherry, Bamboo, European Steamed Beech, American White Ash, or other Exotic Species. Also, select from Seven Premier Finishes or a customized one to suit your project.



ICI Scientific reserves the right to change or modify our construction detail without notice.



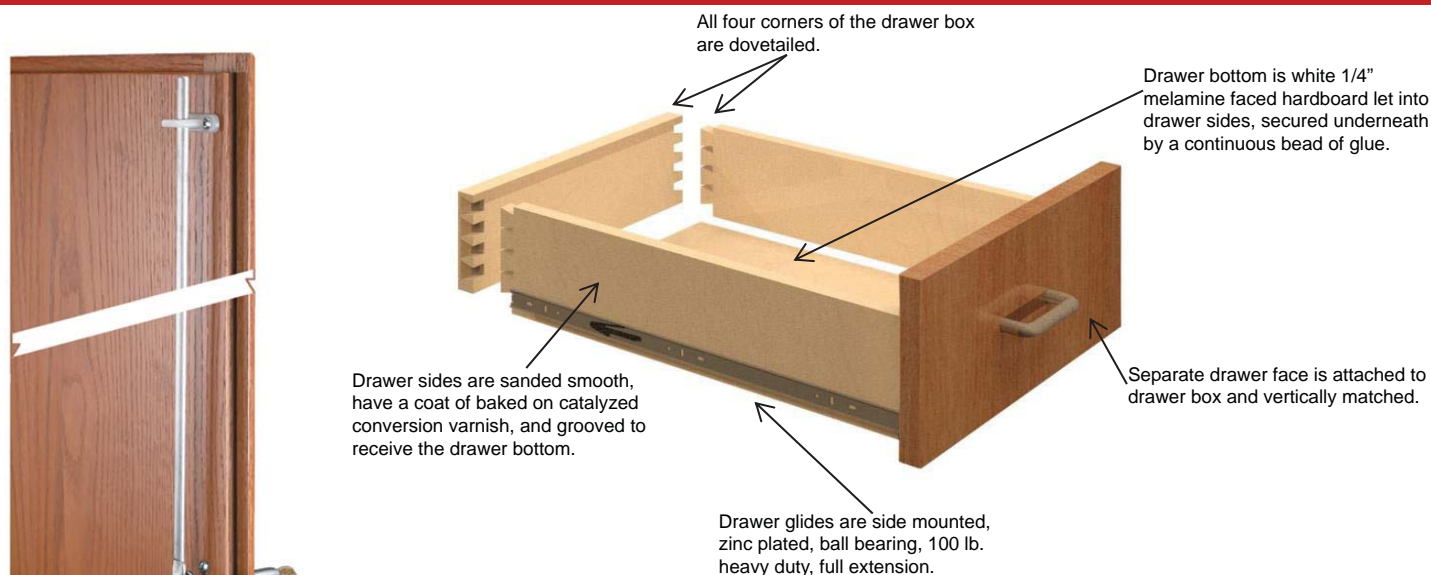

Door and Drawer Details:

ICI Scientific door and drawer construction is a well established quality standard for the laboratory marketplace. Hand selected premium rift cut oak grade A veneers, full flush overlay, vertical grain matching with tight reveals. All **INSTOCK** wood laboratory cabinets come in ICI's chemically resistant "Amber" finish.

Three-Point Latching System:

ICI Scientific's tall case doors operate with a three-point latching system. The quality of a three-point latching system enables the door to be pulled securely shut. Tapered aluminum rods - which engage plastic strike plates at the top and bottom of the case - move in nylon glides attached to the back of the door. The middle of the door is secured by a latch plate, which engages the side of the case, or latches behind the left door on cases with double doors.

Hinges, Pulls & Locks:

ICI Scientific's hinges and pulls are made from stainless steel. The hinges are heavy duty laboratory grade and hospital tipped for consistency, strength and durability. They are certified to the rigors of SEFA-8 performance standards.

ICI Scientific locks are keyed alike per unit, master keyed and two keys are provided with each lock. All lock faces are chrome plated. A removable core system allows lock cores to be held out until the project is completed; removing the control security risk of lost or stolen keys during installation. Once installed, with the use of a control key, the lock core of the assembly can be removed and a new lock core inserted, changing an entire locking system in minutes.



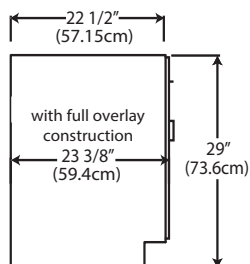

ICI Wood Sitting Height Base Cabinet

- All cabinets with drawers have a fixed back
- All cabinets with a door have a removable back
- Order work surfaces separately
- 29" (73.7 cm) Tall
- Finish: Amber

Door Cabinets

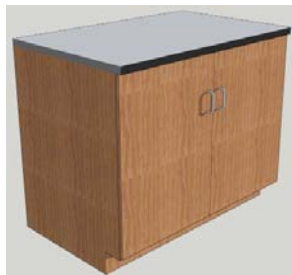

TS2644RB	36" W (91.4 cm)
----------	-----------------

Door/Drawer Cabinets



TS2444RB	18" W (45.7 cm)
----------	-----------------

Drawer Cabinets



TS2550	24" W (61 cm)
--------	---------------

Drawer Cabinets



TS2454	18" W (45.7 cm)
--------	-----------------

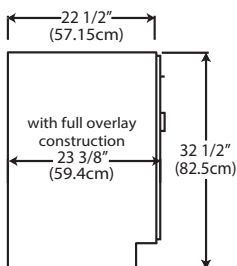

ICI Wood ADA Height Base Cabinet

- All cabinets with drawers have a fixed back
- Order work surfaces separately
- 32 1/2" (82.6 cm) Tall
- Finish: Amber

Drawer Cabinets



TS3644	18" W (45.7 cm)
--------	-----------------

Sink Cabinets

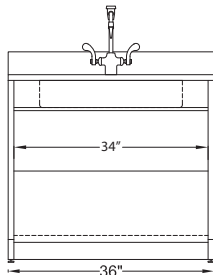

- Maximum sink depth 6"
- Order sink and fixture separately

TS8760EP	36" W (91.4 cm)
----------	-----------------

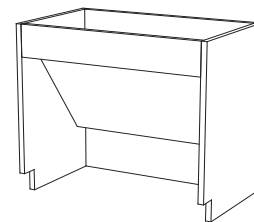

3-D drawing of sink cabinet

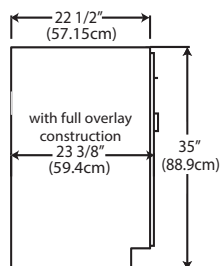

ICI Wood Standing Height Base Cabinet

- All cabinets with drawers have a fixed back
- All cabinets with a door have a removable back
- Order work surfaces separately
- 35" (88.9 cm) Tall
- Finish: Amber

Door Cabinets



TS1504RB	30" W (76.2 cm)
TS1506RB	36" W (91.4 cm)
TS1510RB	48" W (121.9cm)

Door/Drawer Cabinets



Right Hinged	
TS1234RB	18" W (45.7 cm)
TS1238RB	24" W (61 cm)



TS1574RB	30" W (76.2 cm)
TS1576RB	36" W (91.4 cm)
TS1578RB	48" W (121.9cm)

Drawer Cabinets



TS1264	18" W (45.7 cm)
TS1268	24" W (61cm)



TS1960	36" W (91.4 cm)
--------	-----------------



TS2036	48" W (121.9 cm)
--------	------------------

Sink Cabinets



TS2358	36" W (91.4 cm)
TS2362	48" W (121.9 cm)

End Island Sink Cabinets



TS2411	58 1/4" W (147.9 cm)
--------	----------------------

Corner/Sink Cabinet



TS2414	34 1/4" W (86.9 cm)
--------	---------------------

Acid Storage Cabinet



- Liner and Vent Kit included

TS6780A36SA	36" W (91.4 cm)
-------------	-----------------

Solvent Storage Cabinet



- UL listed
- Meets all standards set by OSHA and NFPA

TS6780-V1	36" W (91.4 cm)
-----------	-----------------

Standard Hood Cabinets



TS1504RB	30" W (76.2 cm)
TS1506RB	36" W (91.4 cm)
TS1510RB	48" W (121.9cm)

Wood Table Assemblies

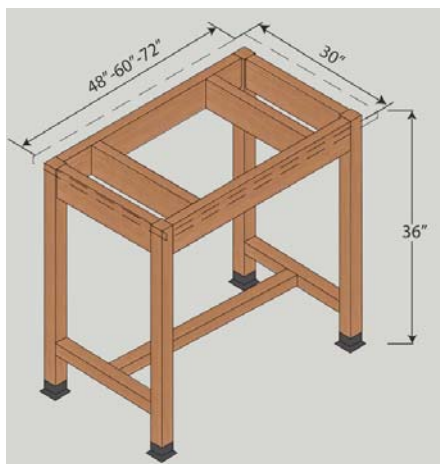

- Table assemblies include a 4 7/8" (12.4 cm) high apron, end legs and spreaders as shown
- End legs are furnished complete with leveling feet and black floor boots. Tables are shipped in pieces to be assembled in the field
- Available work surfaces are black 1" (2.5 cm) thick epoxy or phenolic resin. They overlap the table frame by 1" (2.5 cm)

Table Frame	Table Size (Including optional work surface)	Black Epoxy Work Surface	Black Phenolic Work Surface
TS6503-36-ADJ	48" W x 30" D x 36" H (121.9 cm x 76.2 cm x 91.4 cm)	TSE-4830	TSP-4830
TS6512-36-ADJ	60" W x 30" D x 36" H (152.4 cm x 76.2 cm x 91.4 cm)	TSE-6030	TSP-6030
TS6528-36-ADJ	72" W x 30" D x 36" H (182.8 cm x 76.2 cm x 91.4 cm)	TSE-7230	TSP-7230

Wood Mobile Cabinets



- Cabinets are 22" deep and 33" tall (with casters) with a finished back
- Mobile cabinets include locking swivel casters and a solid wood top
- Anti-tip design

TS3624-FBCAT	24" W (61 cm)
--------------	---------------



- Cabinets are 22" deep and 33" tall (with casters) with a finished back
- Mobile cabinets include locking swivel casters and a solid wood top
- Anti-tip design
- Includes drawer interlock system

TS3618-FBCAT	24" W (61 cm)
--------------	---------------

Apron Frame with Drawer



TS7012-30	30" W (76.2 cm)	22" D (55.8 cm)
-----------	--------------------	--------------------

Apron Rail



TS6974PWV-30	30" W (76.2 cm)
TS6974PWV-36	36" W (91.4 cm)
TS6974PWV-48	48" W (121.9 cm)
TS6974PWV-72	72" W (182.9 cm)

Apron Rail

- Height of apron rails is 2 1/2" (6.4cm)
- Sturdy painted steel "C" channel sub frame design, to be ordered separately to create apron assembly
- 3/4" (1.9 cm) wood apron face rail is attached to sub frame
- Apron rail assemblies are required for front and back support of open spans of work surface
- Face rails can be cut to fit in the field
- Face rail is vertical grain and edge banded on bottom side

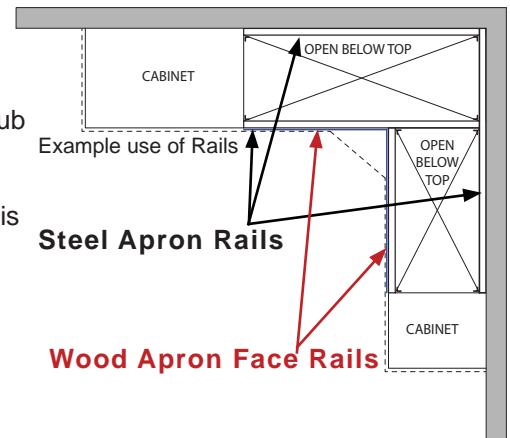

Panel End Supports

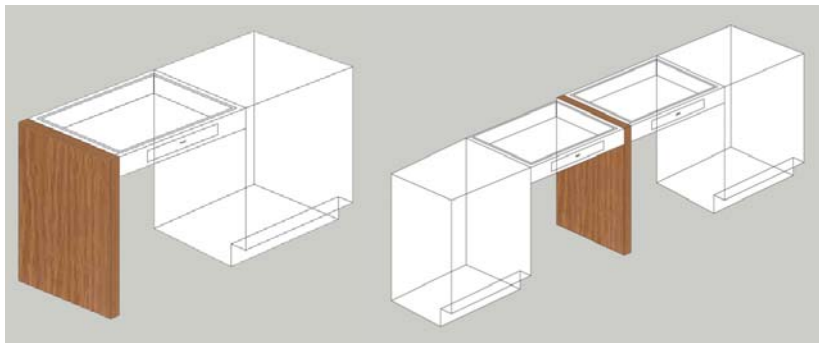

- Use in place of a cabinet at one end of a cabinet run to support drawer frames or apron rails
- Can be used to support the intersection of two aprons or rails
- Each panel has 2 leveling feet and is 1" wide

Sitting Height		
TS9200L-36	22 1/2" D (57.2 cm)	29" H (73.7 cm)
ADA Height		
TS9200L-32	22 1/2" D (57.2cm)	32 1/2" H (82.6 cm)
Standing Height		
TS9200L-35	22 1/2" D (57.2 cm)	35" H (88.9 cm)

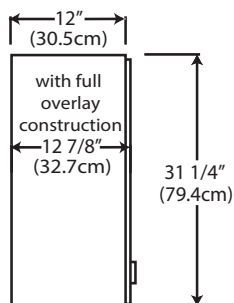

ICI Wood Wall Cabinets

- Two shelves are included and are adjustable in 1 1/4" increments
- Cases have recessed backs with wall hanger cleats
- Finish: Amber

Solid Wall Cabinet



TS4718	36" W (91.4 cm)
TS4722	48" W (121.9 cm)

Framed Glass Wall Cabinet



TS4790	36" W (91.4 cm)
TS4794	48" W (121.9 cm)

Tall Cabinet Section

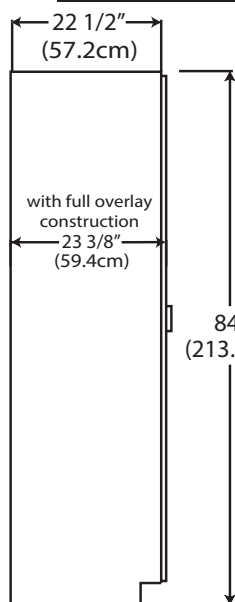

ICI Wood Tall Cabinets

- Five shelves are included and are adjustable in 1 1/4" increments and one fixed center shelf
- Must be anchored to wall
- When installing tall cabinets under soffits, 85 1/2" minimum height is required from finished floor to finished soffit

Solid Swinging Door Tall Cabinet



TS5688	36" W (91.4 cm)
TS5692	48" W (121.9 cm)

Framed Glass Swinging Door Tall Cabinet



TS5724	36" W (91.4 cm)
TS5728	48" W (121.9 cm)

Knee Space Panels for use with Drawer Aprons

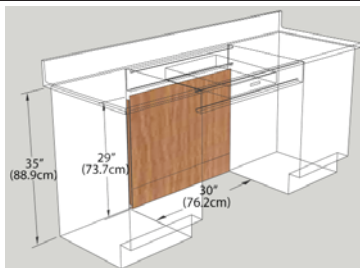
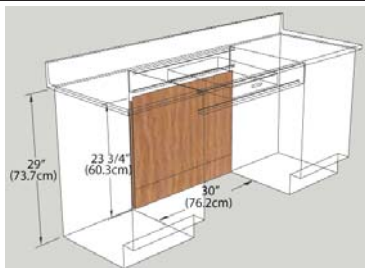

Sitting Height

TS9024-30	30" W (76.2 cm)
-----------	-----------------

Standing Height

TS9029-30	30" W (76.2 cm)
-----------	-----------------

Knee Space Panels for use with 2" High Apron Rails

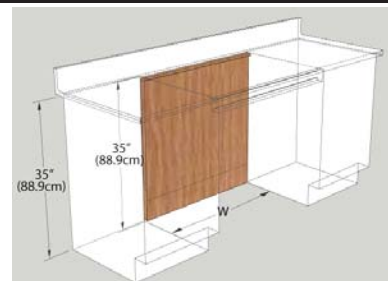
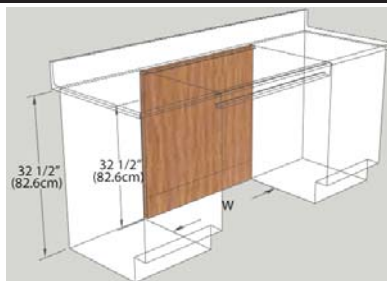
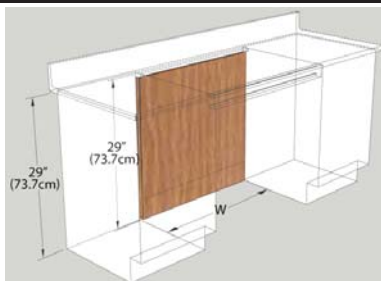

Sitting Height

TS9027-48*	48" W (121.9 cm)
------------	------------------

ADA Height

TS9024-48*	48" W (121.9 cm)
------------	------------------

Standing Height

TS9030-48	48" W (121.9 cm)
TS9030-72	72" W (182.8 cm)

* Cut to fit and includes slip fit trim angle

Corner Fillers

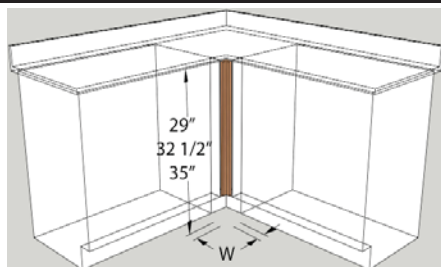

Sitting Height

TS9129T-3	3" W (7.6 cm)
TS9129T-12	12" W (30.5 cm)

ADA Height

TS91325T-3	3" W (7.6 cm)
TS91325T-12	12" W (30.5 cm)

Standing Height

TS9135T-3	3" W (7.6 cm)
TS9135T-12	12" W (30.5 cm)

Front Fillers Panels

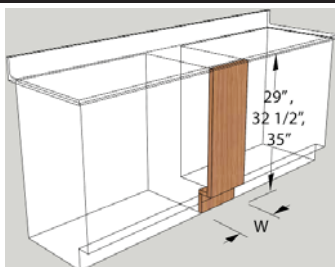

- For use between adjacent base cabinets or between a cabinet and the wall

Sitting Height

TS9029T-18	18" W (45.7 cm)
------------	-----------------

ADA Height

TS90325T-18	18" W (45.7 cm)
-------------	-----------------

Standing Height

TS9035T-18	18" W (45.7 cm)
------------	-----------------

Rear and Center Fillers Panels

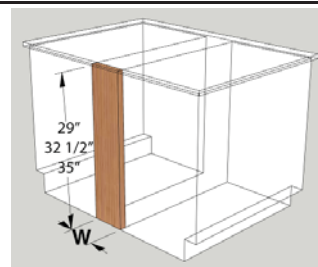

- For use between back-to-back base cabinets or to close space at the rear of the cabinet

Sitting Height

TS9029-18	18" W (45.7 cm)
-----------	-----------------

ADA Height

TS90325-18	18" W (45.7 cm)
------------	-----------------

Standing Height

TS9035-18	18" W (45.7 cm)
-----------	-----------------

Hoods and Enclosures

Isolator³ Bench Top Fume Hoods



For over 70 years, ICI has been developing innovative and purpose driven products for the research and healthcare industries. Our highly experienced team of engineers and designers are proud to introduce our latest effort: Isolator³.

Isolator³ is the latest generation of energy saving high performance fume hoods, built upon extensive R&D. Utilizing computational fluid dynamics, ICI was able to develop a safe and superior operating environment without the need for additional components to add or inject air into the hood chamber. By controlling baffle pressurization, Isolator³ achieves the proper capture and containment at a 60 FPM face velocity. Additionally, we do it with a sash opening of 24" (61 cm). JMP's chemical exhaust fume hoods meet or exceed SEFA 1 standards.

- 24" (61 cm) deep clear interior
- Low static rectangular exhaust duct
- Integral stainless steel 12" (30.5 cm) round duct transition
- Slotted rear baffle for even plenum balance
- Safe operation at 60 fpm
- Chemically resistant white Poly glass liner
- UL1805 listed, ANSI/ASHRAE 110-1995, UL1275
- Three year hood superstructure warranty
- Chain & Sprocket sash mechanism with the exclusive ICI lifetime warranty
- Exclusive standard 43 1/2" (110.5 cm) tall full view sash area
- Tempered glass sash with full-length formed steel handle for a neat, clean appearance and streamline air passage
- Color: Pearl White



4', 5' and 6' Bench Fume Hoods
ship in 6 days

Isolator ³ Part Number with frame less vertical sash	Overall Hood Width	Sash Opening Area (Sq Ft)	Total CFM & Static Pressure			
			24" (61 cm) Vertical Opening @ 60 FPM Face Velocity	S.P. Loss	18" (45.7 cm) Vertical Opening @ 80 FPM Face Velocity	S.P. Loss
TS-350-48G5	4'-0" (121.9 cm)	6.3	380 CFM	0.21"	380 CFM	0.12"
TS-350-60G5	5'-0" (152.4 cm)	8.3	500 CFM	0.20"	500 CFM	0.11"
TS-350-72G5	6'-0" (182.9 cm)	10.3	620 CFM	0.31"	620 CFM	0.17"
TS-350-96G5*	8'-0" (243.8cm)	14.3	860 CFM	0.27"	860 CFM	0.15"

* This hood available for shipment in 7-8 weeks

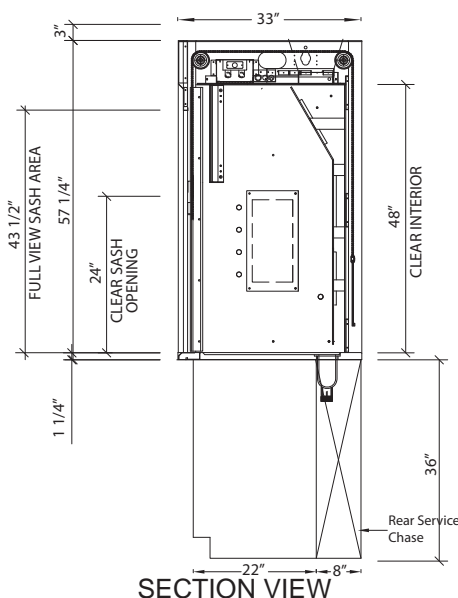

INSTOCK® Hood Features

- Two pre-wired 120V 20amp GFCI duplex receptacles
- One pre-wired 20amp light switch
- Pre-wired vapor tight T8 fluorescent light fixture
- Each hood side post and interior is punched and plugged to receive 5 service fixtures
- Upper left side post is punched for optional fan switch
- One pre-wired outlet on roof of hood for an optional alarm
- Upper right side post is punched for optional alarm

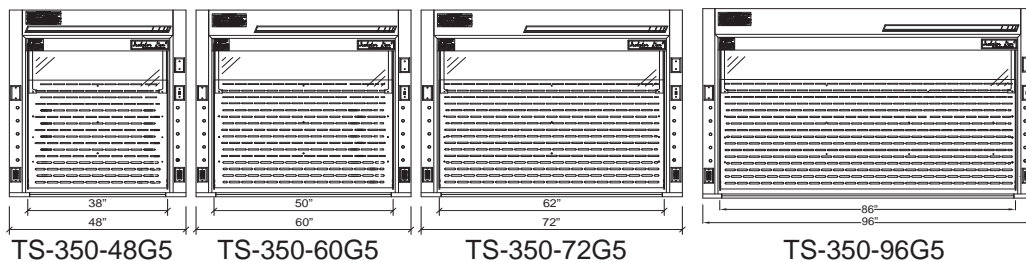



Full width sash weight at rear of hood



Heavy duty chain and sprocket sash mechanism with an exclusive lifetime warranty

Pre wired outlet for available alarm



Integral stainless steel 12" (30.5 cm) round duct transition (8' fume hood includes 2 ea.)



Exclusive 43 1/2" (110.5 cm) tall "full view" sash area



High performance baffle design, which can be used in both low and standard volume applications



Hood post and interior is punched to receive 5 service fixtures and a fan switch



Hood is fully pre wired with two GFCI duplex outlets, light fixture, light switch and outlet on the roof

Full range of standard and specialty storage base cabinets



Acid cabinets are furnished with a chemical resistant lining that has a 1 1/2" (3.8 cm) spill lip. Exhaust vent kit is included.

The Isolator Gen-5 bypass walk-in fume hood with the frameless vertical sash is similar to the bench style unit in design and function. The top view-pass is clear tempered glass. These units are normally used with tall equipment setups where maximum clarity of vision is a priority. When floor mounted, the walk-in's top fascia aligns with a standard bench hood thus providing a clean look to any design utilizing both types of hood. The Isolator Gen-5 design and construction enhances its value by providing:

- Unparalleled user safety
- Full hood access for easy set ups
- Years of maintenance free service
- Unmatched ease of use with a chain driven sash operation
- Unique design qualities for unlimited customization possibilities
- Field conversion between Constant Air Volume (CAV) and Variable Air Volume (VAV) with a restricted by-pass

Features:

- Unsurpassed containment (designed and tested to exceed ASHRAE 110-1995)
- Hood is UL1805/CUL certified listed
- Unique chain driven sash mechanism that comes with a lifetime warranty
- Painted steel pan substructure
- 17.25" H. clear observation glass panel, bypass system
- Non-metallic interior
- Vertical sashes provide the greatest hood interior access
- Full view frameless sash with 66-1/2" upper and lower sash openings
- Quality engineering ensures years of reliable service
- White Polyglass liner
- Prewired T8 light and switch
- 2 prewired GFCI duplex outlets
- Prewired duplex outlet on hood roof for optional alarm
- Can be pre-plumbed with remote rod driven fixtures.
- Walk-in hoods are available for shipment in 7-8 weeks
- These hoods are furnished in Pearl White
- Other sash configurations and hood styles available upon request
- Epoxy resin work decks available upon request

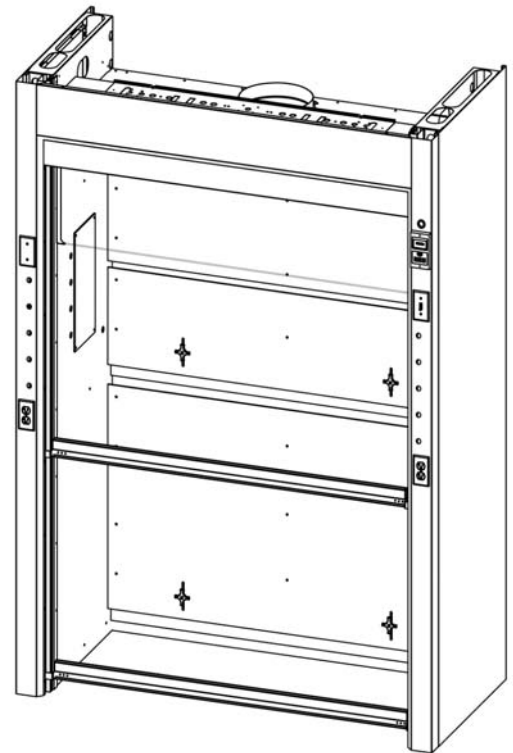

Isolator GEN5 Part Number with frameless vertical sash	Overall Hood Length (Clear working length is 10" less)	Work Surface Depth (Clear working depth)	Total CFM & Static Pressure			
			31 1/2" Verti- cal Open Upper Sash @ 100 FPM	S.P. Loss	18" Vertical Open Upper Sash @ 100 FPM	S.P. Loss
TS-200-48G5	4'-0" (121.9 cm)	24" (61 cm)	858 CFM	.39"	501 CFM	.13"
TS-200-48G5D30	4'-0" (121.9 cm)	30" (76.2 cm)	858 CFM	.39"	501 CFM	.13"
TS-200-60G5	5'-0" (152.4 cm)	24" (61 cm)	1128 CFM	.37"	660 CFM	.13"
TS-200-60G5D30	5'-0" (152.4 cm)	30" (76.2 cm)	1128 CFM	.37"	660 CFM	.13"
TS-200-72G5	6'-0" (182.9 cm)	24" (61 cm)	1399 CFM	.57"	818 CFM	.19"
TS-200-72G5D30	6'-0" (182.9 cm)	30" (76.2 cm)	1399 CFM	.57"	818 CFM	.19"
TS-200-96G5	8'-0" (243.8cm)	24" (61 cm)	1941 CFM	.50"	1135 CFM	.17"
TS-200-96G5D30	8'-0" (243.8cm)	30" (76.2 cm)	1941 CFM	.50"	1135 CFM	.17"

Walk-In Fume Hood Dimensions

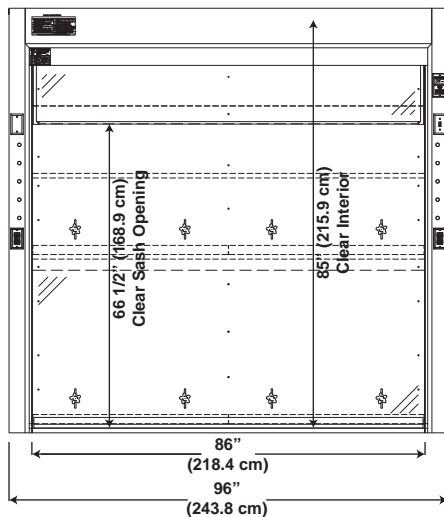

TS-200-96G5 - with dimensions

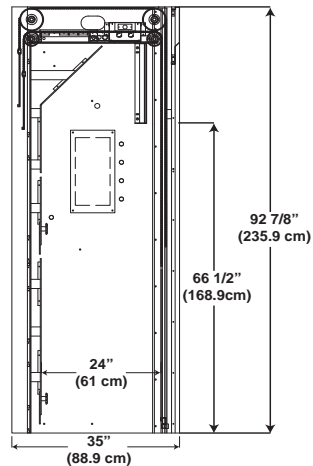

Standard Depth
Section

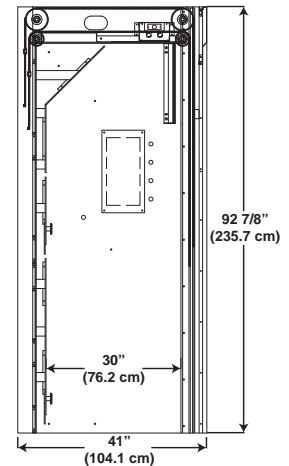

30" Depth
Section

Further details on our Walk-In hoods and what is standardly provided:

- All hoods are available in both a standard 24" depth as well as a 30" deep format (D30)
- 2 pre-wired GFCI Duplex outlets
- Pre-wired T8 light and switch
- Each hood side post and interior is punched and plugged to receive 5 service fixtures
- Upper left side post is punched for optional fan switch
- One pre-wired outlet is provided on roof of hood for an optional alarm
- Upper right side post is punched for optional alarm
- Adjustable baffles



Hoods and Enclosures

Fume Hood Fittings and Accessories



Fittings for Fume Hood

These WaterSaver brand remote control fittings consist of a brass angle valve with a replaceable seat, an epoxy coated brass nylon color-coded panel flange with angle serrated hose connector, a remote control rod assembly with a plastic flange and a tank nipple, locknut and washer. Fittings may be used on either side of hood. Shipped loose and installed in field.



Fitting Type	Part Number
Air (Orange)	TS-3185-A
Gas (Dark Blue)	TS-3185-G
Nitrogen (Brown)	TS-3185-N
Vacuum (Yellow)	TS-3185-V

External Vacuum Breaker

Shipped loose and installed in field.



Fitting Type	Part Number
External Vacuum Breaker	TS-112

Cold Water Fitting for Fume Hood

These WaterSaver brand remote control fittings consist of a brass angle valve with a replaceable seat, and epoxy coated brass nylon color-coded panel flange with a gooseneck with a vacuum breaker, a remote control rod assembly with a plastic flange and a tank nipple, locknut and washer. Shipped loose and installed in field.



Fitting Type	Part Number
Cold Water with Vacuum Breaker	TS-3185-WV

Cold Water Fitting for Fume Hood

These WaterSaver brand remote control fittings consist of a brass angle valve with a replaceable seat, and epoxy coated brass nylon color-coded panel flange with a gooseneck without a vacuum breaker, a remote control rod assembly with a plastic flange and a tank nipple, locknut and washer. Shipped loose and installed in field.



Fitting Type	Part Number
Cold Water without Vacuum Breaker	TS-3185-W

Fume Hood Alarm

Each INSTOCK fume hood is fully pre-punched, for the fast and easy installation of this alarm.

The TEL AFA-1000 provides a digital readout of the fume hood face velocity and sounds an alarm when the airflow falls below safe levels. Consisting of a thermostat sensor (mounted through the side wall of the fume hood) and a monitor (mounted on the fascia), the unit gives both a visual and audible alarm. A glowing green light signals when conditions are safe. The monitor also contains a test/reset button allowing the user to verify alarm readiness. The TEL AFA-1000 operates on a 9V DC circuit and comes complete with an adapter that is plugged into a pre wired 120 VAC receptacle on the roof of the hood.



Product	Part Number
Fume Hood Alarm	TS AFA-1000

Fan Blower Switch

Manual fan motor starter switch, toggle style, single pole, with red pilot light, stainless steel cover plate, 1 thermal unit, for 1 HP maximum motor size



Product	Part Number
For use with a 1 HP fan	E121PTS
For use with a 2 HP fan	E122PTS

Bench Fume Hood Work Tops

These modified black epoxy resin work tops are dished to retain spills. They are available with or without a drop in cup sink hole. **Cup sinks are found on page 63.**



Bench Fume Hood Width	Part Number w/o Cup Sink	Part Number w/ Cup Sink Cutout (Left)	Part Number w/ Cup Sink Cutout (Right)	Part Number w/ Cup Sink Cutouts (Both Sides)
4'-0" (121.9 cm)	WTS-48B	WTS-48BCSL	WTS-48BCSR	WTS-48BCSB
5'-0" (152.4 cm)	WTS-60B	WTS-60BCSL	WTS-60BCSR	WTS-60BCSB
6'-0" (182.9 cm)	WTS-72B	WTS-72BCSL	WTS-72BCSR	WTS-72BCSB
8'-0" (243.8 cm)	WTS-96B	WTS-96BCSL	WTS-96BCSR	WTS-96BCSB

Adjustable Height Fume Hood Ceiling Enclosure

These three sided ceiling enclosures are designed to fill the space between the top of the hood and the ceiling up to 24" (61 cm) in height to provide a clean finished appearance. The enclosure is cut to fit in the field and includes a slip to fit ceiling finish trim angle.

Fume Hood Width	Part Number
4'-0" (121.9 cm)	TS048P-NA-24GH
5'-0" (152.4 cm)	TS060P-NA-24GH
6'-0" (182.9 cm)	TS072P-NA-24GH
8'-0" (243.8 cm)	TS096P-NA-24GH



Gravity Sash Stop

As a safety or energy conservation measure, a sash stop may be added to any of our hoods. It may be mounted at any distance above the lower deflector vane to keep the sash from rising past that point. When needed, the stop may be pivoted out of the way.

Product	Part Number
Gravity Sash Stop	SP01TS



Variable Air Volume Fume Hood Controller



Safer and More Efficient Hood Operation

TEL's Fume Hood Controller is a pioneering VAV airflow controller, monitor and alarm system developed to ensure the safety of users and provide energy efficient fume hood operation. The Fume Hood Controller can directly provide controlled outputs for VFD fan speed control, or be supplied with a relay interface unit and actuator for damper/valve control. Boasting a simple, yet intuitive, user interface that has been optimized for user experience, the Fume Hood Controller is easy to navigate and features a simple two-step calibration process with on-screen prompts to guide end users. The Fume Hood Controller has built-in comms and can be used with either Modbus or BACnet protocol. Featuring an innovative temperature compensated hot wire sensor, the Fume Hood Controller has no inherent drift, meaning that the sensor will provide stable readings over many years of operation ensuring reliability and safety.

Features include:

- LCD display for continuous velocity reading in m/sec or fpm
- Programmable push buttons: i.e. FAN on/off, purge, etc.
- BACnet and Modbus on board
- Velocity bar graph or fault time line over the last 60 minutes.
- Audible alarm with Red, Amber & Green LEDs
- 3 Relay inputs and 3 Relay outputs
- Push button for night setback
- Direct Volumetric measurement
- Energy cost reduction of up to 85%
- Password protected
- Zone presence sensor supports
- Sash position sensor supports

Part Number	TTSVAV-TEL-INV-MK3	TTSVAV-TEL-MK3 (w/ actuator & interface)
Alarm Range	0.15-5.00 m/s (30-999 fpm) remote SM6 or ILS Airflow Sensor	
Control Range	Face Velocity Control 30-300 fpm (0.15-1.5 m/s)	
Control Resolution	2 fpm (0.01 m/s)	
Control Response	< 2 Seconds	
Control Output 1	0-10/2-10VDC Control Output	
Control Output 2	0-10/2-10VDC Control Output for bleed or Supply Air Damper/Inverter or 0-10VDC Volumetric Output	
Field Set Up	2 Point velocity calibration with on screen instructions	
Accuracy	Face Velocity ± 2 fpm	
Airflow Sensor	Remote SM6/ILS	
Pushbuttons	3 Configurable pushbuttons	
Relay Output	3A, 120VAC/30VDC	
Relay Input	3 Configurable Digital/Analog inputs	
Com Port	RS485 com port Modbus RTU and BACnet	
Display	Digital velocity display fpm / m/s 3 x LED's (Safe/Caution/Alarm)	
Alarm Indication	Red LED with Audible alarm	
Mounting	Semi Flush	
Monitor Operating Temperature Range	55-86°F (13-30°C)	
Airflow Sensor Operating Temperature	59-86°F (15-30°C)	
Storage Temperature	-40 - 105°F (-40 - 65°C)	
Agency Listings	CE RoHS	
Hazardous Area (Remote Airflow Sensor)	Gas group IIC Temp Class T6 with Atex certified I.S Zener Barriers	
Connections	Flying leads with plug in connections (2m-5m) Max 24VDC	

Auto Sash Operator and Controller



**Safer and More
Efficient Hood
Operation**

TEL's innovative fume hood auto sash controller can be retrofitted to any fume hood and control system to maximize energy savings and provide increased safety for the operator. The auto sash controller is designed to close the sash of vertically rising sash fume hoods automatically when the operator is not present in front of the fume hood. A passive infrared sensor (PIR) constantly monitors the work area in front of the fume hood. If a person is not detected and the sash opening is clear, the sash will automatically close after a predetermined time. When the operator is present, the sash can be operated manually via the optional Tiptronic touch pad. Auto-open option is also available. A dual auto sash controller is also available to operate fume hoods with two sashes including walk-in type, back-to-back type and side-by-side type sashes.

Features include:

- Auto Close
- Auto Open (user selectable - enabled/disabled/auto open if auto closed only)
- Tiptronic Open/Close - touch sensitive sash movement (menu selectable)
- Manual sash operation
- Keypad Pushbutton Open/Close
- Mute Audible Alarm Button
- Inputs to BMS from Sash closer:
 - External Alarm Sounder Output
- Sash position (0-10v/4-20mA)
- Sash Open or Sash Closed
- Sash sensor broken
- Sash Obstruction
- Outputs from BMS to Sash Closer:
 - Emergency, Open/Close sash
 - Fire Alarm, Close
 - Close Sash
 - Open Sash

	Tiptronic Auto Sash Controller
Power Supply	100/240VAC 50/60Hz 3A
Keypad	2 Line, 16 Characters Backlit LCD with membrane pushbuttons Single gang socket (3x2)
Motor Drive Assembly	PWM output DC Motor & Clutch
Personnel Sensor	PIR with background learn function
Sash Position Sensor	Stainless Steel Cable, Potentiometer
Control Box	NEMA 4, ABS/PVC Flying leads with plug in connectors
Sash Obstruction Sensor	Light Curtain or Under Sash Sensor
Programming Access	Password protected
BMS Inputs	(4) programmable dry contact inputs
BMS Outputs	(4) programmable dry contact outputs (1) 0-10, 1-10, 0-5, 1-5 VDC or (1) 0-20, 4-20mA for sash position
Alarms	Audible DB and Visual
Agency Listings	CE RoHS
Comms	Additional plugin module for BACnet/Modbus

Part Number	Description
TTSASC-P	Auto Sash Closer, Light Curtain Sensor, Pulley Motor Drive
TTSASC-CS	Auto Sash Closer, Light Curtain Sensor, Chain & Sprocket Motor Drive
TTSASC-USS-P	Auto Sash Closer, Under Sash Sensor, Pulley Motor Drive
TTSASC-USS-CS	Auto Sash Closer, Under Sash Sensor, Chain & Sprocket Motor Drive
TTSDASC-USS-P	Dual Auto Sash Closer, Under Sash Sensor, Pulley Motor Drive
TTSDASC-USS-CS	Dual Auto Sash Closer, Under Sash Sensor, Chain & Sprocket Motor Drive

Hoods and Enclosures

Exhaust System Recommendations

Exhaust System Recommendations

- Exhaust fans should be mounted on the roof so that the duct leading to the fan is under negative pressure. Please note that if exhaust fans are mounted inside the building, all duct connected to the fan outlet will be under positive pressure, and if leaks should develop in the portion of the duct inside the building, hazardous fumes could be forced out of the duct and into that area of the building.
- For the lowest possible noise level in the exhaust system, we suggest the following actions:
 - Use vibration isolators for mounting the exhaust fan.
 - Select an exhaust fan that will deliver the desired CFM and static pressure with the lowest practical impeller wheel RPM.
 - Use a flexible connection at the fan inlet to isolate transmission of noise from the duct to the hood.
 - Design the exhaust duct system with the fewest possible elbows or other fittings. Use radius type elbows and avoid square elbows.

Typical Fume Hood Ventilation System

The diagram below details of the components found in a typical fume hood ventilation system. All of these components as well as others are available within this catalog.

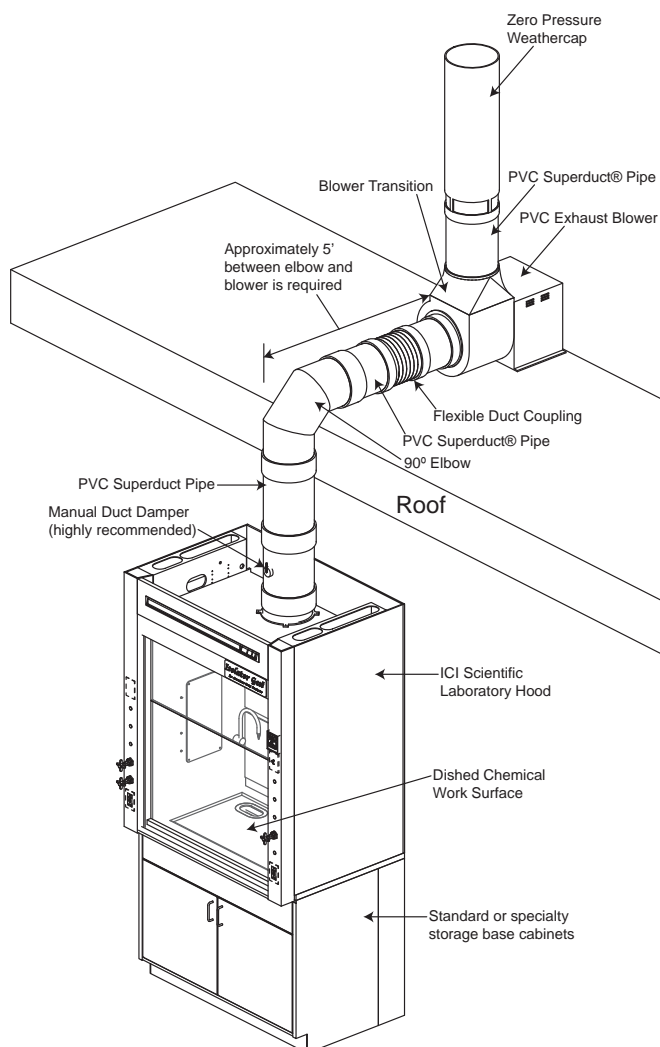

Hood Exhaust Blower Sizing

When sizing an exhaust blower, it is necessary to include the equivalent air movement resistance factors for all ductwork and accessories in the ventilation system. The equivalent resistance in feet of straight duct is provided for each ductwork fitting on the pages that follow.

Steps to sizing the right hood fan

1. Review the CFM and static pressure loss for the use of the selected fume hood. The catalog details provided for each hood indicate these values.
2. Add up all the equivalent resistance amounts in feet of straight duct of the ductwork, components, fittings and fume hood in your system.
3. Use the fan selection chart to cross reference the total CFM required as well as the system static pressure loss to select the right exhaust blower for your application.
4. Contact us for assistance if needed: FSLab@labbuildersinc.com

Duct Diameter	6"	8"	10"	12"	16"
Airflow/CFM	Static pressure loss in inches of water for each 10' length of ductwork				
250	0.039	0.011	0.003	0.001	-
500	0.147	0.037	0.013	0.005	0.001
750	0.321	0.079	0.026	0.011	0.003
1000	0.557	0.140	0.043	0.018	0.005
1250	0.855	0.210	0.066	0.027	0.008
1500	-	0.300	0.095	0.039	0.012
1750	-	0.380	0.130	0.053	0.016
2000	-	0.485	0.155	0.067	0.020
2500	-	-	0.245	0.109	0.031
3000	-	-	-	0.145	0.042
4000	-	-	-	0.240	0.074
5000	-	-	-	-	0.120

PVC Superduct Pipe



PVC Superduct® Pipe is constructed of Type I Grade I PVC, Cell Class 12454B, as described in ASTM D-1784 with flame spread <10. A Female Duct Coupling is required to join two sections. Connections can be made using solvent cement. PVC is rigid and can be cut without the use of special tools. Pipe comes in 10' lengths.

Part Number	Nominal Diameter	Actual OD	Actual ID	Weight
PVC10-06TS	6"	6.625"	6.25"	3 lbs
PVC10-08TS	8"	8.625"	8.25"	4 lbs
PVC10-10TS	10"	10.75"	10.38"	4 lbs
PVC10-12TS	12"	12.75"	12.38"	5 lbs
PVC10-16TS	16"	16"	15.63"	6 lbs

Elbows



PVC Superduct® Pipe elbows, both 135° and 90°, are compatible with PVC Superduct Pipe. Designed and engineered for quick installation and minimum pressure losses, they feature belled end connections to receive PVC ductwork directly.

135°				
Part Number	Nominal Diameter	Centerline Height	Weight	Resistance in feet of straight duct
PVC135-06TS	6"	5.375"	8 lbs	6
PVC135-08TS	8"	5.812"	10 lbs	7.5
PVC135-10TS	10"	6.25"	12 lbs	10
PVC135-12TS	12"	6.625"	14 lbs	12.5
PVC135-16TS	16"	7.562"	17 lbs	18
90°				
Part Number	Nominal Diameter	Centerline Height	Weight	Resistance in feet of straight duct
PVC90-06TS	6"	10.5"	8 lbs	12
PVC90-08TS	8"	11.437"	10 lbs	15
PVC90-10TS	10"	14.7"	12 lbs	20
PVC90-12TS	12"	15.625"	14 lbs	25
PVC90-16TS	16"	18"	17 lbs	36

Duct Couplings, Female/Female



PVC coupling makes connections between two sections of PVC Superduct® Pipe quick and easy.

Part Number	Nominal Diameter	Actual OD	Actual ID	Weight
PVCFF-06TS	6"	6.625"	6.25"	3 lbs
PVCFF-08TS	8"	8.625"	8.25"	4 lbs
PVCFF-10TS	10"	10.75"	10.38"	4 lbs
PVCFF-12TS	12"	12.75"	12.38"	5 lbs
PVCFF-16TS	16"	16"	15.63"	6 lbs

Thermoplastic Duct Reducers



PVC coupling type reducers are designed for connecting thermoplastic duct of different diameters. Compare your blower inlet size with your duct size to see if one is necessary.

Part Number	Nominal Diameter	Weight	Equivalent Resistance in feet of straight duct
PVCDR-0608TS	6" x 8"	2 lbs	0
PVCDR-0810TS	8" x 10"	5 lbs	0
PVCDR-1012TS	10" x 12"	6 lbs	0
PVCDR-1216TS	12" x 16"	8 lbs	0

Zero Pressure Weathercaps



The Zero Pressure Weathercap is made of strong corrosion-resistant PVC. The cap adds little static pressure to the exhaust system and allows for vertical discharge of the effluent air for dispersion away from the building. Includes transition to fan.

Part Number	Nominal Diameter	Height	Weight	Equivalent Resistance in feet of straight duct
PVCWC-06TS	6"	24"	20 lbs	5
PVCWC-08TS	8"	32"	25 lbs	5
PVCWC-10TS	10"	40"	30 lbs	5
PVCWC-12TS	12"	48"	35 lbs	5
PVCWC-16TS	16"	64"	40 lbs	5

Manual Duct Dampers



PVC Superduct® Pipe fittings allow you to balance airflow. It is highly recommended for use in hood ventilation systems.

Part Number	Nominal Diameter	Height	Weight
PVCDD-06TS	6"	9.5"	10 lbs
PVCDD-08TS	8"	10.5"	12 lbs
PVCDD-10TS	10"	11.75"	15 lbs
PVCDD-12TS	12"	12.75"	20 lbs
PVCDD-16TS	16"	15.75"	25 lbs

T Connection

PVC fittings shaped in T and Y configurations. Compatible with Thermoplastic duct. End connections receive PVC pipe directly. Contact us for help in sizing blower accessories



Part Number	Nominal Diameter	Height	Weight	Equivalent Resistance in feet of straight duct
PVCTTS	10" x 10" x 10"	11.125"	20 lbs	0

Flexible Duct Connections



This connection reduces vibration between the blower and PVC Superduct® Pipe. Supplied with two clamps for easy installation. 25' length.

Part Number	Nominal Diameter	Weight
PVCFDC-08TS	9" for use with 8" fittings	14 lbs
PVCFDC-10TS	11" for use with 10" fittings	20 lbs
PVCFDC-12TS	13" for use with 12" fittings	25 lbs

Y Connection



Part Number	Nominal Diameter	Height	Weight	Equivalent Resistance in feet of straight duct
PVCY12TS	12" x 12" x 12"	10.25"	29 lbs	0
PVCY16TS	16" x 16" x 16"	12"	30 lbs	0

Fume Hood Fan

The GES Series Compact Sirocco Fan is made of an injected FRPP mold with standardized central discharge. The impeller and casing are both made of an injected FRPP mold for enhanced recycleability. All units standardly feature:

- Belt driven forward inclined impellers
- Carbon steel drive shafts
- FRP belt guards
- Free gland seals

Each fan is furnished with:

- 10" inlet duct transition
- Galvanized steel mounting frame with vibration isolation pads



Standardized Central Discharge

Our GES blower fans feature an upward discharge direction. This significantly reduces the complexity of choosing a rotational direction and simplifies duct piping.

Enhance Maintainability

Most other designs require the removal of the suction and discharge ducts before being able to remove the impeller. However, in the GES Series, by incorporating an easy-to-remove suction cone in the design, only the suction duct needs removal before the impeller can be taken off. Inner-casing inspection is also made easy.

Excellent Corrosion Resistance

The GES casing and impeller have excellent chemical resistance thanks to our standardized FRPP injection mold construction that boasts high dimensional accuracy. Also, its effective ribbed and hemmed design gives it superior strength while keeping it lightweight. We used materials that offer great corrosion resistance and maintainability.

Fan Selection Chart

	Total Static Pressure - Inches of Water Column (fans are capable of exceeding listed pressure levels)										
	0.125	0.25	0.375	0.5	0.625	0.75	1	1.25	1.5	1.75	2
CFM	RPM	RPM	RPM	RPM	RPM	RPM	RPM	RPM	RPM	RPM	RPM
380	1430	1430	1430	1430	1430	1430	1670	2060	2060	2300	2300
500	1430	1430	1430	1430	1430	1430	1670	2060	2060	2300	2300
620	1430	1430	1430	1430	1430	1670	1670	2060	2060	2300	2300
800	1430	1430	1430	1430	1670	1670	2060	2060	2060	2300	2300
1000	1430	1670	1670	1670	2060	2060	2060	2060	2300	2300	2300
1500	2300	2300	2300	2300	2300	2300	2530	2530	2930	2930	2930
2000	1560	1560	1560	1560	1560	1560	1560	1750	1750	1750	1960

Fan Selected	Series	HP	Fan Part #
Light Green	GES 10	1/3	GES10ATS
Light Blue	GES 10	1/3	GES10ATS
Light Orange	GES 10	1/2	GES10BTS
Light Yellow	GES 10	1/2	GES10BTS
Dark Green	GES 10	1/2	GES10BTS
Dark Yellow	GES 10	1	GES10CTS
Dark Blue	GES 10	1	GES10CTS
Light Grey	GES 10	2	GES10DTS
Dark Orange	GES 10	2	GES10DTS
Dark Grey	GES 10	2	GES10DTS
Teal	GES 15	2	GES15DTS



The ORIGINAL model is a robust and reliable all-around arm for general applications where there is little risk of electrical discharges or attack by aggressive chemicals. The arm is shown fitted with a multi-purpose transparent hood.



The ESD/EX model is designed for use in electronic environments where there is a risk of electrostatic discharges. Following risk assessment, the ESD/EX can also be used for certain applications in explosive environments. The arm is made of conductive materials, eliminating the risk of static electricity and sparks. The hood is made of anodized metal.



The CHEM model has profiles made of double anodized aluminum. The arm is ideal for fume extraction in aggressive environments where corrosion resistance must be assured. The arm shown here is fitted with a painted, corrosion-resistant metal hood.

Pressure drop

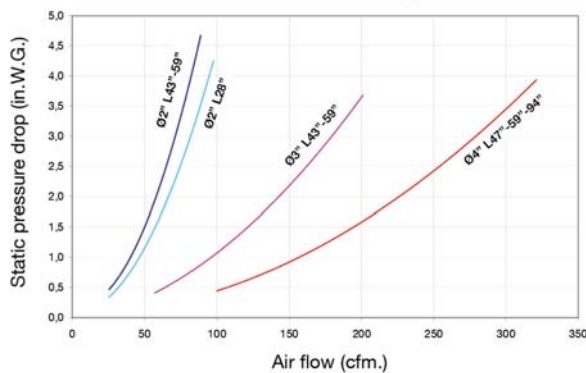

Position of arm when measured

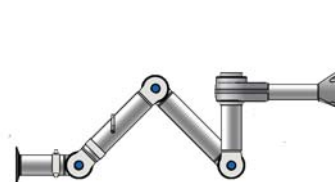

Wall Mounting
Connection Up

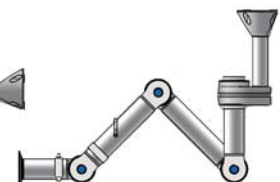

Ceiling Mounting
Connection Up



Extraction Arms

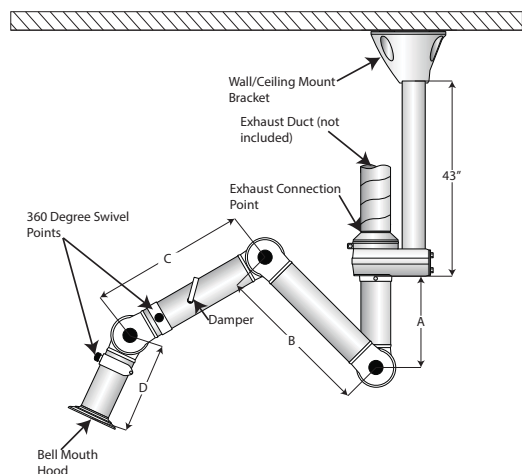

- Arms are 2", 3", or 4" in diameter, consisting of thin walled anodized aluminum sections specific to the model
- Noted models are corrosion resistant
- Exhaust connection point swivels with 360 degree rotation
- The adjustment knobs on the articulated friction joints are supported by ball-bearings
- Mini bell mouthed hood is supplied with the arm
- All arms are provided with dampers
- The snorkel is furnished complete with wall/ceiling mount bracket and a trimmable 43" (109.2 cm) extension

Part Number	Description	Diameter	A	B	C	D	Overall Length
TSOES-2	ORIGINAL Model	2" 50mm	9.8"	27.6"	19.7"	9.1"	59.1"
TSXES-2	ESD/EX Model		250mm	700mm	500mm	230mm	1500mm
TSOES-3	ORIGINAL Model	3" 75mm	9.8"	27.6"	19.7"	9.8"	59.1"
TSXES-3	ESD/EX Model		250mm	700mm	500mm	250 mm	1500mm
TSCES-3	CHEM Model						
TSOES-4	ORIGINAL Model	4" 100mm	10.2"	29.5"	29.5"	10.6"	70.9"
TSXES-4	ESD/EX Model		260 mm	750mm	750mm	270mm	1800mm
TSCES-4	CHEM Model						

Universal Mini Hood and Interface

Nederman BenchTop arms are supplied with a mini hood as standard - no extra extraction nozzle is required. The mini hood is also a universal interface for connecting to other hoods. A larger metal hood or transparent multipurpose hood can be attached directly to the mini hood, irrespective of arm size.

The optional multi-purpose hood can be used both as a dome and a screen hood. It has excellent screening properties, is fully transparent and does not cause optical distortions. The hood can be easily angled to suit any extraction situation.



Metal Hood



Multi-purpose Hood

Description	Ø50mm	Ø75mm	Ø100mm
For ORIGINAL	TS70500444		
For ESD/EX	TS70500544		
For CHEM	TS70500444		

Description	Ø50mm	Ø75mm	Ø100mm
For ORIGINAL	TS70500144		
For ESD/EX	TS70500244		
For CHEM	TS70500344		

Bench and Wall Shelving



A place for everything and everything in its place



Stanchion Spacing

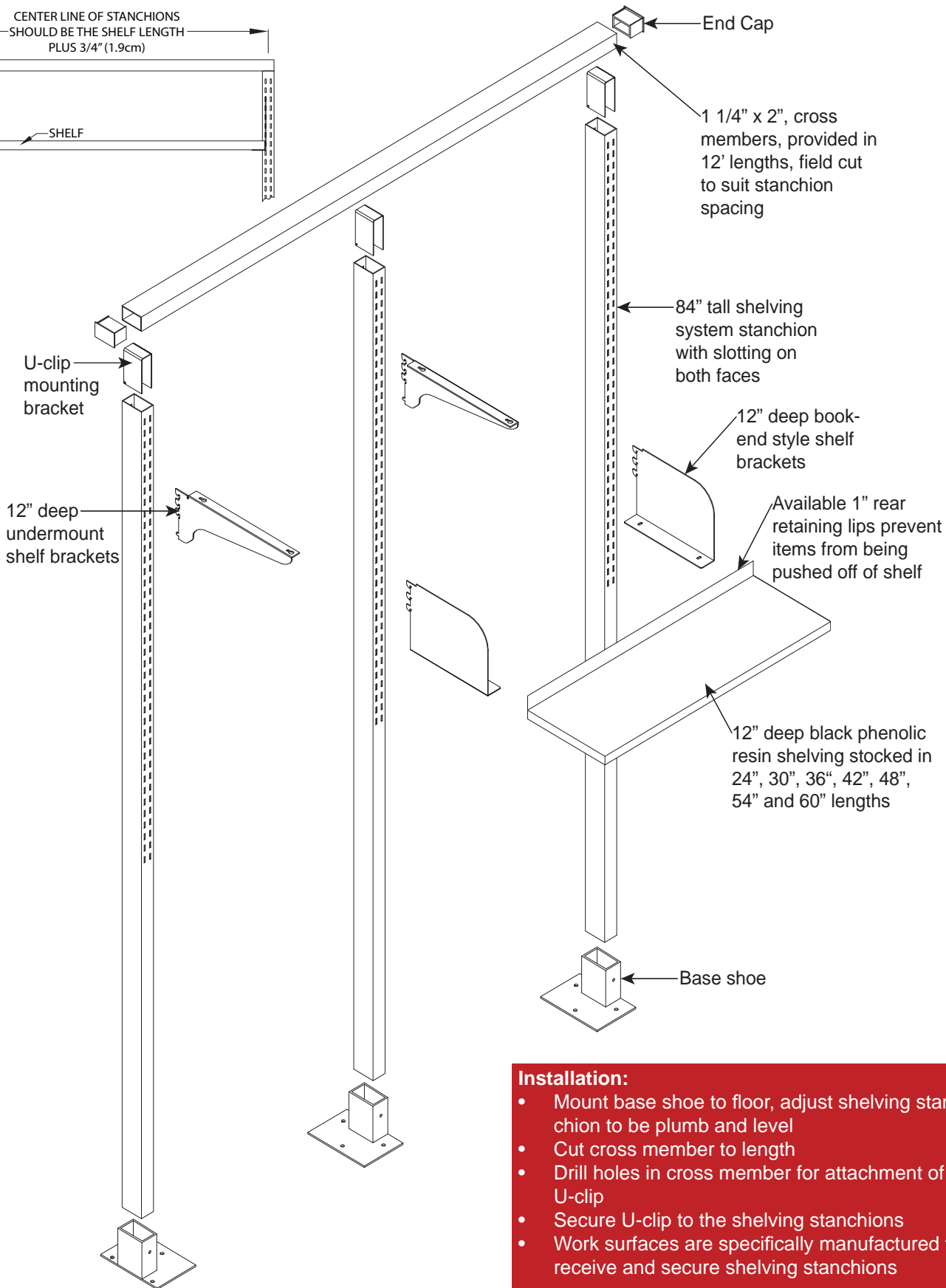
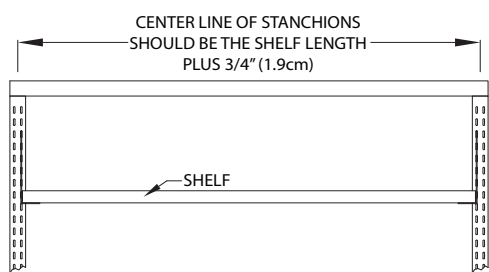

Installation:

- Mount base shoe to floor, adjust shelving stanchion to be plumb and level
- Cut cross member to length
- Drill holes in cross member for attachment of U-clip
- Secure U-clip to the shelving stanchions
- Work surfaces are specifically manufactured to receive and secure shelving stanchions

Shelving and Shelving Systems

Brushed Zinc Bench Shelving System



All steel components come in a distinctive brushed zinc finish that resembles stainless steel.

Wall Standard

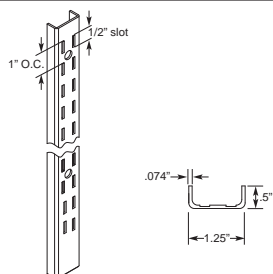

- General purpose shelving and hang rod
- .074" thick steel
- On center dimension from counter-sunk screw hole to counter-sunk screw hole is 6"

TS44-3	36" L (91.4 cm)
--------	-----------------

Peninsula/Island Stanchion

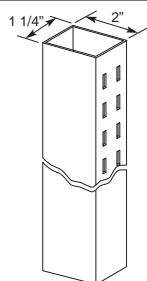

- Double faced and double slotted
- This shelving system is for use between back to back cabinets
- Work surfaces are to be specifically bored to receive and secure stanchions
- 16 ga. steel

TS80-7	84" L (213.4 cm)
--------	------------------

Cross Member

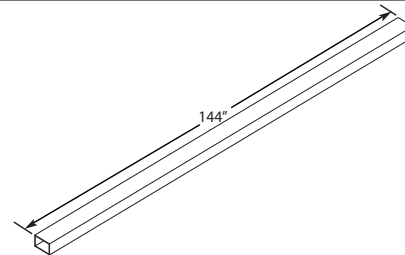

- 16 ga. construction
- Cut to fit stanchion spacing

TS79-12	144" L (365.8 cm)
---------	-------------------

Bookend Shelf Bracket

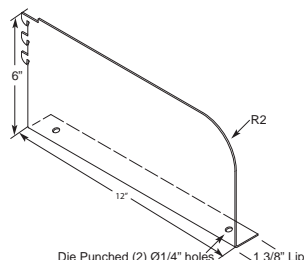

- 14 ga. steel
- (2) die punched 1/4" diameter holes
- Works with wall mount standard or stanchion

TS84L	Left Hand	12" D (30.5 cm)
TS84R	Right Hand	12" D (30.5 cm)

Undermount Shelf Bracket

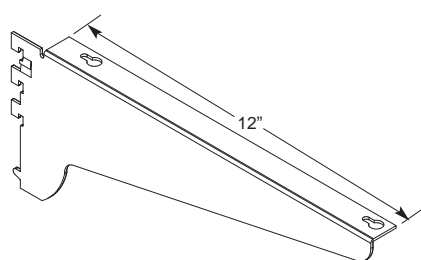

- 14 ga. tempered steel with stabilizer tab
- Keyhole slots for shelf mounting
- Works with wall mount standard or stanchion

TS81L	Left Hand	12" D (30.5 cm)
TS81R	Right Hand	12" D (30.5 cm)

Cross Member Splice



- 16 ga. construction
- Use to connect two cross members for systems for longer than 144"

TS78	12" (30.5 cm)
------	---------------

U-Clip Mounting Bracket

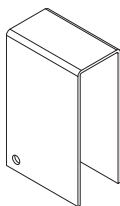

- Fits inside stanchion for the secure attachment to cross member

TS55

Base Shoe

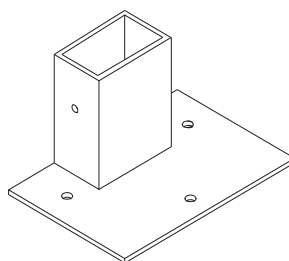

- For use as an anchoring plate with peninsula/island upright assembly
- 16 ga. construction

TS10

End Cap

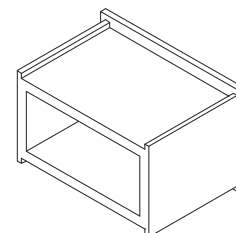

- Inserted at each exposed end of cross member
- Black plastic

TS13

Phenolic Shelving

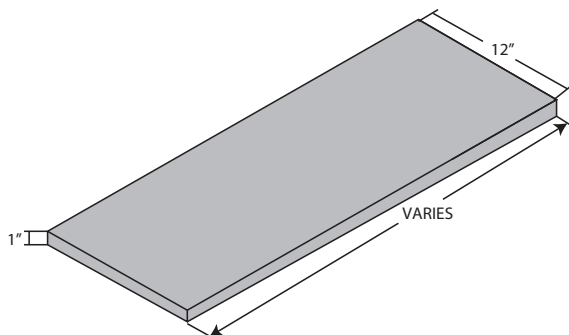

8" Deep	12" Deep	16" Deep	Width
PS0824TS	PS1224TS	PS1624TS	24" W (61 cm)
PS0830TS	PS1230TS	PS1630TS	30" W (76.2 cm)
PS0836TS	PS1236TS	PS1636TS	36" W (91.4 cm)
PS0842TS	PS1242TS	PS1642TS	42" W (106.7 cm)
PS0848TS	PS1248TS	PS1648TS	48" W (121.9 cm)
PS0854TS	PS1254TS	PS1654TS	54" W (137.2 cm)
PS0860TS	PS1260TS	PS1660TS	60" W (152.4 cm)

- Chemical resistant black phenolic resin
- 1" thick
- Front edge finished
- **Contact us for custom sizes that can ship in 6 days**

Rear Retaining Lips

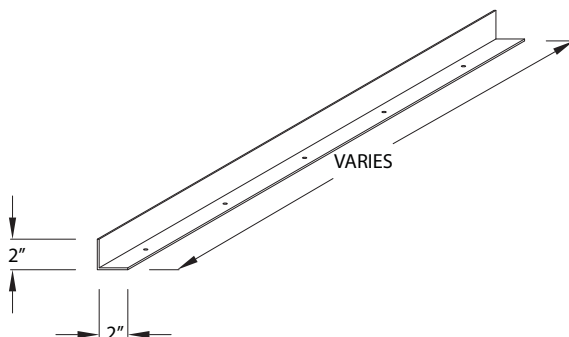

- Provides 1" rear lip for island or peninsula shelving when used with 1" thick shelves
- Attaches to the bottom of shelf
- Holes for attachment spaced at 6" intervals
- Sized to fit shelf
- 16 ga. construction

Brushed Zinc	Painted Steel	Length
SLA24TS	PSRL24TS	24" L (61 cm)
SLA30TS	PSRL30TS	30" L (76.2 cm)
SLA36TS	PSRL36TS	36" L (91.4 cm)
SLA42TS	PSRL42TS	42" L (106.7 cm)
SLA48TS	PSRL48TS	48" L (121.9 cm)
SLA54TS	PSRL54TS	54" L (137.2 cm)
SLA60TS	PSRL60TS	60" L (152.4 cm)
SLA144TS	PSRL144TS	144" L (365.8 cm)

Bench Mounted Reagent Poles - Painted

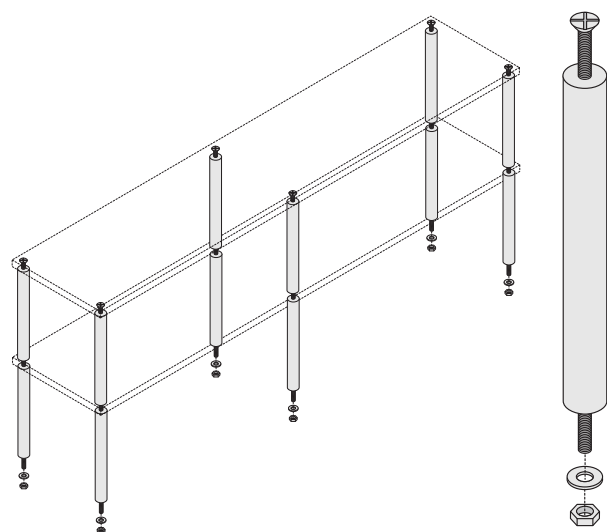

- 1" diameter painted steel pole is threaded at both ends
- Bolts through the work surface for secure mounting
- Poles can stack to create tiered shelves in the center of a bench
- Shelving is custom made withing a week
- Fastener on the reagent shelf surfaces is recessed
- Hardware is included for each installation
- Paint finish is "Pearl White"

RP-12TS	12" L (30.5 cm)
RP-15TS	15" L (38.1 cm)
RP-18TS	18" L (45.7 cm)
RP-24TS	24" L (61 cm)

Shelving and Shelving Systems

Painted Bench Shelving System

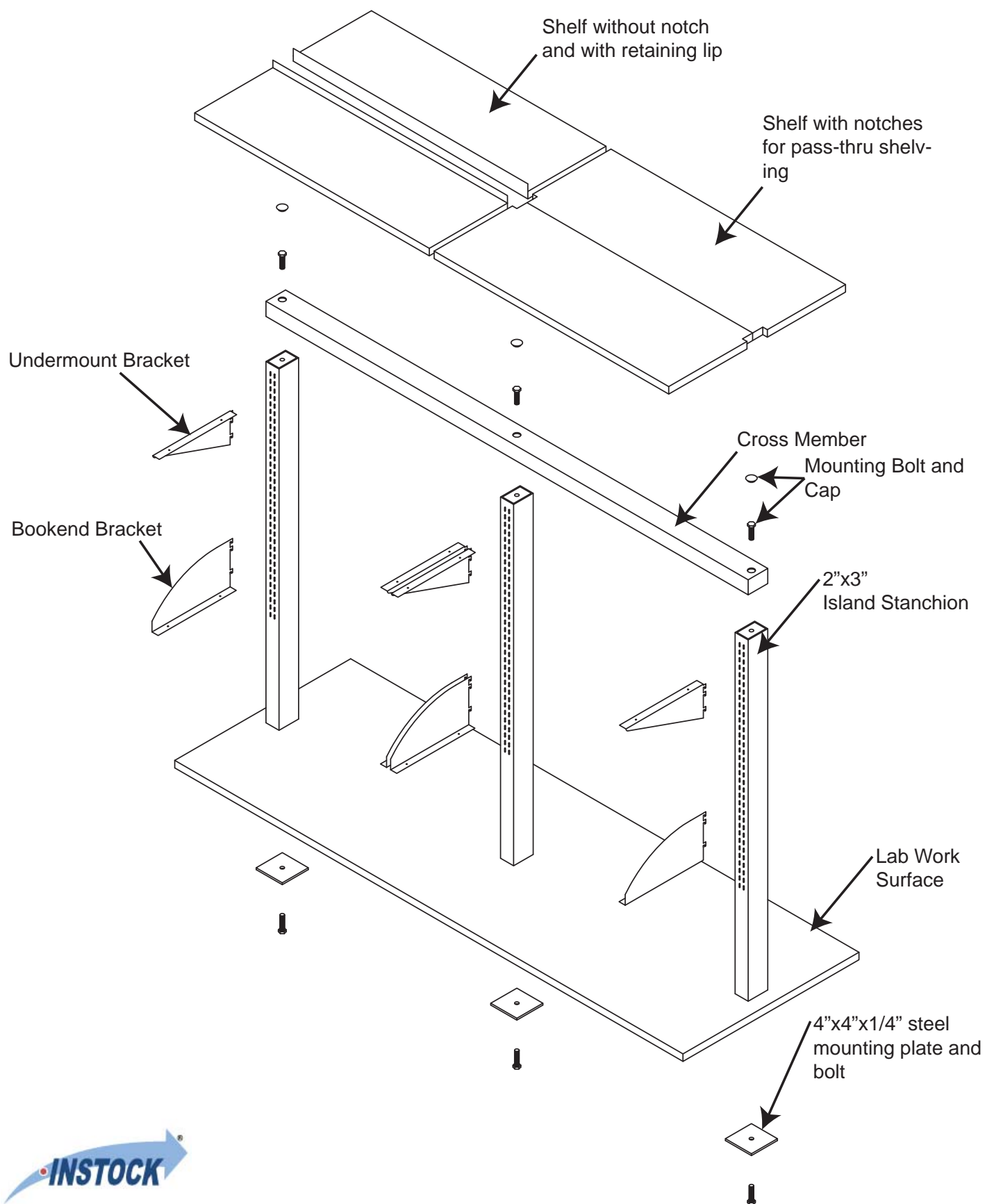

All steel components are painted "Pearl White"



All steel components are painted "Pearl White"

Island Stanchion

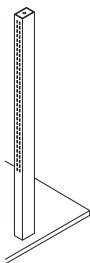

- 48" Tall
- 11 ga.
- All hardware is included

FT-23-4BTS	48" L (121.9 cm)
------------	------------------

Wall Standard



FC-36TS	36" L (91.4 cm)
FC-48TS	48" L (121.1 cm)
FC-60TS	60" L (152.4 cm)
FC-72TS	72" L (182.9 cm)

Cross Member

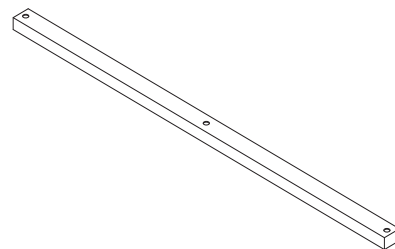

- Cross members are custom made for each project
- Priced in 12" increments
- Welded and caps
- All hardware is included
- Contact us for full details

CR-2324TS	24" W (61 cm)
CR-2336TS	36" W (91.4 cm)
CR-2348TS	48" W (121.9 cm)
CR-2360TS	60" W (152.4 cm)
CR-2372TS	72" W (182.9 cm)
CR-2384TS	84" W (213.4 cm)
CR-2396TS	96" W (243.8 cm)
CR-23108TS	108" W (274.3 cm)
CR-23120TS	120" W (304.8 cm)
CR-23132TS	132" W (335.3 cm)
CR-23144TS	144" W (365.8 cm)

Bookend Shelf Bracket

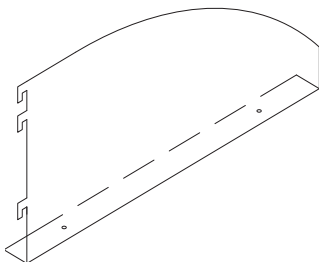

FTB-8LTS	Left	8" D (20.3 cm)
FTB-12LTS	Left	12" D (30.5 cm)
FTB-16LTS	Left	16" D (40.6 cm)
FTB-8RTS	Right	8" D (20.3 cm)
FTB-12RTS	Right	12" D (30.5 cm)
FTB-16RTS	Right	16" D (40.6 cm)

Undermount Bracket

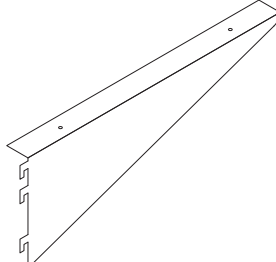

FTBL-8LTS	Left	8" D (20.3 cm)
FTBL-12LTS	Left	12" D (30.5 cm)
FTBL-16LTS	Left	16" D (40.6 cm)
FTBL-8RTS	Right	8" D (20.3 cm)
FTBL-12RTS	Right	12" D (30.5 cm)
FTBL-16RTS	Right	16" D (40.6 cm)

Notched Shelving for Island Stanchions

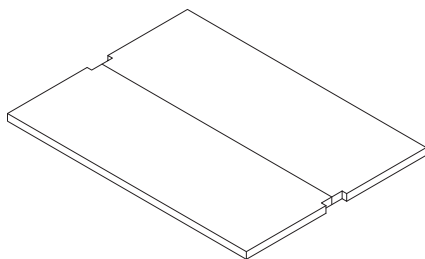

- Chemical resistant black phenolic resin
- 1" thick
- Front edge finished
- Notched around standards to create a pass-thru shelf
- Contact us for retaining lips

8" Deep	12" Deep	16" Deep	Width
PSN0824TS	PSN1224TS	PSN1624TS	24" W (61 cm)
PSN0830TS	PSN1230TS	PSN1630TS	30" W (76.2 cm)
PSN0836TS	PSN1236TS	PSN1636TS	36" W (91.4 cm)
PSN0842TS	PSN1242TS	PSN1642TS	42" W (106.7 cm)
PSN0848TS	PSN1248TS	PSN1648TS	48" W (121.9 cm)
PSN0854TS	PSN1254TS	PSN1654TS	54" W (137.2 cm)
PSN0860TS	PSN1260TS	PSN1660TS	60" W (152.4 cm)

Lab Workstations and Tables

Heavy Duty Steel Tables Fixed Height



Leveling Glide, Fixed Height



TS-4824-FE	48" W x 24" D x 37" H
TS-4824-FP	(121.9cm x 61cm x 94cm)
TS-6024-FE	60" W x 24" D x 37" H
TS-6024-FP	(152.4cm x 61cm x 94cm)
TS-7224-FE	72" W x 24" D x 37" H
TS-7224-FP	(182.9cm x 61cm x 94cm)
TS-8424-FE	84" W x 24" D x 37" H
TS-8424-FP	(213.4cm x 61cm x 94cm)
TS-9624-FE	96" W x 24" D x 37" H
TS-9624-FP	(243.8cm x 61cm x 94cm)
TS-4830-FE	48" W x 30" D x 37" H
TS-4830-FP	(121.9cm x 76.2cm x 94cm)
TS-6030-FE	60" W x 30" D x 37" H
TS-6030-FP	(152.4cm x 76.2cm x 94cm)
TS-7230-FE	72" W x 30" D x 37" H
TS-7230-FP	(182.9cm x 76.2cm x 94cm)
TS-8430-FE	84" W x 30" D x 37" H
TS-8430-FP	(213.4cm x 76.2cm x 94cm)
TS-9630-FE	96" W x 30" D x 37" H
TS-9630-FP	(243.8cm x 76.2cm x 94cm)
TS-4836-FE	48" W x 36" D x 37" H
TS-4836-FP	(121.9cm x 91.4cm x 94cm)
TS-6036-FE	60" W x 36" D x 37" H
TS-6036-FP	(152.4cm x 91.4cm x 94cm)
TS-7236-FE	72" W x 36" D x 37" H
TS-7236-FP	(182.9cm x 91.4cm x 94cm)
TS-8436-FE	84" W x 36" D x 37" H
TS-8436-FP	(213.4cm x 91.4cm x 94cm)
TS-9636-FE	96" W x 36" D x 37" H
TS-9636-FP	(243.8cm x 91.4cm x 94cm)

Casters, Fixed Height



TS-4824-CFE	48" W x 24" D x 37" H
TS-4824-CFP	(121.9cm x 61cm x 94cm)
TS-6024-CFE	60" W x 24" D x 37" H
TS-6024-CFP	(152.4cm x 61cm x 94cm)
TS-7224-CFE	72" W x 24" D x 37" H
TS-7224-CFP	(182.9cm x 61cm x 94cm)
TS-8424-CFE	84" W x 24" D x 37" H
TS-8424-CFP	(213.4cm x 61cm x 94cm)
TS-9624-CFE	96" W x 24" D x 37" H
TS-9624-CFP	(243.8cm x 61cm x 94cm)
TS-4830-CFE	48" W x 30" D x 37" H
TS-4830-CFP	(121.9cm x 76.2cm x 94cm)
TS-6030-CFE	60" W x 30" D x 37" H
TS-6030-CFP	(152.4cm x 76.2cm x 94cm)
TS-7230-CFE	72" W x 30" D x 37" H
TS-7230-CFP	(182.9cm x 76.2cm x 94cm)
TS-8430-CFE	84" W x 30" D x 37" H
TS-8430-CFP	(213.4cm x 76.2cm x 94cm)
TS-9630-CFE	96" W x 30" D x 37" H
TS-9630-CFP	(243.8cm x 76.2cm x 94cm)
TS-4836-CFE	48" W x 36" D x 37" H
TS-4836-CFP	(121.9cm x 91.4cm x 94cm)
TS-6036-CFE	60" W x 36" D x 37" H
TS-6036-CFP	(152.4cm x 91.4cm x 94cm)
TS-7236-CFE	72" W x 36" D x 37" H
TS-7236-CFP	(182.9cm x 91.4cm x 94cm)
TS-8436-CFE	84" W x 36" D x 37" H
TS-8436-CFP	(213.4cm x 91.4cm x 94cm)
TS-9636-CFE	96" W x 36" D x 37" H
TS-9636-CFP	(243.8cm x 91.4cm x 94cm)

Heavy Duty Casters, Fixed Height



TS-4824-HCFE	48" W x 24" D x 37" H
TS-4824-HCFP	(121.9cm x 61cm x 94cm)
TS-6024-HCFE	60" W x 24" D x 37" H
TS-6024-HCFP	(152.4cm x 61cm x 94cm)
TS-7224-HCFE	72" W x 24" D x 37" H
TS-7224-HCFP	(182.9cm x 61cm x 94cm)
TS-8424-HCFE	84" W x 24" D x 37" H
TS-8424-HCFP	(213.4cm x 61cm x 94cm)
TS-9624-HCFE	96" W x 24" D x 37" H
TS-9624-HCFP	(243.8cm x 61cm x 94cm)
TS-4830-HCFE	48" W x 30" D x 37" H
TS-4830-HCFP	(121.9cm x 76.2cm x 94cm)
TS-6030-HCFE	60" W x 30" D x 37" H
TS-6030-HCFP	(152.4cm x 76.2cm x 94cm)
TS-7230-HCFE	72" W x 30" D x 37" H
TS-7230-HCFP	(182.9cm x 76.2cm x 94cm)
TS-8430-HCFE	84" W x 30" D x 37" H
TS-8430-HCFP	(213.4cm x 76.2cm x 94cm)
TS-9630-HCFE	96" W x 30" D x 37" H
TS-9630-HCFP	(243.8cm x 76.2cm x 94cm)
TS-4836-HCFE	48" W x 36" D x 37" H
TS-4836-HCFP	(121.9cm x 91.4cm x 94cm)
TS-6036-HCFE	60" W x 36" D x 37" H
TS-6036-HCFP	(152.4cm x 91.4cm x 94cm)
TS-7236-HCFE	72" W x 36" D x 37" H
TS-7236-HCFP	(182.9cm x 91.4cm x 94cm)
TS-8436-HCFE	84" W x 36" D x 37" H
TS-8436-HCFP	(213.4cm x 91.4cm x 94cm)
TS-9636-HCFE	96" W x 36" D x 37" H
TS-9636-HCFP	(243.8cm x 91.4cm x 94cm)

Leveling Glide



- 1/2" glide with a 1/2" stem thread
- All tables with leveling glides are rated for 2000 lbs.

Work Surface Key

Work Surface is 1" Thick

Epoxy Work Surface

Phenolic Work Surface

Caster



- Locking swivel-ing casters
- Tables with casters are rated for 960 lbs.

Leveling Glide, Adjustable Height

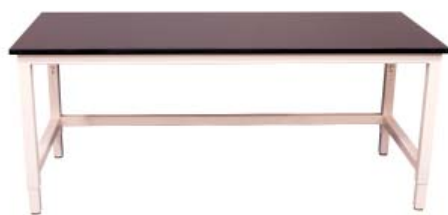

Casters, Adjustable Height



Heavy Duty Casters, Adjustable Height



TS-4824-AE	48" W x 24" D x 30"-37" H
TS-4824-AP	(121.9cm x 61cm x 76.2-94cm)
TS-6024-AE	60" W x 24" D x 30"-37" H
TS-6024-AP	(152.4cm x 61cm x 76.2-94cm)
TS-7224-AE	72" W x 24" D x 30"-37" H
TS-7224-AP	(182.9cm x 61cm x 76.2-94cm)
TS-8424-AE	84" W x 24" D x 30"-37" H
TS-8424-AP	(213.4cm x 61cm x 76.2-94cm)
TS-9624-AE	96" W x 24" D x 30"-37" H
TS-9624-AP	(243.8cm x 61cm x 76.2-94cm)
TS-4830-AE	48" W x 30" D x 30"-37" H
TS-4830-AP	(121.9cm x 76.2cm x 76.2-94cm)
TS-6030-AE	60" W x 30" D x 30"-37" H
TS-6030-AP	(152.4cm x 76.2cm x 76.2-94cm)
TS-7230-AE	72" W x 30" D x 30"-37" H
TS-7230-AP	(182.9cm x 76.2cm x 76.2-94cm)
TS-8430-AE	84" W x 30" D x 30"-37" H
TS-8430-AP	(213.4cm x 76.2cm x 76.2-94cm)
TS-9630-AE	96" W x 30" D x 30"-37" H
TS-9630-AP	(243.8cm x 76.2cm x 76.2-94cm)
TS-4836-AE	48" W x 36" D x 30"-37" H
TS-4836-AP	(121.9cm x 91.4cm x 76.2-94cm)
TS-6036-AE	60" W x 36" D x 30"-37" H
TS-6036-AP	(152.4cm x 91.4cm x 76.2-94cm)
TS-7236-AE	72" W x 36" D x 30"-37" H
TS-7236-AP	(182.9cm x 91.4cm x 76.2-94cm)
TS-8436-AE	84" W x 36" D x 30"-37" H
TS-8436-AP	(213.4cm x 91.4cm x 76.2-94cm)
TS-9636-AE	96" W x 36" D x 30"-37" H
TS-9636-AP	(243.8cm x 91.4cm x 76.2-94cm)

TS-4824-CAE	48" W x 24" D x 30"-37" H
TS-4824-CAP	(121.9cm x 61cm x 76.2-94cm)
TS-6024-CAE	60" W x 24" D x 30"-37" H
TS-6024-CAP	(152.4cm x 61cm x 76.2-94cm)
TS-7224-CAE	72" W x 24" D x 30"-37" H
TS-7224-CAP	(182.9cm x 61cm x 76.2-94cm)
TS-8424-CAE	84" W x 24" D x 30"-37" H
TS-8424-CAP	(213.4cm x 61cm x 76.2-94cm)
TS-9624-CAE	96" W x 24" D x 30"-37" H
TS-9624-CAP	(243.8cm x 61cm x 76.2-94cm)
TS-4830-CAE	48" W x 30" D x 30"-37" H
TS-4830-CAP	(121.9cm x 76.2cm x 76.2-94cm)
TS-6030-CAE	60" W x 30" D x 30"-37" H
TS-6030-CAP	(152.4cm x 76.2cm x 76.2-94cm)
TS-7230-CAE	72" W x 30" D x 30"-37" H
TS-7230-CAP	(182.9cm x 76.2cm x 76.2-94cm)
TS-8430-CAE	84" W x 30" D x 30"-37" H
TS-8430-CAP	(213.4cm x 76.2cm x 76.2-94cm)
TS-9630-CAE	96" W x 30" D x 30"-37" H
TS-9630-CAP	(243.8cm x 76.2cm x 76.2-94cm)
TS-4836-CAE	48" W x 36" D x 30"-37" H
TS-4836-CAP	(121.9cm x 91.4cm x 76.2-94cm)
TS-6036-CAE	60" W x 36" D x 30"-37" H
TS-6036-CAP	(152.4cm x 91.4cm x 76.2-94cm)
TS-7236-CAE	72" W x 36" D x 30"-37" H
TS-7236-CAP	(182.9cm x 91.4cm x 76.2-94cm)
TS-8436-CAE	84" W x 36" D x 30"-37" H
TS-8436-CAP	(213.4cm x 91.4cm x 76.2-94cm)
TS-9636-CAE	96" W x 36" D x 30"-37" H
TS-9636-CAP	(243.8cm x 91.4cm x 76.2-94cm)

TS-4824-HCAE	48" W x 24" D x 30"-37" H
TS-4824-HCAP	(121.9cm x 61cm x 76.2-94cm)
TS-6024-HCAE	60" W x 24" D x 30"-37" H
TS-6024-HCAP	(152.4cm x 61cm x 76.2-94cm)
TS-7224-HCAE	72" W x 24" D x 30"-37" H
TS-7224-HCAP	(182.9cm x 61cm x 76.2-94cm)
TS-8424-HCAE	84" W x 24" D x 30"-37" H
TS-8424-HCAP	(213.4cm x 61cm x 76.2-94cm)
TS-9624-HCAE	96" W x 24" D x 30"-37" H
TS-9624-HCAP	(243.8cm x 61cm x 76.2-94cm)
TS-4830-HCAE	48" W x 30" D x 30"-37" H
TS-4830-HCAP	(121.9cm x 76.2cm x 76.2-94cm)
TS-6030-HCAE	60" W x 30" D x 30"-37" H
TS-6030-HCAP	(152.4cm x 76.2cm x 76.2-94cm)
TS-7230-HCAE	72" W x 30" D x 30"-37" H
TS-7230-HCAP	(182.9cm x 76.2cm x 76.2-94cm)
TS-8430-HCAE	84" W x 30" D x 30"-37" H
TS-8430-HCAP	(213.4cm x 76.2cm x 76.2-94cm)
TS-9630-HCAE	96" W x 30" D x 30"-37" H
TS-9630-HCAP	(243.8cm x 76.2cm x 76.2-94cm)
TS-4836-HCAE	48" W x 36" D x 30"-37" H
TS-4836-HCAP	(121.9cm x 91.4cm x 76.2-94cm)
TS-6036-HCAE	60" W x 36" D x 30"-37" H
TS-6036-HCAP	(152.4cm x 91.4cm x 76.2-94cm)
TS-7236-HCAE	72" W x 36" D x 30"-37" H
TS-7236-HCAP	(182.9cm x 91.4cm x 76.2-94cm)
TS-8436-HCAE	84" W x 36" D x 30"-37" H
TS-8436-HCAP	(213.4cm x 91.4cm x 76.2-94cm)
TS-9636-HCAE	96" W x 36" D x 30"-37" H
TS-9636-HCAP	(243.8cm x 91.4cm x 76.2-94cm)

Heavy Duty Casters



- Extra heavy duty locking, swiveling casters
- Rated for 2000 lbs.
- Leveling foot pad provides vibration isolation

Work Surface Key

Work Surface is 1" Thick

Epoxy Work Surface

Phenolic Work Surface

Adjustable Height - Mechanical



- Bolt and snap pin system
- Snap pin is a 3/8" T6 bolt
- Adjustable in 1" increments

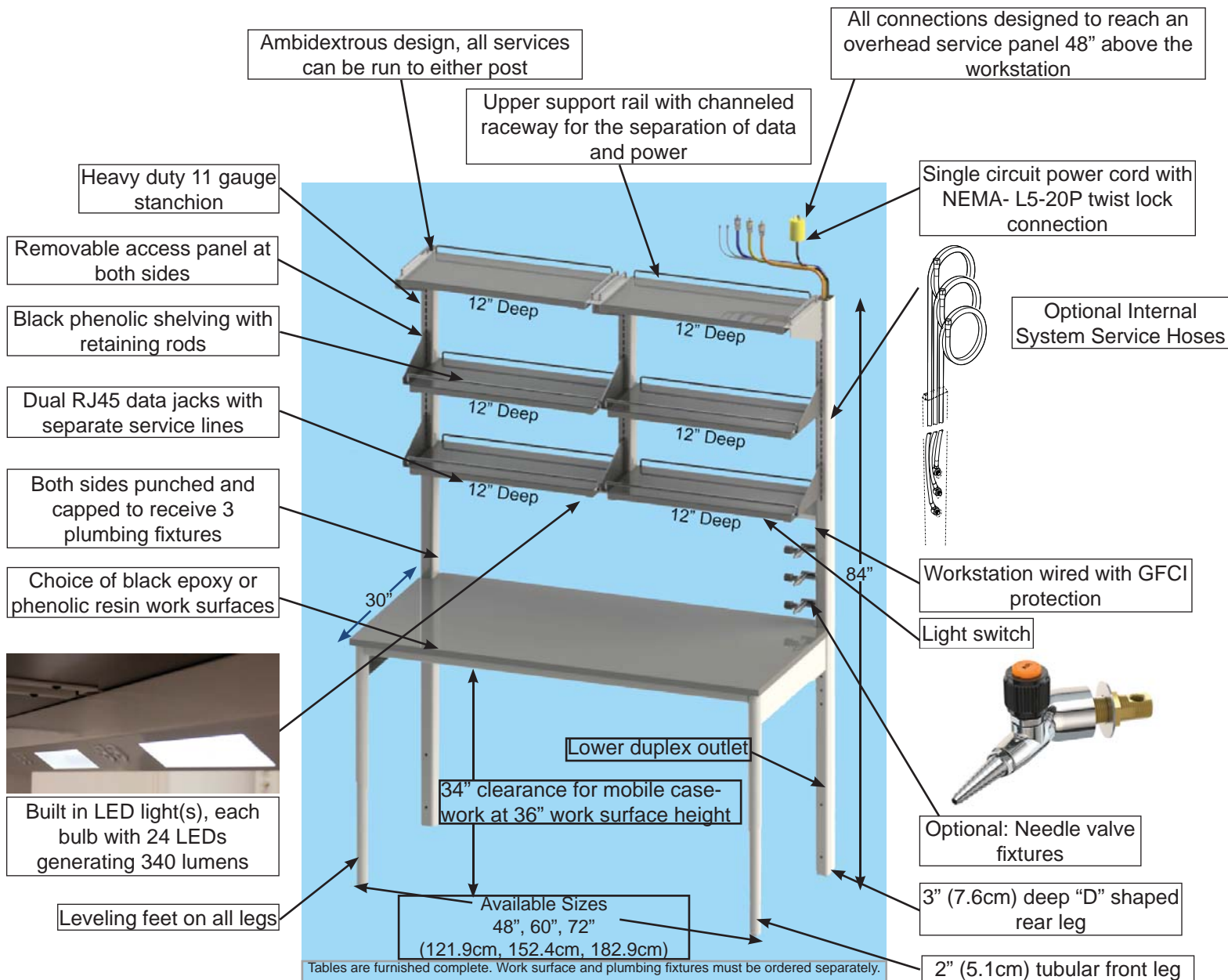

Envision Workstation Standard Features:

- UL 962 listed
- Available sizes: 48" (121.9 cm), 60" (152.4 cm), 72" (182.9 cm)
- Designed for back to back use for optimal lab layout flexibility
- Heavy duty powder coated steel construction
- Painted steel color is Pearl White
- Adjustable Height work surface frame: 30" - 36" (76.2 cm - 91.4 cm)
- Three tiers of 12" (30.5 cm) deep adjustable black phenolic resin shelving with rear retaining rods
- Table fully pre wired with GFCI protected power, data and LED lights
- The workstation is pre wired with one power circuit
- Plumbing & electrical services can be run to either side of workstation
- Each post is punched & capped to accept three plumbing services
- Built-in LED task light(s) with anti-glare shield
- Provided with 2 individual CAT6B data lines and 2 RJ45 ports
- All service connections are designed to reach 48" above workstation

Envision Workstation Optional Features:

- Choice of black epoxy or phenolic resin work surfaces
- Complete plumbing assemblies with quick-connect fittings
- Mobile cabinets
- Overhead service panels with quick-connect fittings

Envision Workstations



Tables are furnished complete with shelving and electrical fixtures. Work surface and plumbing fixtures must be ordered separately.

Envision Workstations

ENO-3048TS	48" W (121.9 cm)
ENO-3060TS	60" W (152.4 cm)
ENO-3072TS	72" W (182.9 cm)

Work Surfaces for Envision Workstations

1" Thick Black Epoxy	1" Thick Black Phenolic	
EWS-48TS	PWS-48TS	48" W (121.9 cm)
EWS-60TS	PWS-60TS	60" W (152.4 cm)
EWS-72TS	PWS-72TS	72" W (182.9 cm)

Standard Features

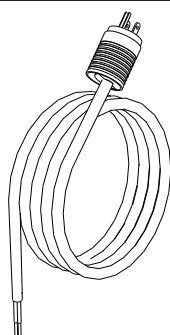

Each table is provided with one electrical cord to carry power from the overhead service panel to the top of the frame. Each cord has one 125 volt, 20 amp circuit and includes a twist lock NEMA L5-20P plug



Each table provided with 2 each RJ45 CAT6B data ports and separate service lines



48" tables are provided with one light fixture. 60" and 72" tables are provided with two light fixtures. All lights are prewired and include a switch. Each bulb includes 24 LEDs that generate 340 lumens.

Mobile Cabinets



- Heavy duty painted steel construction
- Cabinets are 22" deep and 27 13/16" tall (with casters) with a finished back
- Mobile cabinets include locking swivel casters
- Provided without locks
- Anti-tip design
- Work surface sold separately

TS1018-18P	18" W (45.7 cm)
TS1018-24P	24" W (61 cm)



- Heavy duty painted steel construction
- Cabinets are 22" deep and 27 13/16" tall (with casters) with a finished back
- Mobile cabinets include locking swivel casters
- Provided without locks
- Anti-tip design
- Work surface sold separately

TS1021-18	18" W (45.7 cm)
TS1021-24	24" W (61 cm)

Mobile Cabinet Work Surface

- 1/2" thick black phenolic resin with 1" overhang on the front and 1/2" overhang at the rear and sides
- Grip notch under front edge of work surface to help maneuver cabinet

	For use with
MWS-18TS	18" W (45.7 cm) cabinet
MWS-24TS	24" W (61 cm) cabinet

INSTOCK WaterSaver plumbing assemblies for the Envision table system are furnished complete and include all of the components shown on this page. Assemblies include a fine control needle valve service turret with shank, a service hose as well as a male quick disconnect fitting. These complete assemblies are designed specifically for use in the laboratory environment. All quick connects have 316 stainless steel internal components. Keyed quick connects will only couple with components of the same key with are identified by a color code. Assemblies consist of 2 major components and are shipped loose to be installed at the job site.

Complete Plumbing Assemblies

Includes male quick connect, system hose and service turret. Female panel mount fixture must be ordered separately.

Service	Color	Left Side Assemblies	Right Side Assemblies
Helium	Black	TSV-H-L	TSV-H-R
Air	Orange	TSV-A-L	TSV-A-R
Vacuum	Yellow	TSV-V-L	TSV-V-R
Gas	Blue with stainless steel hose	TSV-G-L	TSV-G-R
Special Gas	White	TSV-SG-L	TSV-SG-R
Argon	Purple	TSV-AR-L	TSV-AR-R
Nitrogen	Brown	TSV-N-L	TSV-N-R

System Service Hoses

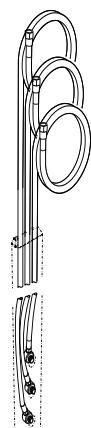

These hoses carry services from the overhead service panel, through the upright of the table and to the shank of the fixture. They consist of either a color coded reinforced PVC or a braided stainless steel, 3/8" hose. Stainless steel is used for gas service. They include two male 3/8" IPS outlet nipples and adapters to attached to the male quick disconnect as well as the shank of the service valve. Each hose extends 48" above the table frame.



Male Quick-Connect 3/8" Fitting/Plug



Double end shut off plugs have an internal valve the shuts off flow when un-coupled and are included with gas service assemblies. Single end shut off plugs do not have an internal valve and are included for all other services.

Fine Control Needle Valve Service Turret



Each unit consists of a 135 degree turret with one polished chrome valve with a brass floating cone and integral brass seat. They provide metering control of laboratory gases at pressures up to 60 PSI. The shank is bored for the connection of the service hose.

Female Quick-Connect Fittings



These female quick disconnect fittings mount within the overhead service panel and connect the quick disconnect fittings from the table system to the building services. All fittings include 3/8" stems and hardware to attach to the overhead service panel. All fitting types are "keyed" to ensure that they couple only with one of the same service.

Service	Color	Part Number
Helium	Black	TSQD-H
Air	Orange	TSQD-A
Vacuum	Yellow	TSQD-V
Gas	Blue	TSQD-G
Special Gas	White	TSQD-SG
Argon	Purple	TSQD-AR
Nitrogen	Brown	TSQD-N

Overhead Service Panels - Made to Order

These panels are designed to fit into a 24" x 24" ceiling grid. They are made to order based upon services required. See example below. Made to order panels can be shipped in 10 days.

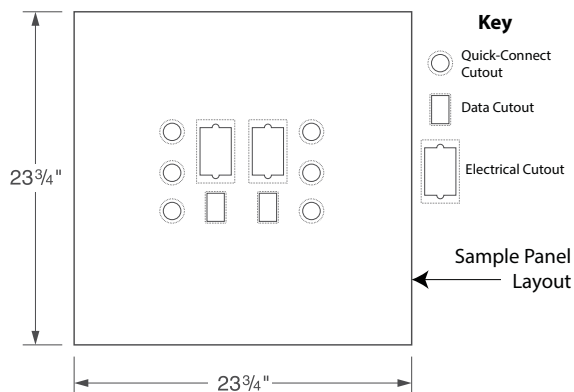

Number of Service Cutouts	Part Number
1-10	ENOSP-10TS
11-20	ENOSP-20TS
21+	ENOSP-30TS

Quick Connect

- Cutout: 1 1/4" Diameter
- Escutcheon: 1 3/4" Diameter

Data

- Cutout: 1 1/4" x 2"
- Escutcheon: 1 1/2" x 2 1/4"

Electrical

- Cutout: 2 1/4" x 3 3/8"
- Faceplate: 2 3/4" x 4 1/2"

Each part number includes an electrical box, the receptacle and a stainless steel cover plate.

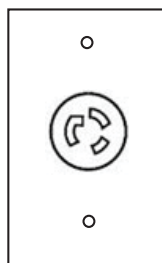

120 V 20 AMP
One circuit
NEMA Configuration:
L5-20R

EN-LEV5-20RTS

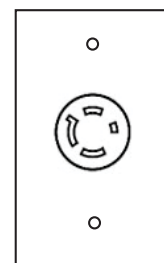

120 V 20 AMP
Two circuit
NEMA Configuration:
L14-20R

EN-LEV14-20RTS

These Flex Lab workstations/instrument carts make an excellent choice for labs needing flexible & versatile lab work space. They can be positioned along the perimeter of a lab or be placed back-to-back in an island configuration. They are furnished as complete assemblies that include work surfaces & shelving as shown. The steel shelving includes book end style brackets and a rear retaining lip. The units can be ordered with either a black epoxy resin or black phenolic work surface. The shelves and work frames are adjustable on 1" increments. The workstations are furnished with 3" casters. Two are locking/swivel and two are swivel. The total weight capacity, uniformly distributed load, of these Flex Lab workstations is 900 lbs.

The default color for the workstations is Pearl White.

We have a wide range of standard & custom laboratory workstations. If you don't see what you need here, please contact your Account Manager for assistance.

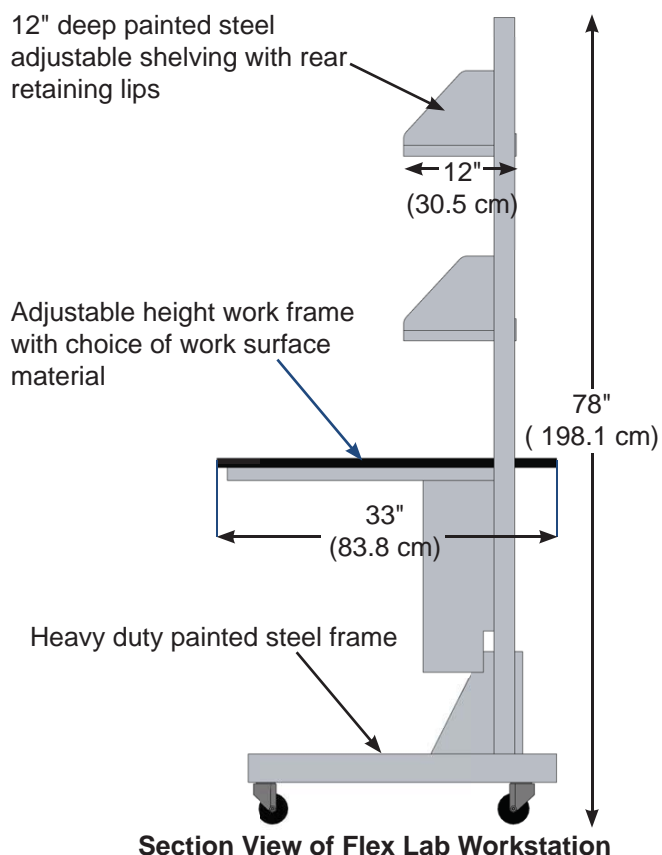

Single Bay Workstation



Double Bay Workstation



Width	Epoxy Work Surface	Phenolic Work Surface
36" (91.4 cm)	TSFC-36E	TSFC-36P
48" (121.9 cm)	TSFC-48E	TSFC-48P

Width	Epoxy Work Surface	Phenolic Work Surface
60" (152.4 cm)	TSFC-60E	TSFC-60P
72" (182.9 cm)	TSFC-72E	TSFC-72P

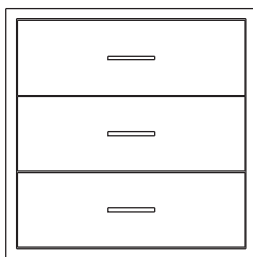
Suspended Drawer Cabinet

- 24.5" Tall
- Pearl white color
- Includes attachment hardware

Part Number	Width
TSP818-18	18" W (45.7 cm)
TSP818-24	24" W (61 cm)

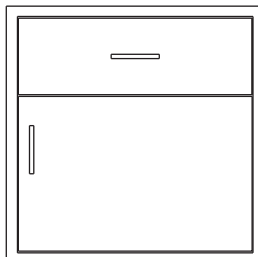
Suspended One Door, One Drawer Cabinets

- 24.5" Tall
- Pearl white color
- Includes attachment hardware

Part Number	Width
TSP805-18	18" W (45.7 cm)
TSP805-24	24" W (61 cm)

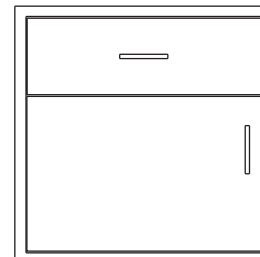

- 24.5" Tall
- Pearl white color
- Includes attachment hardware

Part Number	Width
TSP806-18	18" W (45.7 cm)
TSP806-24	24" W (61 cm)

Other Accessories include:

- Wire raceways can be found on page 70
- Task lighting can be found on page 70



Lab Workstations and Tables

Balance Tables

Balance Table

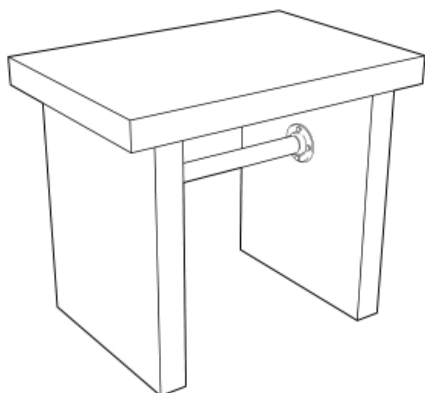

- Balance tables provide a stable and vibration resistant workspace for sensitive procedures
- Work top is 2" thick
- Top, sides and middle supports are all constructed from epoxy black resin material

	Dimensions
TS-BT3624	36" W x 24" D x 30" T (91.4cm x 61cm x 76.2cm)
TS-BT4824	48" W x 24" D x 30" T (121.9cm x 61cm x 76.2cm)





Available in a wide variety of bench styles

- Choose from 3 adjustable height frame styles: 4-leg, light duty motor driven table, or heavy duty C-Frame
- All frames furnished in a light grey powder-coated ESD paint finish
- Large Selection of accessories available
 - Casters, shelves, lighting, power bars, suspended drawer, cabinets and more!
- Ready to ship in just 5 days



Many other bench styles and work surface types are available. Contact your Account Manager for further details.



Shown here: Light duty motor driven table with single bay uprights, power bar, bin rail and monitor holder.

Standard 4-leg table - Mechanically Adjustable Height



Height Range:
25.6" - 35.4"
(65 - 90 cm)



- 1" low pressure laminate
- Light grey
- Plastic edging
- Light grey, ESD laminate surface
- 180° rolled front edge
- 1 3/16" thick

Part Number	Dimensions W x D x H	Work Surface	Max. Load (U.D.L.)
TSTP4830L	48" x 30" x 25.6"-35.4" (121.9 x 76.2 x 65-90cm)	Laminate	660 lbs
TSTP6030L	60" x 30" x 25.6"-35.4" (150 x 76.2 x 65-90 cm)	Laminate	660 lbs
TSTP7230L	72" x 30" x 25.6"-35.4" (182.9 x 76.2 x 65-90 cm)	Laminate	660 lbs
TSTP4830ESD	48" x 30" x 25.6"-35.4" (121.9 x 76.2 x 65-90cm)	ESD Laminate	660 lbs
TSTP6030ESD	60" x 30" x 25.6"-35.4" (150 x 76.2 x 65-90 cm)	ESD Laminate	660 lbs
TSTP7230ESD	72" x 30" x 25.6"-35.4" (182.9 x 76.2 x 65-90 cm)	ESD Laminate	660 lbs

Light Duty Table - Motor Driven Height Adjustable



Height Range:
25.4" - 45.1"
(64.5 - 114.5 cm)

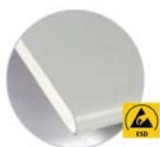

- 1" low pressure laminate
- Light grey, ESD laminate surface
- Light grey
- 180° rolled front edge
- Plastic edging
- 1 3/16" thick

Part Number	Dimensions W x D x H	Work Surface	Max. Load (U.D.L.)
TSLMT4830L	48" x 30" x 25.4"-45.1" (121.9 x 76.2 x 64.5-114.5 cm)	Laminate	330 lbs
TSLMT6030L	60" x 30" x 25.4"-45.1" (150 x 76.2 x 64.5-114.5 cm)	Laminate	330 lbs
TSLMT7230L	72" x 30" x 25.4"-45.1" (182.9 x 76.2 x 64.5-114.5 cm)	Laminate	330 lbs
TSLM-T4830ESD	48" x 30" x 25.4"-45.1" (121.9 x 76.2 x 64.5-114.5 cm)	ESD Laminate	330 lbs
TSLM-T6030ESD	60" x 30" x 25.4"-45.1" (150 x 76.2 x 64.5-114.5 cm)	ESD Laminate	330 lbs
TSLM-T7230ESD	72" x 30" x 25.4"-45.1" (182.9 x 76.2 x 64.5-114.5 cm)	ESD Laminate	330 lbs

Heavy Duty C-Frame Table - Mechanically Adjustable Height



Height Range:
26.6" - 44.3"
(67.5 - 112.5 cm)



- Grey laminate surface
- Light grey, ESD laminate surface
- Black molded "waterfall" edges
- 180° rolled front edge
- 1 3/16" thick
- 1 3/16" thick

Part Number	Dimensions W x D x H	Work Surface	Max. Load (U.D.L.)
TSC4830L	48" x 30" x 26.6"-44.3" (121.9 x 76.2 x 67.5-112.5 cm)	Laminate	1100 lbs.
TSC6030L	60" x 30" x 26.6"-44.3" (150 x 76.2 x 67.5-112.5 cm)	Laminate	1100 lbs.
TSC7230L	72" x 30" x 26.6"-44.3" (182.9 x 76.2 x 67.5-112.5 cm)	Laminate	1100 lbs.
TSC4830ESD	48" x 30" x 26.6"-44.3" (121.9 x 76.2 x 67.5-112.5 cm)	ESD Laminate	1100 lbs.
TSC6030ESD	60" x 30" x 26.6"-44.3" (150 x 76.2 x 67.5-112.5 cm)	ESD Laminate	1100 lbs.
TSC7230ESD	72" x 30" x 26.6"-44.3" (182.9 x 76.2 x 67.5-112.5 cm)	ESD Laminate	1100 lbs.

Preconfigured Workstations with Uprights - Single Bay



Height Range:
4-Leg
25.6" - 35.4"
(65 - 90 cm)

- Shelves and other accessories must be ordered separately

Part Number	Dimensions W x D x Work Surface Height	Work Surface
Standard 4-leg Table		
TSTP4830LSB	48" x 30" x 25.6"-35.4" (121.9 x 76.2 x 65-90 cm)	Laminate
TSTP6030LSB	60" x 30" x 25.6"-35.4" (152.4 x 76.2 x 65-90 cm)	Laminate
TSTP7230LSB	72" x 30" x 25.6"-35.4" (182.9 x 76.2 x 65-90 cm)	Laminate
TSTP4830ESDSB	48" x 30" x 25.6"-35.4" (121.9 x 76.2 x 65-90 cm)	ESD Laminate
TSTP6030ESDSB	60" x 30" x 25.6"-35.4" (152.4 x 76.2 x 65-90 cm)	ESD Laminate
TSTP7230ESDSB	72" x 30" x 25.6"-35.4" (182.9 x 76.2 x 65-90 cm)	ESD Laminate
Light Duty Table		
TSLMT4830LSB	48" x 30" x 25.4"-45.1" (121.9 x 76.2 x 64.5-114.5 cm)	Laminate
TSLMT6030LSB	60" x 30" x 25.4"-45.1" (152.4 x 76.2 x 64.5-114.5 cm)	Laminate
TSLMT7230LSB	72" x 30" x 25.4"-45.1" (182.9 x 76.2 x 64.5-114.5 cm)	Laminate
TSLMT4830ESDSB	48" x 30" x 25.4"-45.1" (121.9 x 76.2 x 64.5-114.5 cm)	ESD Laminate
TSLMT6030ESDSB	60" x 30" x 25.4"-45.1" (152.4 x 76.2 x 64.5-114.5 cm)	ESD Laminate
TSLMT7230ESDSB	72" x 30" x 25.4"-45.1" (182.9 x 76.2 x 64.5-114.5 cm)	ESD Laminate
Heavy Duty C-Frame Table		
TSC4830LSB	48" x 30" x 26.6"-44.3" (121.9 x 76.2 x 67.5-112.5 cm)	Laminate
TSC6030LSB	60" x 30" x 26.6"-44.3" (152.4 x 76.2 x 67.5-112.5 cm)	Laminate
TSC7230LSB	72" x 30" x 26.6"-44.3" (182.9 x 76.2 x 67.5-112.5 cm)	Laminate
TSC4830ESDSB	48" x 30" x 26.6"-44.3" (121.9 x 76.2 x 67.5-112.5 cm)	ESD Laminate
TSC6030ESDSB	60" x 30" x 26.6"-44.3" (152.4 x 76.2 x 67.5-112.5 cm)	ESD Laminate
TSC7230ESDSB	72" x 30" x 26.6"-44.3" (182.9 x 76.2 x 67.5-112.5 cm)	ESD Laminate

Preconfigured Workstations with Uprights - Double Bay



Height Range:
C-Frame:
26.6" - 44.3"
(67.5 - 112.5 cm)

- Shelves and other accessories must be ordered separately

Part Number	Dimensions W x D x Work Surface Height	Work Surface
Standard 4-leg Table		
TSTP6030LDB	60" x 30" x 25.6"-35.4" (152.4 x 76.2 x 65-90 cm)	Laminate
TSTP7230LDB	72" x 30" x 25.6"-35.4" (182.9 x 76.2 x 65-90 cm)	Laminate
TSTP6030ESDDB	60" x 30" x 25.6"-35.4" (152.4 x 76.2 x 65-90 cm)	ESD Laminate
TSTP7230ESDDB	72" x 30" x 25.6"-35.4" (182.9 x 76.2 x 65-90 cm)	ESD Laminate
Heavy Duty C-Frame Table		
TSC6030LDB	60" x 30" x 26.6"-44.3" (152.4 x 76.2 x 67.5-112.5 cm)	Laminate
TSC7230LDB	72" x 30" x 26.6"-44.3" (182.9 x 76.2 x 67.5-112.5 cm)	Laminate
TSC6030ESDDB	60" x 30" x 26.6"-44.3" (152.4 x 76.2 x 67.5-112.5 cm)	ESD Laminate
TSC7230ESDDB	72" x 30" x 26.6"-44.3" (182.9 x 76.2 x 67.5-112.5 cm)	ESD Laminate

Technical Workstations and Tables

Technical Workstation Accessories



LED Lighting



- Power cord is 10 ft long

Part Number	Type
TSLED24R	Balancer Rail
TSLED36R	Balancer Rail
TSLED48R	Balancer Rail
TSLED24M	Magnetic
TSLED36M	Magnetic
TSLED48M	Magnetic

Steel Equipment Shelf



- Max load: 176 lbs per shelf

Part Number	W x D
TSSSES48	45.9" x 11.8" (116.5 x 30 cm)
TSSSES60	57.8" x 11.8" (146.8 x 30 cm)
TSSSES72	69.8" x 11.8" (177.3 x 30 cm)

Steel Shelf with Rear Lip



- 0° or 20° angle
- Max load: 110 lbs.

Part Number	W x D
TSSSL30	28.3" x 11.8" (71.9 x 30 cm)
TSSSL36	34.3" x 11.8" (87.1 x 30 cm)

Bin Rails



- Bins Sold Separately

Part Number	W x H
TSBR30	29.2" x 3.5" (74.2 x 8.9 cm)
TSBR36	35.2" x 3.5" (89.4 x 8.9 cm)
TSBR48	47" x 3.5" (119.4 x 8.9 cm)
TSBR60	58.9" x 3.5" (149.6 x 8.9 cm)
TSBR72	70.7" x 3.5" (179.6 x 8.9cm)

Horizontal Power Bin/Rail



- 6 outlet power

Part Number	Length
TSHPR30	30"
TSHPR36	36"
TSHPR48	48"
TSHPR60	60"
TSHPR72	72"

Vertical Power Rail



- 6 outlet power with clamp

Part Number
TSVPR

Monitor Arm



- Max Load: 33 lbs.

Part Number
TSLCDA

Footrests



Part Number	Type
TSFR	Footrest with massage roller
TSFRES	ESD Footrest with massage roller

Casters



- Set of 4 casters

Part Number	Dimensions
TSCAS	Ø 3.93" non ESD (2 - locking, 2 - non-locking)
TSCASESD	Ø 3.93" ESD (2 - locking, 2 - non-locking)

One Drawer Hanging Unit



Two Drawer Hanging Unit



Drawer/Cupboard Hanging Unit



Part Number	Dimensions	Part Number	Dimensions	Part Number	Dimensions
TSHDU-1	11.8" W x 17.9" D x 5.9" H (30 x 45.4 x 15 cm)	TSHDU-2	11.8" W x 17.9" D x 8.7" H (30 x 45.4 x 22 cm)	TSHDU-C1	13.8" W x 18.5" D x 18.5" H (35 x 47 x 47 cm)

Stacking Bins

Our stacking bins have been designed for daily use in stores, production facilities and warehouses. These bins have been designed to fit all standard shelves, paternosters and industrial workstations. Bins of the same width stack securely, even if they are of different lengths. Straight sides ensure an efficient use of space.



Stacking Bins Sets

Part Number	Description	Dimensions
TSSB4B	4 Stacking bins, blue	6.5" x 4.1" x 3" (16.5 x 10.4 x 7.6 cm)
TSSB2B2B	4 Stacking bins, blue	(2) 9.8" x 5.9" x 5.1" (24.9 x 15 x 13 cm) (2) 7.6" x 5.9" x 4.1" (19.3 x 15 x 10.4 cm)
TSSB4BESD	4 ESD Stacking bins, black	6.5" x 4.1" x 3" (16.5 x 10.4 x 7.6 cm)
TSSB2B2BESD	4 ESD Stacking bins, black	(2) 9.8" x 5.9" x 5.1" (24.9 x 15 x 13 cm) (2) 7.6" x 5.9" x 4.1" (19.3 x 15 x 10.4 cm)

Choose the right lab work surface to complete your project

We offer many work surfaces options, from **INSTOCK®** products to custom fabricated work surfaces. Our **INSTOCK®** work surfaces include epoxy resin and phenolic resin tops. These materials can also be special ordered to meet specific size and space requirements. Other materials are available for custom fabrication, including chemically resistant plastic laminate, hardwood, and stainless steel.

Work surfaces can be ordered in different depths, with special edge details, with extra high back-splashes, or a variety of cutouts. One of our Furniture Specialists are on hand to assist you in selecting the correct work surface material and style to meet your particular needs.

Most black epoxy and phenolic tops can be fabricated within 6 days after receipt of approved drawings. Complete specifications and samples of work surface materials are available from your Furniture Specialist or by request at FSLab@labbuildersinc.com. Delivery of stainless steel, laminate or hardwood tops is 7-8 weeks, after receipt of approved drawings.

Material	Appearance and Color	Composition	Chemical Resistance	Applications
Phenolic Resin	Black, hard, smooth non-glare surface	1" thick cellulose fiber reinforced phenolic resin core with a polyurethane copolymer surface.	Good chemical resistance to wide range of acids, alkalies and solvents	Use wherever a high degree of chemical resistance is required.
Epoxy Resin	Black, smooth non-porous surface	1" thick molded epoxy resin	Good resistance to practically all acids, alkalies and solvents. Highly resistant to heat and normal physical abuse.	Use wherever a high degree of chemical resistance is required.
Stainless Steel	Silver No. 4 finish	1 1/2" thick Type 304 furnished as standard, but other types are available when specified.	Good chemical resistance to a wide range of reagents	Recommended for sterile and radiological laboratories
Hardwood, Oak or Maple	Natural varnish, or penetrating oil finish	2 1/4" thick solid edge grain Maple or Oak strips, glued together electronically, and finished with baked on clear synthetic varnish or penetrating oil.	Fair chemical resistance, but not recommended for use in chemical laboratories	Excellent top material for Physics tables, Electronic benches, and other areas where mechanical or physical work levels are prevalent
High-Pressure Laminates	Hard, smooth surface available in many colors	1 1/2" plastic laminated surface attached with water resistant adhesive to solid particle board. Available in choice of colors and patterns.	Fair chemical resistance to wide range of acids, alkalies and solvents	Recommended for light duty purposes

Custom Manufactured Work Surfaces

Please note that we offer custom laboratory work surfaces in both 1" (2.5 cm) thick black epoxy resin and phenolic resin. These custom work surfaces are available for shipment within 6 business days of approved drawings. They are designed and engineered to suit your needs.



Work Surfaces without Cutouts

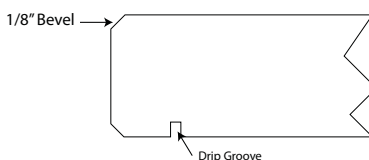
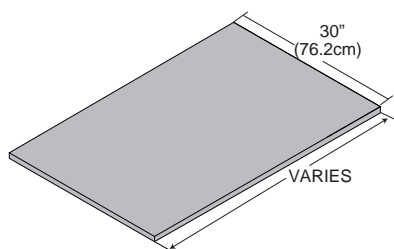

- Standard Beveled Edge Finish
- Chemical resistant black epoxy or phenolic resin
- 1" (2.5 cm) thick
- Curb must be ordered separately
- Front edge finished, all other edges are square

Work Surface Curb

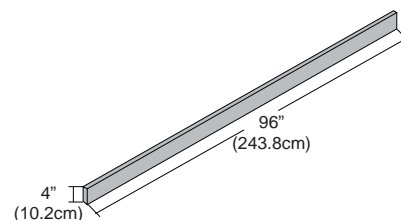

- Cut to fit at job site

Width	Depth	Epoxy Work Surface	Phenolic Work Surface	
			Black	Grey
36" (91.4 cm)	30" (76.2 cm)	TSE3630-1	TSP3630-1	TSP3630-1G
48" (121.9 cm)	30" (76.2 cm)	TSE4830-1	TSP4830-1	TSP4830-1G
60" (152.4 cm)	30" (76.2 cm)	TSE6030-1	TSP6030-1	TSP6030-1G
72" (182.9 cm)	30" (76.2 cm)	TSE7230-1	TSP7230-1	TSP7230-1G
96" W (243.8 cm)	30" (76.2 cm)	TSE9630-1	TSP9630-1	TSP9630-1G

Width	Epoxy Work Surface	Phenolic Work Surface	
		Black	Grey
96" (243.8 cm)	TSE9604-1	TSP9604-1	TSP9604-1G

Work Surface with Sink Cutout

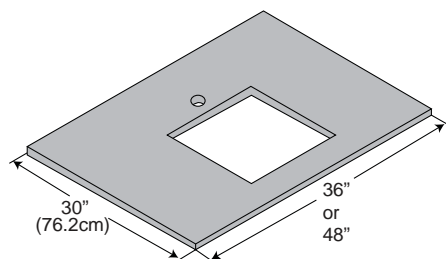

- Sink cutout 15" x 25" to receive a TS-55 drop in sink, fixture hole cutout diameter is 1 3/8"
- Sink and fixture hole are centered in width of top

Width	Epoxy Work Surface	Phenolic Work Surface	
		Black	Grey
36" (91.4 cm)	TSE3630-D55	TSP3630-D55	TSP3630-D55G
48" (121.9 cm)	TSE4830-D55	TSP4830-D55	TSP4830-D55G

End Island Sink Work Surface

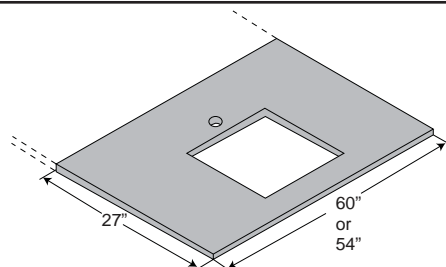

- Work Surface for end island sink cabinets
- Sink cutout 15" x 25" to receive a TS-55 drop in sink, fixture hole cutout diameter is 1 3/8"
- Sink and fixture hole are centered in width of top

Width	Epoxy Work Surface	Phenolic Work Surface	
		Black	Grey
54" (137.2 cm)	TSE5427E-D55	TSP5427E-D55	TSP5427E-D55G
60" (152.4 cm)	TSE6027E-D55	TSP6027E-D55	TSP6027E-D55G

Corner Cabinet Work Surface

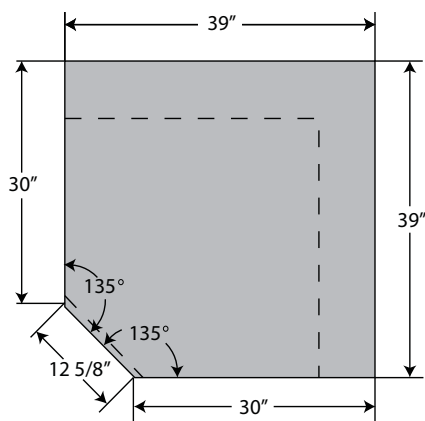

- Work surface for a corner cabinet
- Rear top over hang is 7"

Width	Epoxy Work Surface	Phenolic Work Surface	
		Black	Grey
39" (99.1 cm)	TSE37CB-1	TSP37CB-1	TSP37CB-1G

Corner Cabinet Work Surface with Sink Cutout

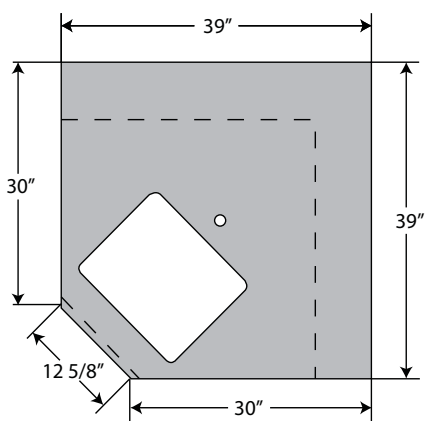

- Work surface for a corner sink cabinet
- Sink cutout 15" x 18" to receive a TS-30 sink, fixture hole diameter is 1 3/8"
- Rear top over hang is 7"

Width	Epoxy Work Surface	Phenolic Work Surface	
		Black	Grey
39" (99.1 cm)	TSE39CB-D30	TSP39CB-D30	TSP39CB-D30G

Mixing Faucets



TS412-8VB

- Deck mounted, mixing faucet with vacuum breaker
- Chrome plated brass with 8" swivel gooseneck
- Valves are self-contained units with replaceable stainless steel seats
- Four-arm handles



TS412-8

- Deck mounted, mixing faucet
- Chrome plated brass with 8" swivel gooseneck
- Valves are self-contained units with replaceable stainless steel seats
- Four-arm handles



TS412-8VB-BH

- Deck mounted, mixing faucet with vacuum breaker
- Chrome plated brass with 8" swivel gooseneck
- Valves are self-contained units with replaceable stainless steel seats
- Blade handles



TS412-8-BH

- Deck mounted, mixing faucet
- Chrome plated brass with 8" swivel gooseneck
- Valves are self-contained units with replaceable stainless steel seats
- Blade handles

Cold Water Faucets



TS611VB

- Deck mounted, cold water faucet with vacuum breaker
- Chrome plated brass with 8" swivel gooseneck
- Valves are self-contained units with replaceable stainless steel seats
- Four-arm handles



TS611-8

- Deck mounted, cold water faucet
- Chrome plated brass with 8" swivel gooseneck
- Valves are self-contained units with replaceable stainless steel seats
- Four-arm handles



TS611-8VB-BH

- Deck mounted, cold water faucet with vacuum breaker
- Chrome plated brass with 8" swivel gooseneck
- Valves are self-contained units with replaceable stainless steel seats
- Blade handles



TS611-8-BH

- Deck mounted, cold water faucet
- Chrome plated brass with 8" swivel gooseneck
- Valves are self-contained units with replaceable stainless steel seats
- Blade handles

Foot Operated Faucet

DI/RO Faucet

Aerator



TS084-8-3001-BH

- Deck mounted, mixing faucet with vacuum breaker
- Chrome plated brass with 8" swivel gooseneck
- Valves are self-closing valve units with replaceable stainless steel stems
- Floor mounted foot-operated valve



TS7833

- Deck mounted faucet for distilled, deionized or reverse osmosis water
- Exterior brass casing and interior lining of inert polypropylene
- Diaphragm-type valve
- Nylon toggle-style lever handle and combination manual/self-closing



TS0055

- 3/8" NPS male inlet
- Replaces serrated hose end on most WaterSaver faucets

Laboratory Ball Valves



- Deck mounted turret base with 1 turret
- Chrome plated brass
- Quarter-turn open/close
- Forged brass lever with color-coded index disc
- Deck mounted turret base with 2, 90 degree turrets
- Chrome plated brass
- Quarter-turn open/close
- Forged brass lever with color-coded index disc
- Deck mounted turret base with 2, 180 degree turrets
- Chrome plated brass
- Quarter-turn open/close
- Forged brass lever with color-coded index disc
- Deck mounted turret base with 4 turrets
- Chrome plated brass
- Quarter-turn open/close
- Forged brass lever with color-coded index disc

Part Number	Service	Part Number	Service	Part Number	Service	Part Number	Service
TS420-131WSA-G	Gas	TS420-132AWSA-G	Gas	TS420-132SWSA-G	Gas	TS420-134WSA-G	Gas
TS420-131WSA-A	Air	TS420-132AWSA-A	Air	TS420-132SWSA-A	Air	TS420-134WSA-A	Air
TS420-131WSA-N	Nitrogen	TS420-132AWSA-N	Nitrogen	TS420-132SWSA-N	Nitrogen	TS420-134WSA-N	Nitrogen
TS420-131WSA-V	Vacuum	TS420-132AWSA-V	Vacuum	TS420-132SWSA-V	Vacuum	TS420-134WSA-V	Vacuum

Laboratory Needle Valves



- Deck mounted turret base with 1 turret
- Straight patten forged brass
- Floating stainless steel needle and replaceable stainless steel seat
- Four-arm handle with color-coded index disc
- Deck mounted turret base with 2, 90 degree turrets
- Straight patten forged brass
- Floating stainless steel needle and replaceable stainless steel seat
- Four-arm handle with color-coded index disc
- Deck mounted turret base with 2, 180 degree turrets
- Straight patten forged brass
- Floating stainless steel needle and replaceable stainless steel seat
- Four-arm handle with color-coded index disc
- Deck mounted turret base with 4 turrets
- Straight patten forged brass
- Floating stainless steel needle and replaceable stainless steel seat
- Four-arm handle with color-coded index disc

Part Number	Service	Part Number	Service	Part Number	Service	Part Number	Service
TS288-131WSA-G	Gas	TS288-132AWSA-G	Gas	TS288-132SWSA-G	Gas	TS288-134WSA-G	Gas
TS288-131WSA-A	Air	TS288-132AWSA-A	Air	TS288-132SWSA-A	Air	TS288-134WSA-A	Air
TS288-131WSA-N	Nitrogen	TS288-132AWSA-N	Nitrogen	TS288-132SWSA-N	Nitrogen	TS288-134WSA-N	Nitrogen
TS288-131WSA-V	Vacuum	TS288-132AWSA-V	Vacuum	TS288-132SWSA-V	Vacuum	TS288-134WSA-V	Vacuum

Eyewash



- Eyewash for mounting on counter next to sink
- Swivels 90 degrees
- Water flow is activated by flag handle
- Each head has a flip dust cover
- Chrome plated brass

TS806	Right Hand Mounting
TS806LH	Left Hand Mounting



- Eyewash for mounting on counter next to sink
- Swivels 90 degrees
- Water flow is activated swinging the spray head over sink
- Each head has a flip dust cover
- Chrome plated brass

TS805	Right Hand Mounting
TS805LH	Left Hand Mounting



TS1022-BP

- Dual purpose eyewash/drench hose for deck mounting
- Water flow is activated by stainless steel lever handle
- Back flow preventer is on the inlet of the hose

Drench Shower



TS909

- Free-standing drench shower made of orange ABS plastic
- Ball valve operated by a rigid pull-rod and easy grip handle
- Eye wash fixture with stainless steel bowl, four gentle spray heads and a "Push to Operate" ball valve
- Eye wash and shower operate independently
- Overall height 80"



TS-909-ADA

- Free-standing drench shower made of orange ABS plastic
- Ball valve operated by a rigid pull rod and easy grip handle
- Eye wash fixture with stainless steel bowl, four gentle spray heads and a "Push to Operate" ball valve
- Eye wash and shower operate independently
- Overall height 80"
- ADA compliant



TS643

- Emergency shower head assembly
- Includes 10" diameter orange ABS plastic shower head
- Operated by a rigid pull-rod and easy to grip handle

Electrical



TS433SA-WS

- Single gang, double face
- 120 V/20 Amp
- Supplied with black outlets and stainless steel cover plates
- Cast aluminum boxes are powder coated with a black wrinkle epoxy finish



TS633SA-WS

- Double gang, double face
- 120 V/20 Amp
- Supplied black with outlets and stainless steel cover plates
- Cast aluminum boxes are powder coated with a black wrinkle epoxy finish



TS800SA-WS

- This electrical pedestal can accommodate a variety of styles and configurations
- As many as 8 outlets can be installed
- It's chambered design minimizes RF interference when combining electrical and data outlets in this fixture
- Outlets and cover plates supplied separately
- Cast aluminum boxes are powder coated with a black wrinkle epoxy finish

Stainless Steel Pegboard

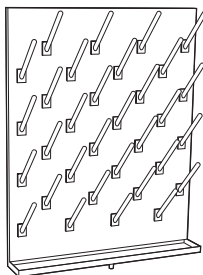

- Type 304 stainless steel pegboard with 32 1/2" diameter, 6" long white polypropylene pegs.
- Furnished with 4" wide drip trough and clear plastic drain tube

Phenolic Resin Pegboard

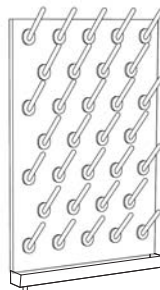

- Black phenolic pegboard with 6" long, white polypropylene pegs and finished back
- Furnished with stainless steel drip trough and clear plastic drain tube

PB-SS2430TS	24" W x 30" H (61 cm x 76.2 cm)
PB-SS3630TS	36" W x 30" H (91.4 cm x 76.2 cm)
With Finished Back	
PB-SS-2430FBTS	24" W x 30" H (61 cm x 76.2 cm)
PB-SS-3630FBTS	36" W x 30" H (91.4 cm x 76.2 cm)

PB-PR2430TS	24" W x 30" H (61 cm x 76.2 cm)
PB-PR3030TS	30" W x 30" H (76.2 cm x 76.2 cm)

Drop-In Epoxy Resin Sinks



Dimensions Key

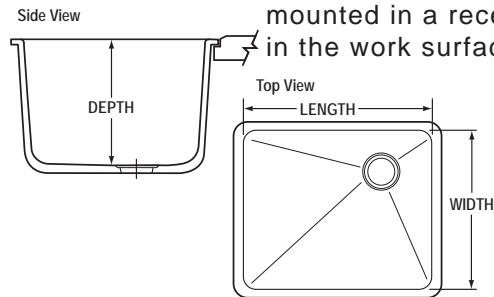

Drop in sinks are mounted in a recess in the work surface



- These durable black epoxy sinks are chemically resistant, come with coved corners and are pitched to the drain
- All tub sinks are furnished complete with a tail piece and strainer
- Drop in sinks can be converted to be undermount sinks, however cabinet sink supports will be required

Part Number	Length	Width	Depth	Outlet	Weight (lb)
TS-30	18" (45.7 cm)	15" (38.1 cm)	11" (27.9 cm)	Corner	49
TS-50	24" (61 cm)	16" (40.6 cm)	8" (20.3 cm)	Center	48
TS-55	25" (63.5 cm)	15" (38.1 cm)	10" (25.4 cm)	Corner	60
TS-59	28" (71.1 cm)	15" (38.1 cm)	11.8" (30 cm)	Corner	61
TS-U04 (Cup Style)	6" (15.2 cm)	3" (7.6 cm)	3.7" (9.4 cm)	Center	6
TS-55 (ADA Sink)	25" (63.5 cm)	15" (38.1 cm)	4.8" (12.2 cm)	Corner	47

Wall-Hung Hand Wash Sink with Sensor Operation Package



- 18 gauge, Type 304, stainless steel
- Seamless welded construction
- Underside insulated for sound and reduced condensation
- Integral stainless steel brackets and wall clip
- Sensor-operated deck mounted hand wash faucet with flow control
- Includes faucet, sensor assembly, slow closing solenoid valve
- Chrome plated drain with flat grid strainer 1-1/2" O.D. chrome plated tail piece, 4" long
- Anti-Scald mixing valve with bronze body with integral check valves and adjustment cap with locking feature
- Chrome plated cast brass 1-1/2" P-trap with clean out
- Commercial grade stainless steel soap dispenser is included

Part Number

WHHW-14TS

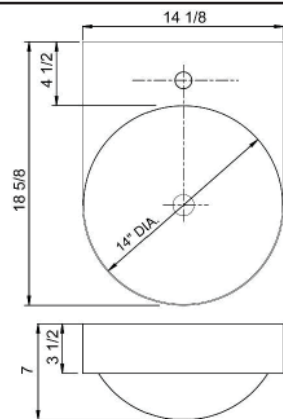

Sinks and Pegboards

Stainless Steel Sinks

Drop In Stainless Steel Single Bowl Sinks



- Seamless die-drawn construction of 18 gauge type 304 stainless steel
- Interior surfaces polished to a non-porous finish
- Fully coated underside insulated for sound and reduced condensation
- Crumb strainer included
- Self-rimming top mount Grip-Rim Plus with stainless steel mounting channels

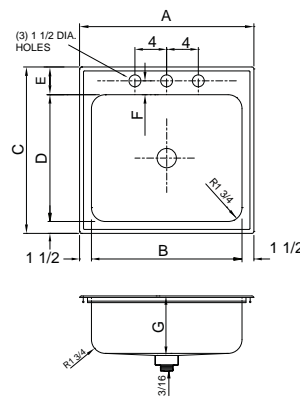

Part Number	A	B	C	D	E	F	G
DISS-15TS	15" (38.1 cm)	12" (30.5 cm)	18" (45.7 cm)	12" (30.5 cm)	4 1/2" (11.4 cm)	2" (5.1 cm)	7 1/2" (19.1 cm)
DISS-ADA-19TS (ADA style)	19" (48.3 cm)	16" (40.6 cm)	21" (53.3 cm)	16" (40.6 cm)	3 1/2" (8.9 cm)	1 3/4" (4.4 cm)	4 1/2" (11.4 cm)
DISS-22TS	22" (55.9 cm)	19" (48.3 cm)	21" (53.3 cm)	16" (40.6 cm)	3 1/2" (8.9 cm)	1 3/4" (4.4 cm)	7 1/2" (19.1 cm)
DISS-33TS	33" (83.8 cm)	28" (71.1 cm)	22" (55.9 cm)	16" (40.6 cm)	4 1/2" (11.4 cm)	2" (5.1 cm)	8" (20.3 cm)

Undermount Stainless Steel Single Bowl Sinks



- Seamless die-drawn construction of 18 gauge type 304 stainless steel
- Interior surfaces polished to a non-porous finish
- Fully coated underside insulated for sound and reduced condensation
- Crumb strainer included
- Sink supports will be required

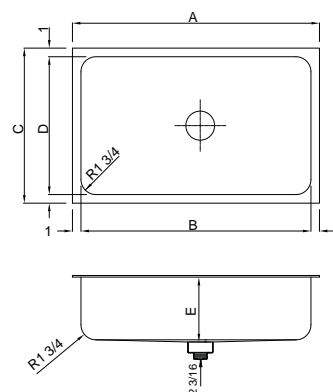

Part Number	A	B	C	D	E
USS-14TS	14" (35.6 cm)	12" (30.5 cm)	14" (35.6 cm)	12" (30.5 cm)	7 1/2" (19 cm)
USS-ADA-18TS (ADA Style)	18" (45.7 cm)	16" (40.6 cm)	18" (45.7 cm)	16" (40.6 cm)	4 1/2" (11.4 cm)
USS-21TS	21" (53.3 cm)	19" (48.3 cm)	18" (45.7 cm)	16" (40.6 cm)	7 1/2" (19 cm)
USS-30TS	30" (76.2 cm)	28" (71.1 cm)	18" (45.7 cm)	16" (40.6 cm)	8" (20.3 cm)

Undermount Stainless Steel Double Bowl Sinks



- Seamless die-drawn construction of 18 gauge type 304 stainless steel
- Interior surfaces polished to a non-porous finish
- Fully coated underside insulated for sound and reduces condensation
- 2 Crumb strainers included
- Sink supports will be required

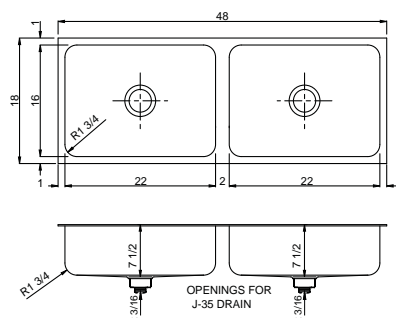

Part Number
UMSD-48TS

MVMT Pro Series



- Designed for healthcare, laboratory and clean rooms including standing work applications
- Addresses task-specific range of motion; features weight activated control lockout for precision work and many other ergonomic functions
- 20"-27" and 24"-33.5" come standard with a footring
- Image shown in Blue Grade 2 Vinyl

Height Range	Chair with only armrests	Chair with footring and armrests
17"-21" (Medium Back) (Blue Grade 2 Vinyl)	TMP-L-MB-3D-A106	-
17"-21" (Medium Back) (Black Grade 2 Vinyl)	TMP-L-MB-3D-A126	-
17"-21" (Tall Back) (Blue Grade 2 Vinyl)	TMP-L-TB-3D-A106	-
17"-21" (Tall Back) (Black Grade 2 Vinyl)	TMP-L-TB-3D-A126	-
20"-27" (Medium Back) (Blue Grade 2 Vinyl)	-	TMP-M-MB-AFP-3D-A106
20"-27" (Medium Back) (Black Grade 2 Vinyl)	-	TMP-M-MB-AFP-3D-A126
20"-27" (Tall Back) (Blue Grade 2 Vinyl)	-	TMP-M-TB-AFP-3D-A106
20"-27" (Tall Back) (Black Grade 2 Vinyl)	-	TMP-M-TB-AFP-3D-A126
24"-33.5" (Medium Back) (Blue Grade 2 Vinyl)	-	TMP-H-MB-AFP-3D-A106
24"-33.5" (Medium Back) (Black Grade 2 Vinyl)	-	TMP-H-MB-AFP-3D-A126
24"-33.5" (Tall Back) (Blue Grade 2 Vinyl)	-	TMP-H-TB-AFP-3D-A106
24"-33.5" (Tall Back) (Black Grade 2 Vinyl)	-	TMP-H-TB-AFP-3D-A126

Vacuum-Formed FC Series



- Designed for physicians, directors, patient intake and other healthcare personnel applications
- Base is reinforced composite
- Dual-wheel, non-marring polyurethane casters resist movement when the seat is unoccupied
- 17"-22" height range does not come with a footring
- 19"-26" and 22"-32" come standard with a footring
- Image shown in Slate Blue Vinyl

Height Range	Standard Part Number	Chair with armrests	Chair with footring and armrests
17"-22" (Slate Blue Vinyl)	TF-L-BLU	TF-L-ARS-BLU	-
17"-22" (Black Vinyl)	TF-L-BLK	TF-L-ARS-BLK	-
19"-26" (Slate Blue Vinyl)	TF-M-FTG-BLU	-	TF-M-FTG-ARS-BLU
19"-26" (Black Vinyl)	TF-M-FTG-BLK	-	TF-M-FTG-ARS-BLK
22"-32" (Slate Blue Vinyl)	TF-H-FTG-BLU	-	TF-H-FTG-ARS-BLU
22"-32" (Black Vinyl)	TF-H-FTG-BLK	-	TF-H-FTG-ARS-BLK

Belize B Series



- Recommended for: industry, education, laboratory, clean room, healthcare and office
- Concave seats, contoured backrests with lumbar supports
- Base is reinforced composite
- Dual-wheel, non-marring polyurethane casters resist movement when the seat is unoccupied
- 17"-22" height range does not come with a footring
- 19"-26" and 22"-32" come standard with a footring
- Image shown in Blue Grade 2 Vinyl

Height Range	Standard Part Number	Chair with armrests	Chair with footring and armrests
17"-22" (Blue Grade 2 Vinyl)	TB-L-A106	TB-L-ARS-A106	-
17"-22" (Black Grade 2 Vinyl)	TB-L-A126	TB-L-ARS-A126	-
19"-26" (Blue Grade 2 Vinyl)	TB-M-FTG-A106	-	TB-M-FTG-ARS-A106
19"-26" (Black Grade 2 Vinyl)	TB-M-FTG-A126	-	TB-M-FTG-ARS-A126
22"-32" (Blue Grade 2 Vinyl)	TB-H-FTG-A106	-	TB-H-FTG-ARS-A106
22"-32" (Black Grade 2 Vinyl)	TB-H-FTG-A126	-	TB-H-FTG-ARS-A126

ArmorSeat G Series



- This chair is the multi-purpose seating solution for almost anywhere: schools, colleges, universities, pathology, clinical labs, industry, manufacturing and hospitals
- 16"-21" height range does not come with a footring
- 18"-25" and 21"-31" come standard with a footring
- **This style does not have an armrest option**
- **This style only comes in black self-skinned urethane**

Height Range	Standard Part Number
16"-21"	TGL
18"-25"	TGMF
21"-31"	TGHF

Uniqueu U Series



- Recommended for: industry, education, laboratory, clean room and healthcare
- Molded self-skinned urethane seats and lumbar-supporting backrests are easy to wash down and resist damage from water, lubricants, chemicals, inks, paints, coatings and resins
- 16"-21" height range does not come with a footring
- 18"-25" and 21"-21" come standard with a footring
- **This style only comes in black self-skinned urethane**

Height Range	Standard Part Number	Chair with armrests	Chair with footring and armrests
16"-21"	TUL	TULR	-
18"-25"	TUMF	-	TUMFR
21"-31"	TUHF	-	TUHFR

Standing Work Seating S Series



- Recommended for: laboratories, healthcare, industry, education, retail and hospitality
- This chair features a wide, swiveling seat perched on a sturdy base inclined at 4 degrees
- Black self-skinned urethane seat

Height Range	Standard Part Number
24"-33"	TSWS

Rexford Vacuum-Formed R Series



- Recommended for: healthcare applications, exam rooms, surgical suites and recovery
- Base is reinforced composite
- Dual-wheel, non-marring polyurethane casters resist movement when the seat is unoccupied
- 17"-22" height range does not come with a footring
- 19"-26" and 22"-32" come standard with a footring
- Image shown in Slate Blue Vinyl

Height Range	Standard Part Number
17"-22" (Slate Blue Vinyl)	TR-L-BLU
17"-22" (Black Vinyl)	TR-L-BLK
19"-26" (Slate Blue Vinyl)	TR-M-FTG-BLU
19"-26" (Black Vinyl)	TR-M-FTG-BLK
22"-32" (Slate Blue Vinyl)	TR-H-FTG-BLU
22"-32" (Black Vinyl)	TR-H-FTG-BLK

Regent Vacuum Formed Series



- The addition of the streamlined backrest to this ergonomic stool makes it a comfortable option for healthcare workers
- Vacuum formed upholstery process reduces opportunity for liquid and bacterial infiltration
- Control functions include seat height, seat tilt and backrest height adjustments
- 19"-26" and 22"-32" seat height ranges come standard with adjustable footring
- Image shown in Slate Blue Vinyl

Height Range	Standard Part Number
17"-22" (Slate Blue Vinyl)	TRG-L-BLU
17"-22" (Black Vinyl)	TRG-L-BLK
19"-26" (Slate Blue Vinyl)	TRG-M-FTG-BLU
19"-26" (Black Vinyl)	TRG-M-FTG-BLK
22"-32" (Slate Blue Vinyl)	TRG-H-FTG-BLU
22"-32" (Black Vinyl)	TRG-H-FTG-BLK

Pogo RT and RX Series



Pogo RT Series

- Vertical-surface-mountable design with swing-arm provides seating option for tight spaces
- RT series model has a backrest that delivers added comfort for healthcare workers
- Vacuum formed upholstery process reduces opportunity for liquid and bacterial infiltration
- Comes standard with non-skid glide; stays put when in use, easily swings away when unoccupied
- Adjustable seat height range of 26.5"-31.75"
- Image shown in Slate Blue Vinyl

Height Range	Standard Part Number
26.5"-31.75" (Slate Blue Vinyl)	TPRT-BLU
26.5"-31.75" (Black Vinyl)	TPRT-BLK



Pogo RX Series

Height Range	Standard Part Number
26.5"-31.75" (Slate Blue Vinyl)	TPRX-BLU
26.5"-31.75" (Black Vinyl)	TPRX-BLK

Zephyr FP Series



- Provides an executive experience for managers and administrative staff
- Features a roomy nylon mesh back with adjustable lumbar support and a contoured, generously proportioned seat
- An executive style control includes seat height and tilt adjustments, backrest tilt and more
- 19"-26" comes standard with footring
- Image shown in Jodhpurs

Height Range	Standard Part Number	Chair with armrests	Chair with footring and armrests
17"-22" (Jodhpurs)	TZ-L-N420	TZ-L-ARS-N420	-
17"-22" (Galaxy Blue)	TZ-L-N509	TZ-L-ARS-N509	-
19"-26" (Jodhpurs)	TZ-M-FTG-N420	-	TZ-M-FTG-ARS-N420
19"-26" (Galaxy Blue)	TZ-M-FTG-N509	-	TZ-M-FTG-ARS-N509

Trend Series



- Full ergonomic functionality and profile provides versatility for multiple healthcare workspaces
- 21"-28" and 23"-33" height ranges come standard with footring
- Footring unavailable on low seat height range models
- Black self-skinned urethane

Height Range	Standard Part Number
18"-23"	TT-L-UR
21"-28"	TT-M-FTG-UR
23"-33"	TT-H-FTG-UR

Colors



Blue Grade 2 Vinyl
A106

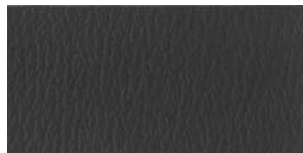

Black Grade 2 Vinyl
A126



Slate Blue Vinyl
BLU



Black Vinyl
BLK



Jodhpurs
N420



Galaxy Blue
N509

Electrical Wire Raceways



- Prewired single channel aluminum wire raceway with 5-20R, 120V, 20amp, standard or GFCI outlets.
- Includes 8' black power cord with plug as noted below
- Option to upgrade to the twist-to-lock power plug

Raceway Length	Number of Outlets	GFCI Outlets with Straight Blade Plug	GFCI Outlets with Twist-to-Lock Plug	Standard Outlet with Straight Blade Plug	Standard Outlet with Twist-To-Lock Plug
48" (121.9 cm)	2 Duplex's	TEWR48GFI-S	TEWR48GFI-T	TEWR48-S	TEWR48-T
60" (152.4 cm)	3 Duplex's	TEWR60GFI-S	TEWR60GFI-T	TEWR60-S	TEWR60-T
72" (182.9 cm)	3 Duplex's	TEWR72GFI-S	TEWR72GFI-T	TEWR72-S	TEWR72-T
84" (213.4 cm)	4 Duplex's	TEWR84GFI-S	TEWR84GFI-T	TEWR84-S	TEWR84-T
96" (243.8 cm)	4 Duplex's	TEWR96GFI-S	TEWR96GFI-T	TEWR96-S	TEWR96-T

Task Lighting - LabLight



- The LabLight is a streamline LED task light perfect for laboratory workbenches.
- The non-yellowing polycarbonate lens directs up to 95% of the illumination from white LED lamps to the work surface.
- It is made with 90% recycled materials and lasts up to 50,000 hours
- 1 3/8" wide x 7/8" tall
- Add 1 5/8" to length for each power supply
- Power connections on both ends for "daisy chaining" up to 10' of light
- When daisy chaining, at least one LabLight with a 6' power cord is required

Length	Power Supply & Magnetic Mounting Bracket	Power Supply & Screw-Mount Bracket	Daisy Chain & Magnetic Bracket	Daisy Chain & Screw-Mount Bracket
15 1/4" (37.7 cm)	TLL15-PSMM	TLL15-PSSM	TLL15-DCMM	TLL15-DCSM
27 1/4" (67.2 cm)	TLL27-PSMM	TLL27-PSSM	TLL27-DCMM	TLL27-DCSM
39 1/4" (99.7 cm)	TLL39-PSMM	TLL39-PSSM	TLL39-DCMM	TLL39-DCSM
51 1/4" (130.2 cm)	TLL51-PSMM	TLL51-PSSM	TLL51-DCMM	TLL51-DCSM
63 1/4" (160.7 cm)	TLL63-PSMM	TLL63-PSSM	TLL63-DCMM	TLL63-DCSM
75 1/4" (191.1 cm)	TLL75-PSMM	TLL75-PSSM	TLL75-DCMM	TLL75-DCSM
87 1/4" (221.6 cm)	TLL87-PSMM	TLL87-PSSM	TLL87-DCMM	TLL87-DCSM

LabLight Specifications

Operating Voltage/Frequency	110 50/60 Hz
Efficiency	75 lumens/watts
Power Consumption	2 watts/foot
Light Output	40 foot candles min. @ 21 1/2" H 150 lumens/foot
Color Temperature	ANSI C3
Environment	Indoor, Dry Locations
Operating Temperature Range	32-104°F (0-40°C)
Expected Service Life	20 years @ 50 hours/week

Mounting Options

LabLights are easily attached to metal, plastic or wood furniture. For semi-permanent mounts, for metal applications, magnetic brackets are pre-installed. For permanent mounting, screw-mount brackets can be provided, which snap into the back of the LabLight.

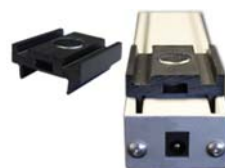

Magnetic Bracket

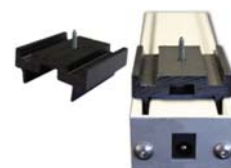

Screw-Mount Bracket

Lab Furniture Accessories

Cylinder Restraints

Chase Support Assembly

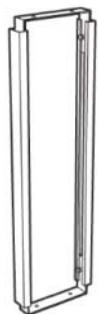

- An adjustable height floor mounted, support assembly for work surfaces as well as drain line and piping in the plumbing chase

Part Number	Dimensions
TCSA3108	27"-31" H x 8" D (68.6-78.7 x 20.3 cm)
TCSA3708	33"-37" H x 8" D (83.8-94 x 20.3cm)

Cabinet Base Molding



- Base molding
- Black PVC Vinyl
- Self-Adhesive

Part Number	Dimensions
TVBM48	4" H x 48" L (10.2 x 121.9 cm)

Wall Mounted Cylinder Restraints



- Cast aluminum, wall-mounted cylinder restraint
- Includes nylon strap and security chain
- Can be placed adjacent to each other to secure a group of cylinders

Part Number	Cylinder Diameter
TCRWM	4"-14" (10.2 x 35.6 cm)

Free Standing Cylinder Restraints



- 2" x 2" tubular steel, fully welded gas cylinder rack to be utilized for proper securing of cylinders
- Includes security chains
- TCRFM2x1 shown in image

Part Number	Number of Cylinders	Dimensions W x D x H
TCRFM2x1 (2 Cylinders x 1 bay)	2	30" x 16" x 30" (76.2 x 40.6 x 76.2 cm)
TCRFM2x2 (2 Cylinders x 2 bay)	4	30" x 32" x 30" (76.2 x 81.3 x 76.2 cm)
TCRFM2x3 (2 Cylinders x 3 bay)	6	30" x 48" x 30" (76.2 x 121.9 x 76.2 cm)
TCRFM3x1 (3 Cylinders x 1 bay)	3	45" x 16" x 30" (114.3 x 40.6 x 76.2 cm)
TCRFM3x2 (3 Cylinders x 2 bay)	6	45" x 32" x 30" (114.3 x 81.3 x 76.2 cm)
TCRFM3x3 (3 Cylinders x 3 bay)	9	45" x 48" x 30" (114.3 x 121.9x 76.2 cm)

Bio-Trapper



The Bio-Trapper is outstanding and unique for the airtight collection of a wide variety of waste or incontinence materials. The Bio-Trapper opens and closes by means of a foot pedal. Brakes are provided on 2 of the 4 swivel casters. The top of the waste collector is fitted with double hinged folding clasps that are designed for plastic waste bags noted below.

The Bio-Trapper's simple and sturdy operation mechanism ensures that the refuse bag remains hermetically sealed at all times.

Part Number	Dimensions
BIOTS	23" x 19.3" x 38.6" (585 x 490 x 980 mm)



The rubberized clamp ring is fitted with clips and stays to keep the refuse bag securely in place. So, even when the clamp ring is open, the bag will never budge.

Replacement Bags



Part Number	Dimensions W x T	Waste Type (Bag Color)
15E456TS	33" x 44" (83.8 x 111.8 cm)	General (Clear)
31DK96TS	31" x 43" (78.7 x 109.2 cm)	Infectious Linen (Yellow)
31DK98TS	31" x 43" (78.7 c 109.2 cm)	Noncontagious Linen (Blue)
31DK97TS	31" x 43" (78.7 x 109.2 cm)	Infectious Waste (Red)

What's Important for Designing a Lab Space

Your project might involve the renovation of an old lab or building a new one. Our experienced team is ready and available to help lead you through the process. The pages that follow provide an overview of this process. We are looking to help build your information base and to make your interaction with our team more productive.

Part 1 - Understand the space being considered

Survey the area being considered for the laboratory. Think of the overall amount of space that will be required for the people, process and equipment that will occupy the lab. Be careful to ensure that all the necessary utility services and sanitary or chemical drains will be available. If you'll need a fume hood, make sure you review an exit route for ducting. Always consider the future needs of your facility.

Part 2 - Select a Casework Layout

Select a casework layout that best suits your space and complies with established safety guidelines. Please pull our team in as required to help generate some sample layouts.

Part 3 - Outfitting Your Lab

Make a list of all the components your lab will need. Remember to include cabinets, countertops, fixtures, fume hoods, biological safety cabinets, cold rooms, cleanrooms, water purification systems, bench top equipment, refrigerators, seating, etc. One of our Lab Furnishing Specialists will help you complete the project planning, prepare a pricing proposal and be the one point of contact for your project through the installation process.



Laboratory Layout & Design Considerations

Following is a basic set of considerations for general laboratory layout & design. It is not intended to be a comprehensive, but it will be helpful in the review of the needs & requirements for most laboratories. This information will form a sound foundation for the interaction with our lab design team on the layout of furnishings for your lab.

1. Determine the general purpose of each lab, support or work space
 - Number of people
 - Amount of bench required per person or per operation
 - Number of fume hoods or biological safety cabinets needed
2. Confirm the rough lab spaces & sizes needed and their locations within the building
 - Review service runs required
 - Confirm the floor to deck space in the labs
 - Inspect proposed mechanical distribution and passageways
3. Engage your Environmental Health & Safety person as well as Facilities Operations & Maintenance for input
4. Develop a lab equipment listing reflecting the sizes of each piece, service requirements and respective heat loss
 - Confirm if the equipment will fit on the bench or floor. Consider your future operations.
 - All equipment should be placed into a plan view drawing to confirm fit
 - Review overall voltages and total amperage needed for the project
 - Review venting requirements, data connections, and any ancillary equipment needed
5. Examine the proposed lab layout & workflow
 - Confirm that the lab will fit the process
6. Review the need for flexible, open, lab space in the lab layout, consider future needs
7. From a historical perspective, review what's working and not working in the current lab
8. Review specific needs within the lab for:
 - Radioactive or biological materials
 - Hazardous operations
 - ADA compliance
 - Access for rolling equipment
9. Confirm the need for ancillary lab space or other space that makes the rest of the lab work more efficiently:
 - Sample receiving
 - Work in process
 - Glass wash/prep areas
 - Equipment support space
 - Offices or desk spaces
10. Examine lab storage needs
 - Supplies
 - Glassware
 - Chemicals
 - Samples
 - Receiving
11. Review hood selection and distribution in the lab
 - They should be sized to safely fit the purpose
 - Provide access for people, equipment, & process
 - Positioned correctly within the lab
 - Confirm plumbed and wired service needs
 - Confirm the HVAC requirements and the need for both supply and exhaust air systems
12. Confirm the effective separation of lab areas:
 - Lab and Office
 - Higher and Lower areas of hazard or chemical use
 - Sinks & electronics
 - Safety showers & electronics
 - Centrifuges and balances
13. Review needed availability & service distribution in the lab
 - Deck mounted pedestals
 - Wall mounted fittings
 - Overhead service panels
14. Review lab lighting & orientation for effective illumination of the work spaces
15. For sinks, review location, size, purpose & services needed
16. Confirm locations for:
 - Coat racks
 - Safety Glasses
 - Gloves
 - Shoe covers
 - Tack mats
17. Review room air changes needed within the lab and storage spaces
18. Review aisle way clearances
 - Code considerations
 - Passage of equipment
 - Avoid back to back chair arrangements
19. Confirm the placement of all lab safety fixtures and equipment
 - Eye washes
 - Safety showers
 - Fire blankets
20. Review the need for controlled access to the lab and support spaces

Developing Project Goals

Your project timeline could be as little as a few weeks to as much as a few years. We are here to help minimize this process. We can help to formulate a clear understanding of the project goals and navigate normal project pitfalls.

A Project Team Needs to be Selected

The team will need a captain to ensure that the project will run smoothly. The team should consist of the people who understand all elements of the project, from the fundamental design to how it will suit current objectives and future requirements. The team will be responsible for establishing budgets and developing schedules.

The Team Should Include:

1. Facilities Operations and Management - These are the people to help determine if the design meets facility guidelines, maintenance requirements, and available utilities.
2. The Health and Safety Officer at the facility to ensure compliance with site, state and federal safety codes and guidelines
3. Laboratory Management for the lab space
4. Individuals that will be using the lab space
5. One of our Lab Furniture Specialists

The team captain needs to organize the members and guide them on their contribution to the project. That person will document details, developments, changes, and keep the project on track.



What does your lab space look like?

Measure the room and make a rough drawing

Your lab project starts with an understanding of all room dimensions and details. We can help refine the rough initial details gathered and create an accurate drawing of the space. Pictures of the lab space can help communicate with the project team and keep a record of activity.

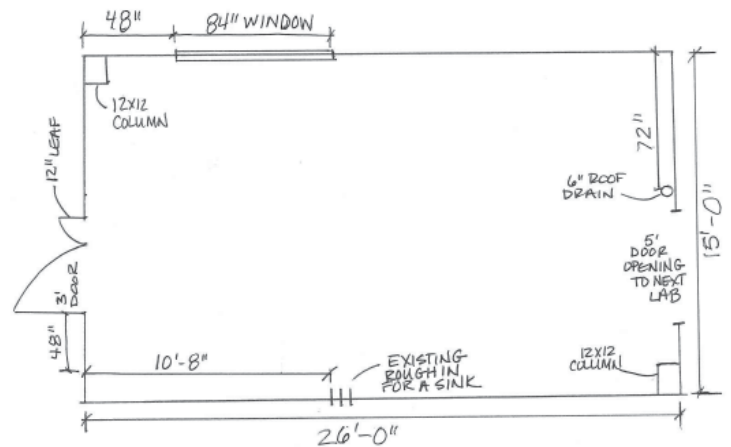

Steps

1. Measure all walls and confirm the ceiling height
2. Confirm the sizes and positions of all doors and windows. For the windows it's important to note their height off the floor
3. Measure and mark all:
 - Columns
 - Floor drains
 - Utility connections on the wall or floor
 - Other obstructions within the room

Remember, layers of information will need to be gathered on any project. A member of our CAD team can quickly take a hand sketch and create a scaled drawing for further comment or action.

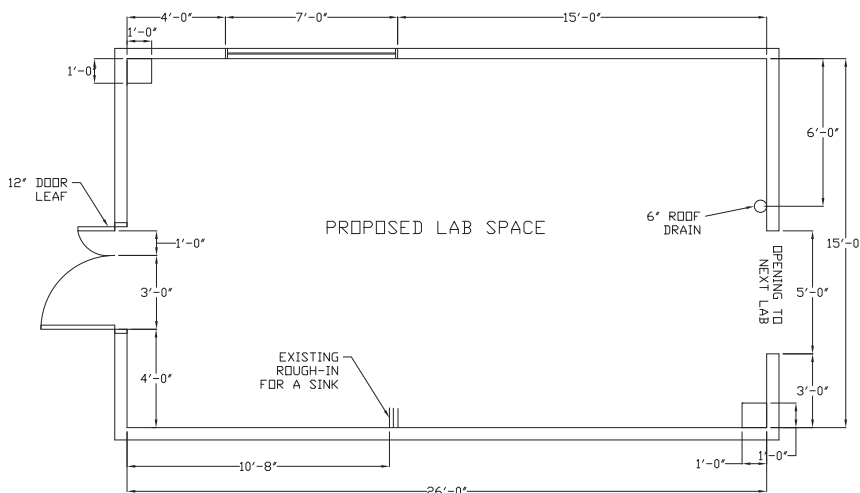

This initial drawing can now be the basis for planning and further communication. Lab furniture, equipment, electrical, plumbing among other elements can be positioned within the drawing and reviewed by the project team and one of our Furniture Specialists.

Elements of a Safe and Efficient Lab

One of our Lab Furniture Specialists is available to assist with the programming of your lab project.

Work Areas

- Provide adequate space at each bench for equipment to be placed and the process to be performed.
- Provide adequate space within the lab and between each bench for planned and future workflow and required egress and ingress.
- Consider all planned and future free standing lab equipment

Storage and Equipment Areas

- Storage and equipment areas should have appropriate ventilation and be sufficient in size
- All equipment should include a grounded plug. Review any older equipment to be used.

Chemical Storage Areas

- A chemical use assessment should be performed for the project
- Chemical storage should be secure but provide for safe and convenient retrieval
- Provide space adequate for the segregation and ventilation of chemicals
- Separate storage should be provided for flammables, acids, and corrosives

Safety Equipment

- Install eyewash stations within 10 seconds of unobstructed walking time from the location of a hazard
- Install safety showers within 10 seconds of unobstructed walking time from the location of a hazard

Services and Utilities

- A free standing and bench top equipment spreadsheet should be generated. Among other details, this spreadsheet should include information on all services required by equipment item number.
- Consideration should be given to electricity, plumbed and bottled gas, hot and cold water, and drainage required for equipment.
- Consider centralized safety and servicing shutoffs for all utilities
- Consider telephone, data and low voltage systems

Traffic Patterns and Spaces

- All rooms should have at least two forms of egress
- Minimum aisleway clearance is 42"
- Fume hoods should be located away from main traffic aisles or doorways
- Doors should be inset and open outward

Lab Ventilation

- Understand the use of all chemicals and biological elements for the lab space
- Chemical fume hoods require a supply air source and are vented to the exterior of the building
- Ventilation should be considered based upon the procedure or equipment being used
- The equipment listing mentioned in the Services and Utilities section should include the potential heat gain to the lab. This heat gain needs to be considered when sizing the HVAC system for the project
- Lab ventilation should be a minimum of 4 exchanges per hour
- Exhaust fans should be located outside and on the roof of the building

Lab Reference Sources

The references in print as well as the websites listed provide a wealth of detailed information. Whether you are building a new laboratory space or updating an old one, these references will help with developing good laboratory layouts that are safe and are compliant with regulations.

Printed Resources

American Chemical Society, Safety in Academic Chemistry Laboratories **American Chemical Society**

This guide is available from the American Chemical Society's Office of Society Services by calling 800-227-5558. (Note: Available free from ACS)

Laboratory Design Handbook

By: E. Crawley Cooper

The Laboratory Design Handbook describes the process, motivation, constraints, challenges, opportunities, and specific design data related to the creation of a modern research laboratory. The information presented is based on a large pool of experience in the development of new and renovated laboratory buildings for universities, teaching hospitals, pharmaceutical companies, start-up biotechnology companies, and other types of industrial technology. CRC Press, ISBN 9780849389962 - CAT# 8996

Prudent Practices in the Laboratory: Handling and Management of Chemical Hazards

Prudent Practices in the Laboratory has served for decades as the standard for chemical laboratory safety practice. Developed by experts from academia and industry, with specialties in such areas as chemical sciences, pollution prevention, and laboratory safety. It provides guidance on planning procedures for the handling, storage, and disposal of chemicals. Designed to promote safety and includes practical information on assessing hazards, managing chemicals, disposing of wastes.

National Academies Press, ISBN 0309138647, 9780309138642

Web Resources

Lab Planning

www.labplan.org

This website (the result of a planning study performed by the National Science Foundation) suggests a planning process and offers criteria and standards that can help determine what additional or improved facilities are needed for programs. This interactive website follows the structure of the planning process and provides the tools, guidelines, and data necessary to plan and design high school science, math, and technology education teaching spaces

Americans with Disabilities Act (ADA)

www.ada.gov

Information on the ADA including relevant publications, federal resources, ADA design standards, technical assistance program, enforcements, code certification, business connections, status reports, new and proposed regulations, and the ADA program.

Occupational Safety and Health Organization (OSHA)

www.osha.gov

Complete reference source for OSHA compliance including assistance, grants, cooperative programs, safety and health topics, statistics, US-EU cooperation, and service standards.

National Science Teacher's Association

www.nsta.org

Information provided focuses on the teaching environment, from elementary to college classrooms. Paid membership enables access to journals and books. NSTA recommendations, the latest news, conventions, supplier's guide, and discussion boards.

American National Standards Institute (ANSI)

www.ansi.org

This is a paid membership website that offers documents on laboratory ventilation (Z9.5) for both rooms and fume hoods as well as information on American National Standards including procedures, guides and forms, accreditation requirements, appeals requirements, audit requirements, and governance committees. The site also provides information on IEC programs, regional programs, ISO programs, the standards boards, and panels.

National Science Education Leadership Association

www.nsela.org

This official website of the NSELA is dedicated to providing national leadership in efforts to improve science education. The quarterly newsletter is posted along with operations manuals, by-laws, career postings, and publications.

National Fire Protection Association (NFPA)

www.nfpa.org

Website dedicated to providing research information, public education, professional development as well as fire protection information, and flammable materials storage guidelines. This paid subscriber services offers many of the NFPA codes online.

Scientific Equipment and Furniture Association (SEFA)

www.sefalabs.com

This official website for SEFA gives paying members guidelines on construction and performance of laboratory equipment and furniture. Links to member companies offering laboratory products and laboratory design are provided.



Quick Delivery Lab Furnishings



scientific