



Working with the **INSTOCK**® Lab Team is Fast and Easy



## Using this catalog

This catalog contains over 600 of the most commonly used lab furnishing products. In this catalog you will find cues to help you locate the products that you need quickly and easily.

### **Product Organization**

Catalog sections are organized by product group for easy identification.

### **Page Headings**

Sections are listed on every page for refined browsing.



# We have what you need, when you want it!

## **Table of Contents**

Painted Steel Casework	5-16
Wood Casework	18-19
Stainless Steel Casework	20-21
Phenolic Casework	22-23
Fume Hoods	24-33
Exhaust Snorkels	34-35
Shelving Systems	36-42
Patriot Tables	43-50
Heavy Duty Steel Tables	51-59
Envision Workstations	60-65
Work Surfaces	66-67
Faucets	68-70
Service Valves	71-72
Eyewash	73
Drench Shower/Eyewash Stations	74
Pegboards	75
Sinks	76-77
Electrical Pedestals	78
Seating	79-81
Lab Furniture Accessories	82-87
Lab Design Guidelines	88-95

**We have the lab furnishings you need when you want them. Our quick delivery lab furnishings program is much more than just the availability of product. Our experienced team of Furniture Specialists, Lab Designers, and Project Managers are ready & available to lead you through the completion of your fast track lab renovation, or new lab project.**

Our Furniture Team is organized into focused and coordinated units that offer:

- Clear and easy communication
- In depth planning for every kind of lab
- An extensive inventory of top-quality furniture and components
- Comprehensive project supervision from initial planning through the final installation of your project

### **Contact Us:**

1654 High Hill Road. Swedesboro, NJ 08085

**Phone:** 800-345-2100

[www.thomassci.com](http://www.thomassci.com)

## Painted Steel Casework

### CornerStone *INSTOCK*® Standard Product Features:

- Inset style casework
- Modular design allows for simple field conversion from inset to overlay, door and drawer re-configurations and hardware component changes
- Durable construction provides SEFA 8 Metal compliant load-bearing capacity for years of dependable usage
- Drawer suspension is 100 lb. full extension
- ***INSTOCK*** “Pearl White” color is a urethane powder coating that provides superior chemical and abrasion resistance
- Products are SEFA 8 tested and approved by an independent third party





# Painted Steel Casework

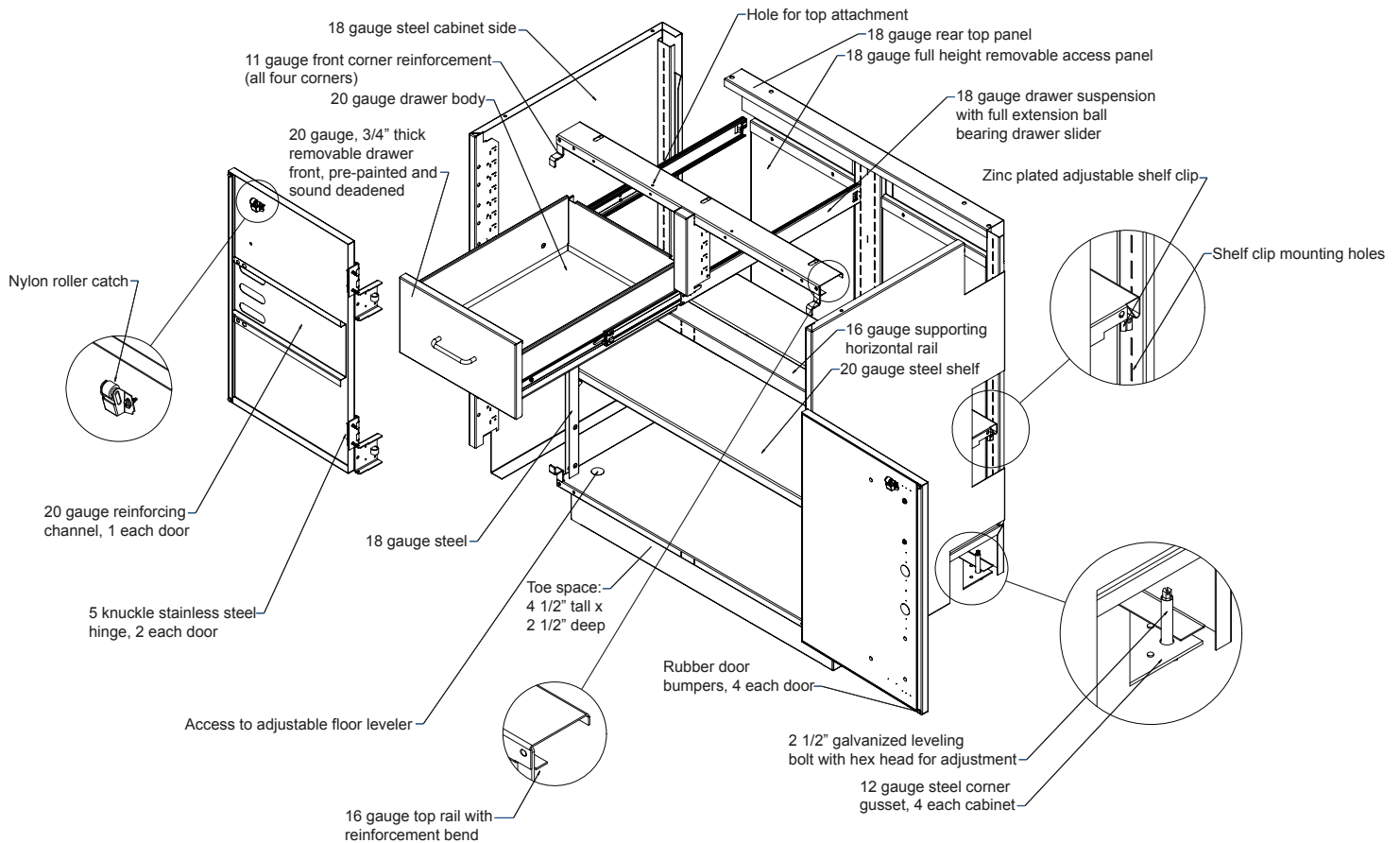

## Design Appearance:

- Our quick delivery cabinetry is offered in a flush inset style. All cabinet component parts of the unit are manufactured ensuring uniformity, interchangeability and accurate alignment.

## Color:

- Our quick delivery cabinetry is offered in a neutral color of Pearl White

## Field Convertible:

- Field convertible design allows for conversion of cabinet door and drawer front styles, drawer body suspension and cabinet horizontal and vertical rails, with the use of simple hand tools.

## LEED Compliance:

- Environmental compliant paints, glues and adhesives are specifically formulated to safeguard indoor air quality

## Industry Compliance:

- SEFA 8 Metal, NFPA 30, UL listed and FM approved

## Drawer Slide:

- 100 lbs. full extension, Standard

## Standard Features:

- Stainless Steel Wire Pull
- Stainless Steel Five Knuckle Hinge
- Nylon Roller Door Catch

## CornerStone Door and Drawer Size Code

Mod Code	Height
<b>Drawers</b>	
3M	3.649" (9.3 cm)
4M	4.909" (12.5 cm)
6M	7.429" (18.9 cm)
8M	9.949" (25.3 cm)
9M	11.209" (28.5 cm)
10M	12.469" (31.7 cm)
<b>Doors</b>	
15M	18.769" (47.7 cm)
18M	22.549" (57.3 cm)
20M	25.069" (63.7 cm)
22M	27.589" (70.1 cm)
24M	30.109" (76.5 cm)
28M	35.149" (89.3 cm)
37M	47.749" (121.3 cm)
63M	79.249" (201.3 cm)

## Painted Steel Casework

### INSTOCK® Steel Laboratory Casework

The **INSTOCK** program is ready when you are and is designed to ship complete laboratories within 10 days.

Our **INSTOCK** program provides you an extensive selection of lab furnishings that are available in a matter of days.\*

All **INSTOCK** steel cabinets and chemical hoods have a powder coated “Pearl White” finish that is SEFA 8 compliant.\*\* A wide range of other colors and cabinet styles are available in 6-8 weeks.



\*Most **INSTOCK**® items ship in 10 days. All items are subject to availability at the time of the order. Large quantity orders may require longer lead times.

\*\*For a color sample of Pearl White email: [orders@instocklabs.com](mailto:orders@instocklabs.com)

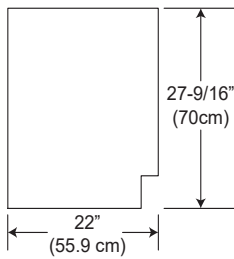

## Door Cabinets

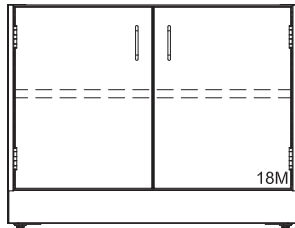

TSJTP163-36 36" W (91.4 cm)

## CornerStone Sitting Height Base Cabinet

- Order work surfaces separately
- Provided without locks
- 27 9/16" (70 cm) Tall
- Standard Color: Pearl White
- All door and combination cabinets have a removable back
- All drawer cabinets have a cutout for service access

## Drawer Cabinets

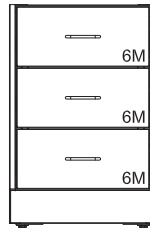

TSJTP174-18P 18" W (45.7 cm)

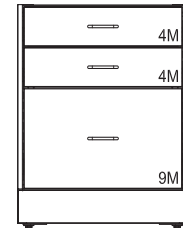

TSJTP070-24P 24" W (61 cm)

## Door and Drawer Cabinets

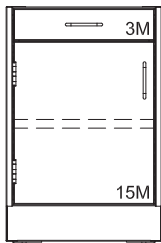

### Left Hinged

TSJTP169-18P 18" W (45.7 cm)

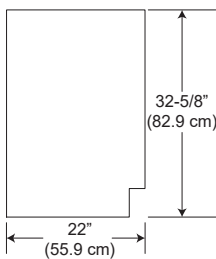

## Drawer Cabinets

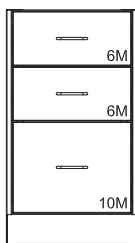

TSJTP925-18P 18" W (45.7 cm)

## CornerStone ADA Height Base Cabinet

- Order work surfaces separately
- Provided without locks
- 32 5/8" (82.9 cm) Tall
- Standard Color: Pearl White
- All door and combination cabinets have a removable back
- All drawer cabinets have a cutout for service access

## Sink Cabinet

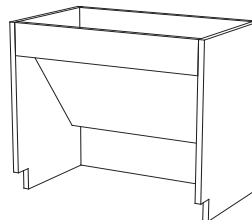

Assembly Required

TSJTP981ACC-36 36" W (91.4 cm)



# Painted Steel Casework

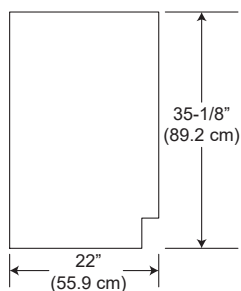

## CornerStone Standing Height Base Cabinet

- Order work surfaces separately
- Provided without locks
- 35 1/8" (89.2 cm) Tall
- Standard Color: Pearl White
- All door and combination cabinets have a removable back
- All drawer cabinets have a cutout for service access

## Door Cabinets

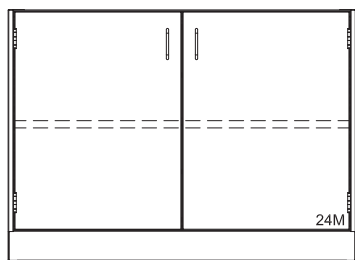

TSJTP103-30	30" W (76.2 cm)
TSJTP103-36	36" W (91.4 cm)
TSJTP103-48	48" W (121.9 cm)

## Drawer Cabinets

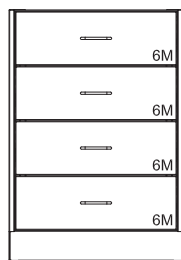

TSJTP122-18P	18" W (45.7 cm)
TSJTP122-24P	24" W (61 cm)

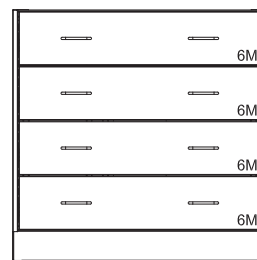

TSJTP121-36P	36" W (91.4 cm)
--------------	-----------------

## Drawer Cabinets

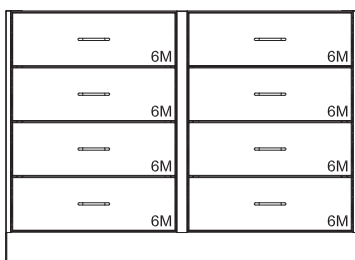

TSJTP124-48P	48" W (121.9 cm)
--------------	------------------

## Door/Drawer Cabinets

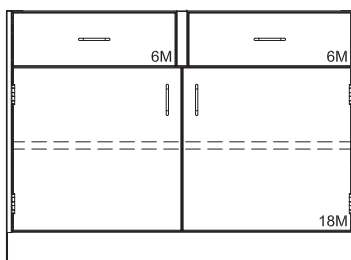

TSJTP106-36P	36" W (91.4 cm)
TSJTP106-42P	42" W (106.7 cm)
TSJTP106-48P	48" W (121.9 cm)

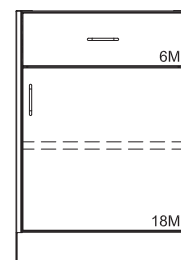

## Corner/Sink Cabinet

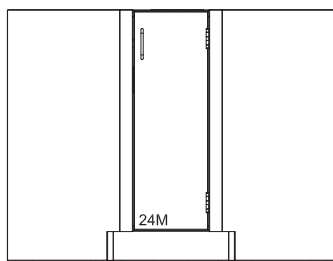

### Right Hinged

TSJTP118-18P	18" W (45.7 cm)
TSJTP118-24P	24" W (61 cm)

### Left Hinged

TSJTP119-18P	18" W (45.7 cm)
TSJTP119-24P	24" W (61 cm)

### Right Hinged

TSJTP190-32SE	32-7/8" W (83.5 cm)
---------------	---------------------

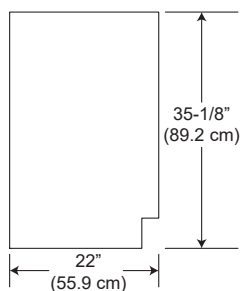

## CornerStone Standing Height Base Cabinet

- Order work surfaces separately
- Provided without locks
- 35 1/8" (89.2 cm) Tall
- Standard Color: Pearl White
- All door and combination cabinets have a removable back
- All drawer cabinets have a cutout for service access

## Sink Cabinets

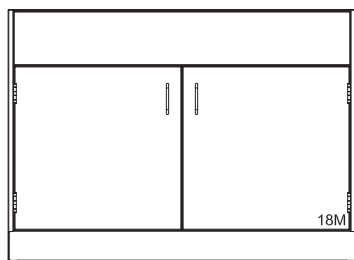

TSJTP181-36	36" W (91.4 cm)
TSJTP181-48	48" W (121.9 cm)

## End Island Sink Cabinets

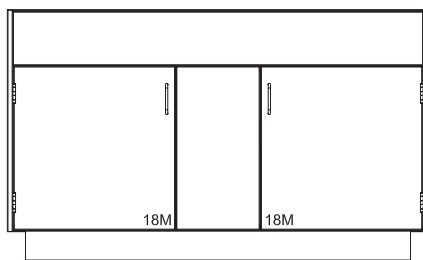

TSJTP186-52	52" W (132.1 cm)
TSJTP186-58	58" W (147.3 cm)

## Sink Supports



TSJP535-36	36" W (91.4 cm)
TSJP535-48	48" W (121.9 cm)
TSJP535-52	52" W (132.1 cm)
TSJP535-58	58" W (147.3 cm)

## Acid Storage Cabinets

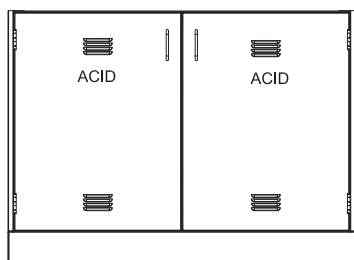

- Full-Height doors are lined with 1/8" thick polyethylene
- Chemical resistant 3/16" thick molded Polyethylene lining with coved corners and 2" lip at front of cabinet opening
- Includes vent kit
- One half-depth shelf

TSJTP185-24GG (Left Hinged)	24" W (61 cm)
TSJTP188-36GG	36" W (91.4 cm)
TSJTP188-48GG	48" W (121.9 cm)

## Solvent Storage Cabinets

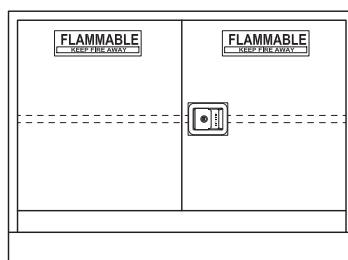

- Construction meets requirements listed by UFC, OSHA, and NFPA No. 30-1993
- Two 2" pipe threaded vent outlets on back
- Rear and top access panels
- Lock is included
- Self-closing

TSJTP189-24SLAS (Right Hinged)	24" W (61 cm)
TSJTP18936SLASY	36" W (91.4 cm)
TSJTP18948SLASY	48" W (121.9 cm)

## Standard Hood Cabinets

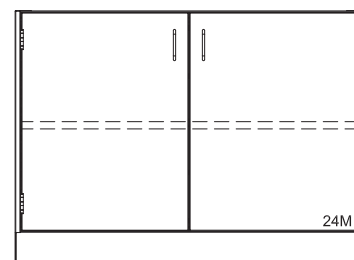

TSJTP103-30	30" W (76.2 cm)
TSJTP103-36	36" W (91.4 cm)
TSJTP103-48	48" W (121.9 cm)

# Painted Steel Casework

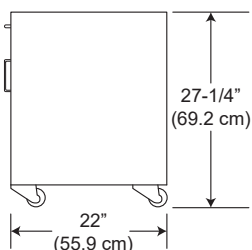

## CornerStone Mobile Cabinet

- Order work surfaces separately
- Provided without locks
- 27 1/4" Tall and 22" Deep
- Standard Color: Pearl White
- Cabinets include 4 each heavy duty 3" casters, the front 2 casters are locking
- Drawer interlock system included and counter weighted anti-tip design.

## Combination Cabinets

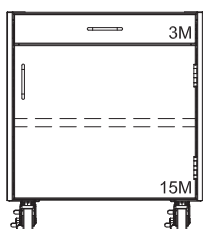

## Drawer Cabinets

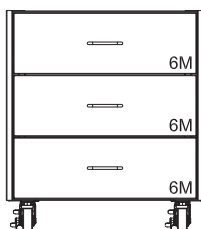

Right Hinged	
TSJTP1068-18	18" W (45.7 cm)
TSJTP1068-24	24" W (61 cm)

TSJTP1072-18	18" W (45.7 cm)
TSJTP1072-24	24" W (61 cm)

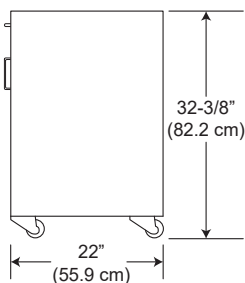

## CornerStone Mobile Cabinet

- Order work surfaces separately
- Provided without locks
- 32 3/8" Tall and 22" Deep
- Standard Color: Pearl White
- Cabinets include 4 each heavy duty 3" casters, the front 2 casters are locking
- Drawer interlock system included and counter weighted anti-tip design.

## Combination Cabinets

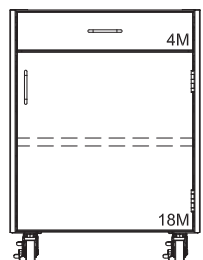

## Drawer Cabinets

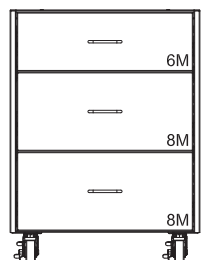

Right Hinged	
TSJTP1018-18	18" W (45.7 cm)
TSJTP1018-24	24" W (61 cm)

TSJTP1021-18	18" W (45.7 cm)
TSJTP1021-24	24" W (61 cm)



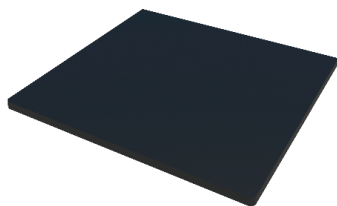

## Mobile Cabinet Work Surface

- Work surface is 3/4" thick black phenolic resin that provide a 1" overhang on the front and a 1/2" overhang at the rear and sides.
- It adds 3/4" to the overall height of the cabinet.
- There is a grip notch included under the front edge of the work surface to help maneuver cabinet

Part Number	For use with:
TSMWS-18	18" (45.7 cm) wide mobile cabinet
TSMWS-24	24" (61 cm) wide mobile cabinet

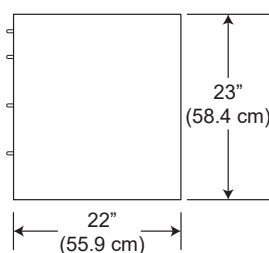

## CornerStone Suspended Cabinet

- 23" Tall and 22" Deep
- Standard Color: Pearl White
- Designed to be hung from any of our table systems
- Each suspended cabinet is furnished with complete hanging hardware.

## Drawer Cabinets

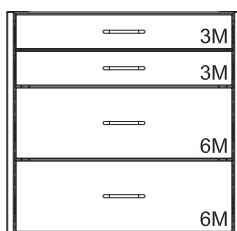

TSJTP820-18	18" W (45.7 cm)
TSJTP820-24	24" W (61 cm)

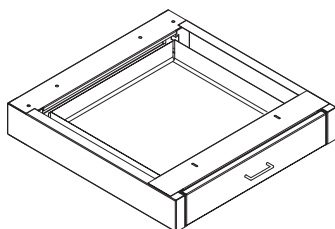

TSPPD1822	18" W (45.7 cm)
-----------	-----------------

## CornerStone Suspended Pencil Drawer

- 3 7/8" Tall and 22" Deep
- Standard Color: Pearl White
- Designed to be hung from any of our table systems
- Each suspended cabinet is furnished with complete hanging hardware.

# Painted Steel Casework

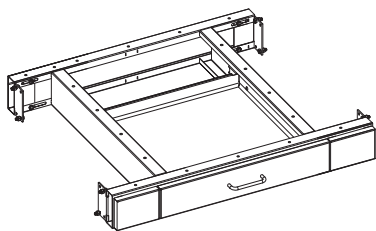

## CornerStone Apron Frame with Drawer

- Apron frame is 4" (11.4 cm) tall
- Use to span knee space area between two cabinets
- Attachment hardware included
- Standard color: Pearl White

Part Number	Width	Depth
TSJTPTBA3022-1P	30" (76.2 cm)	22" (55.9 cm)
TSJTPTBA3622-1P	36" (91.4 cm)	22" (55.9 cm)

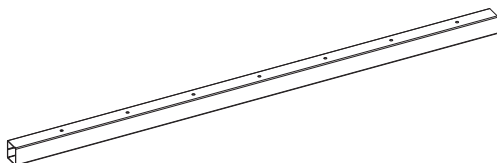

## CornerStone Apron Rail

- Apron rails are 2" tall and 2" deep
- Used to span and support knee space areas between two cabinets
- Attachment hardware is included
- Standard color: Pearl White
- Can be cut to fit in the field

Part Number	Width
TSJPTBR-3002	30" (76.2 cm)
TSJPTBR-3602	36" (91.4 cm)
TSJPTBR-4802	48" (121.9 cm)
TSJPTBR-7202	72" (182.9 cm)

## Example use of Rails

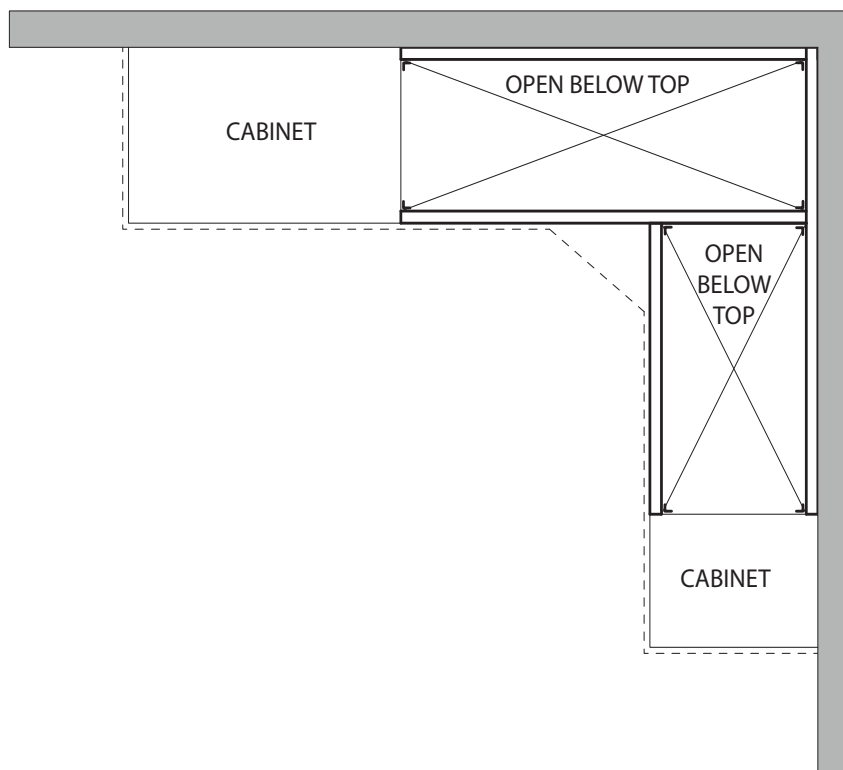

## Panel End Supports

- Use in place of a cabinet at one end of a cabinet run to support drawer frames or apron rails
- Can be used to support the intersection of two aprons or rails
- Each panel has 2 leveling feet and is 2" (5.1 cm) wide
- Standard Color: Pearl White

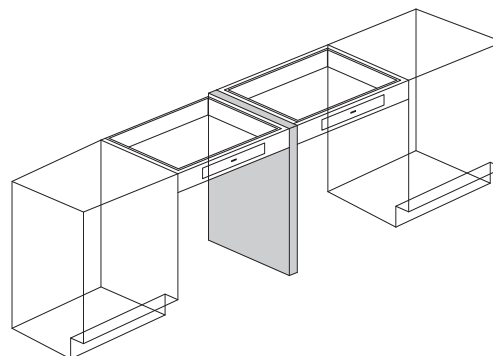
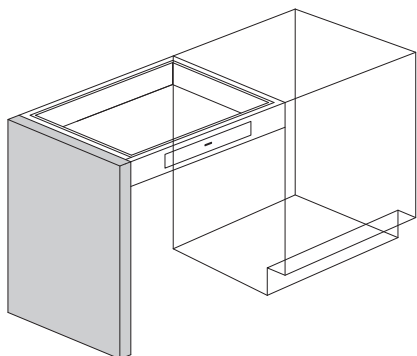

Part Number	Depth	Height
<b>Sitting Height</b>		
TSJPTPO-2822	22" (55.9 cm)	27 9/16" (70 cm)
<b>ADA Height</b>		
TSJPTPO-3222	22" (55.9 cm)	32 5/8" (82.8 cm)
<b>Standing Height</b>		
TSJPTPO-3522	22" (55.9 cm)	35 1/8" (89.2 cm)

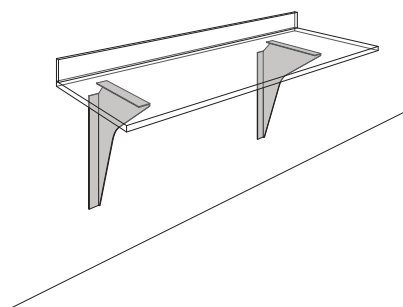

## Heavy Duty Wall Mount Bracket Countertop Support

- Used to support spans of work surface without structure mounted on the floor
- Adequate in-wall blocking is required.
- 11 gauge bracket has a 2" wide return flanges with mounting holes at the top and rear of the bracket
- Bracket is 24" tall and can be mounted at any chosen height
- Standard color: Pearl White

Part Number	Depth
TSFF-CTOP-18	18" (45.7 cm)
TSFF-CTOP-23	23" (58.4 cm)



# Painted Steel Casework

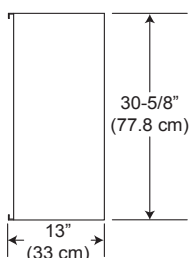

## CornerStone Wall Cabinets

- Provided without locks
- 30 5/8" (77.8 cm) Tall x 13" (33 cm) Deep
- Standard Color: Pearl White
- Two adjustable shelves
- Flush Bottom

## Solid Door Wall Cabinets

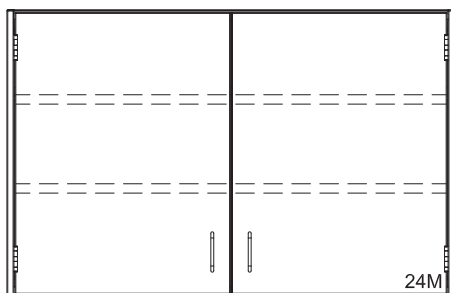

TSJTP203-36	36" W (91.4 cm)
TSJTP203-48	48" W (121.9 cm)

## Framed Glass Wall Cabinets

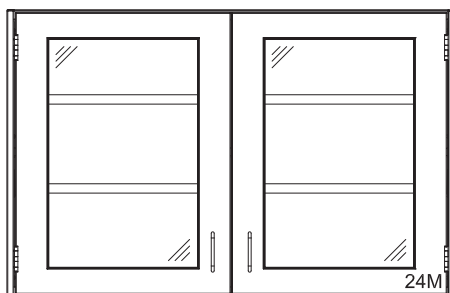

TSJTP206-36	36" W (91.4 cm)
TSJTP206-48	48" W (121.9 cm)

## Rear Wall Cabinet Filler

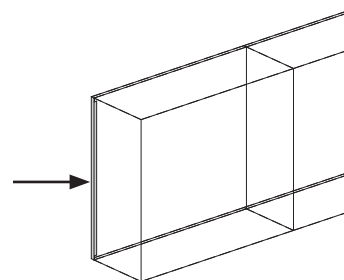

TSJC1392N0124P
----------------

## CornerStone Steel Solid Door Tall Cabinet

- Standard with locks
- Five shelves are included and are adjustable in half-inch increments
- Must be anchored to wall
- 84-5/16" Tall x 22" Deep
- Standard Color: Pearl White

## Solid Door Tall Cabinets

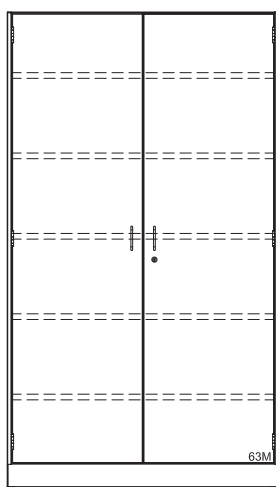

TSJTP303-36L	36" W (91.4 cm)
TSJTP303-48L	48" W (121.9 cm)

## CornerStone Steel Glass Door Tall Cabinet

- Standard with locks
- Five shelves are included and are adjustable in half-inch increments
- Must be anchored to wall
- 84-5/16" Tall x 22" Deep
- Standard Color: Pearl White

## Framed Glass Door Tall Cabinets

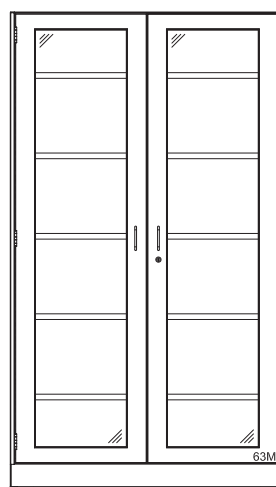

TSJTP307-36L	36" W (91.4 cm)
TSJTP307-48L	48" W (121.9 cm)

## Knee Space Panels for use with Drawer Aprons

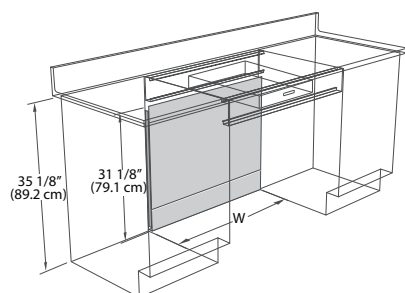

Part Number	Width
Standing Height	
TSJKSH-3004GG	30" (76.2 cm)
TSJKSH-3604GG	36" (91.4 cm)

## Knee Space Panels for use with 2" High Apron Rails

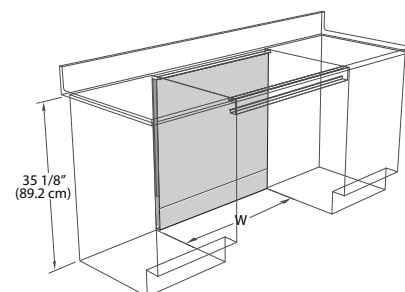
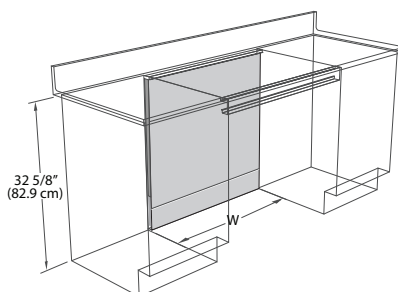
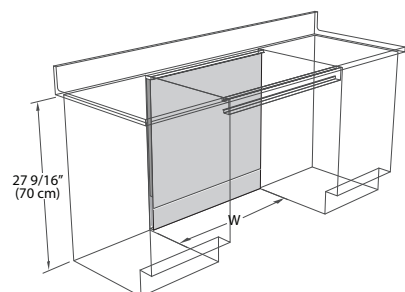

Part Number	Width
Sitting Height	
TSJKSL-ADJGG*	ADJUSTABLE 12"-48" (30.5 - 121.9 cm)

Part Number	Width
ADA Height	
TSJKSA-ADJGG*	ADJUSTABLE 12"-48" (30.5 - 121.9 cm)

Part Number	Width
Standing Height	
TSJKSH-30GG	30" (76.2 cm)
TSJKSH-36GG	36" (91.4 cm)
TSJKSH-ADJGG*	ADJUSTABLE 12"-48" (30.5 - 121.9 cm)
TSJKSH-72ADJGG*	ADJUSTABLE 12"-72" (30.5 - 182.9 cm)

\* Cut to fit and includes slip fit trim angle

# Painted Steel Casework

## Corner Fillers

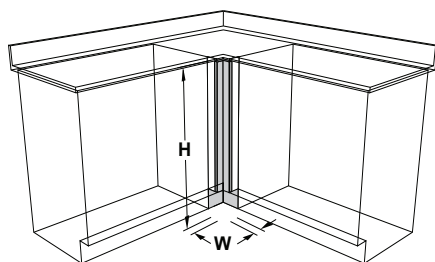

Part Number	Width
<b>Standing Height - 35 1/8"</b>	
TSJFCH-01	1" (2.5 cm)
TSJFCH-ADJ*	ADJUSTABLE 2"-12" (5.1 - 30.5 cm)

\* Cut to fit and includes slip fit trim angle

## Front Fillers Panels

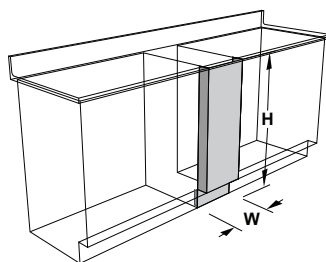

- For use between adjacent base cabinets or between a cabinet and the wall

Part Number	Width
<b>Sitting Height - 27 9/16"</b>	
TSJFFL-ADJ*	2"-18" (5.1 - 45.7 cm)
<b>Standing Height - 35 1/8"</b>	
TSJFFH-01	1" (2.5 cm)
TSJFFH-04	4" (10.2 cm)
TSJFFH-08	8" (20.3 cm)
TSJFFH-ADJ*	2"-18" (5.1 - 45.7 cm)

## Rear and Center Fillers Panels

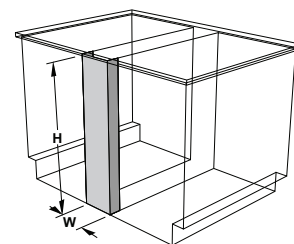

- For use between back-to-back base cabinets or to close space at the rear of the cabinet

Part Number	Width
<b>Sitting Height - 27 9/16"</b>	
TSJFRL-07	7" (18.7 cm)
<b>ADA Height - 32 5/8"</b>	
TSJFRA-07	7" (18.7 cm)
<b>Standing Height - 35 1/8"</b>	
TSJFRH-01	1" (3.5 cm)
TSJFRH-07	7" (18.7 cm)
TSJFRH-08	8" (21.3 cm)
TSJFRH-14	14" (36.5 cm)
TSJFRH-ADJ*	2" - 18" (5.1 - 45.7 cm)

## Pipe Enclosures - Steel

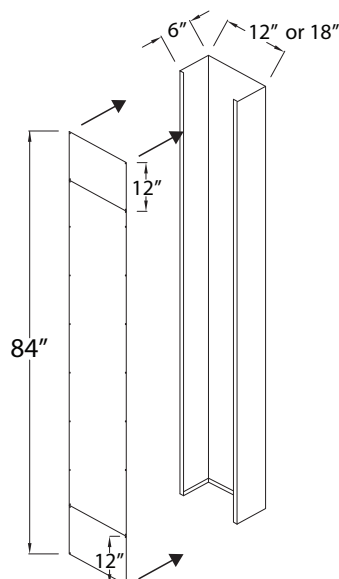

- Used to provide a cover for pipes running from the ceiling to the work surface
- Can be used for island or perimeter locations
- Can support pegboards or water purification systems
- Cover is pre-punched for attachment and is furnished in three sections for ease of access after installation

Part Number	Dimensions (W x D x H)
TSJP509-1284	12" x 6" x 84" (30.5 x 15.2 x 212.1 cm)
TSJP509-1884	18" x 6" x 84" (45.7 x 15.2 x 212.1 cm)



## Adaptable Furniture Systems



When laying out your laboratory space, thought should be given to its future use, the changing needs of the occupants, their procedures & equipment. Adaptable lab furnishings have become an integral part of contemporary project layouts. Our lab table systems are designed and built to provide adaptability & sustainability. Our systems driven approach provides a family of products that work together as your lab grows or your needs change. We provide a fast, reliable, and value driven method to lab upfit and flexibility.

**See page 43 for our Table Systems**



## Premier Wood Cabinets



ICI Scientific's University and Research wood laboratory cabinets are made from hand selected premium rift cut oak grade A veneers, featuring a solid mortise/tenon top frame, doweled, glued and screwed European construction. Robotically applied environmental finishes are chemically resistant resulting in beautiful board room quality furniture. Cabinets are stained inside and out allowing for relocation during laboratory renovations. Drawer glides are full extension heavy duty designed for commercial/ industrial applications. Cabinet pulls and hinges are laboratory grade stainless steel. ICI's wood laboratory furniture has been independently tested and is SEFA 8 compliant. All of our products are supported by a 3 year warranty. We bring quality, warmth and durability to your laboratory. All wood laboratory cabinets come in ICI's chemically resistant "Amber" finish.

**Please contact your Furniture Specialist for current lead times, as they vary per season.**

Our complete program includes: Maples, Oaks, Cherry, Bamboo, European Steamed Beech, American White Ash, or other Exotic Species. Also, select from Seven Premier Finishes or a customized one to suit your project.

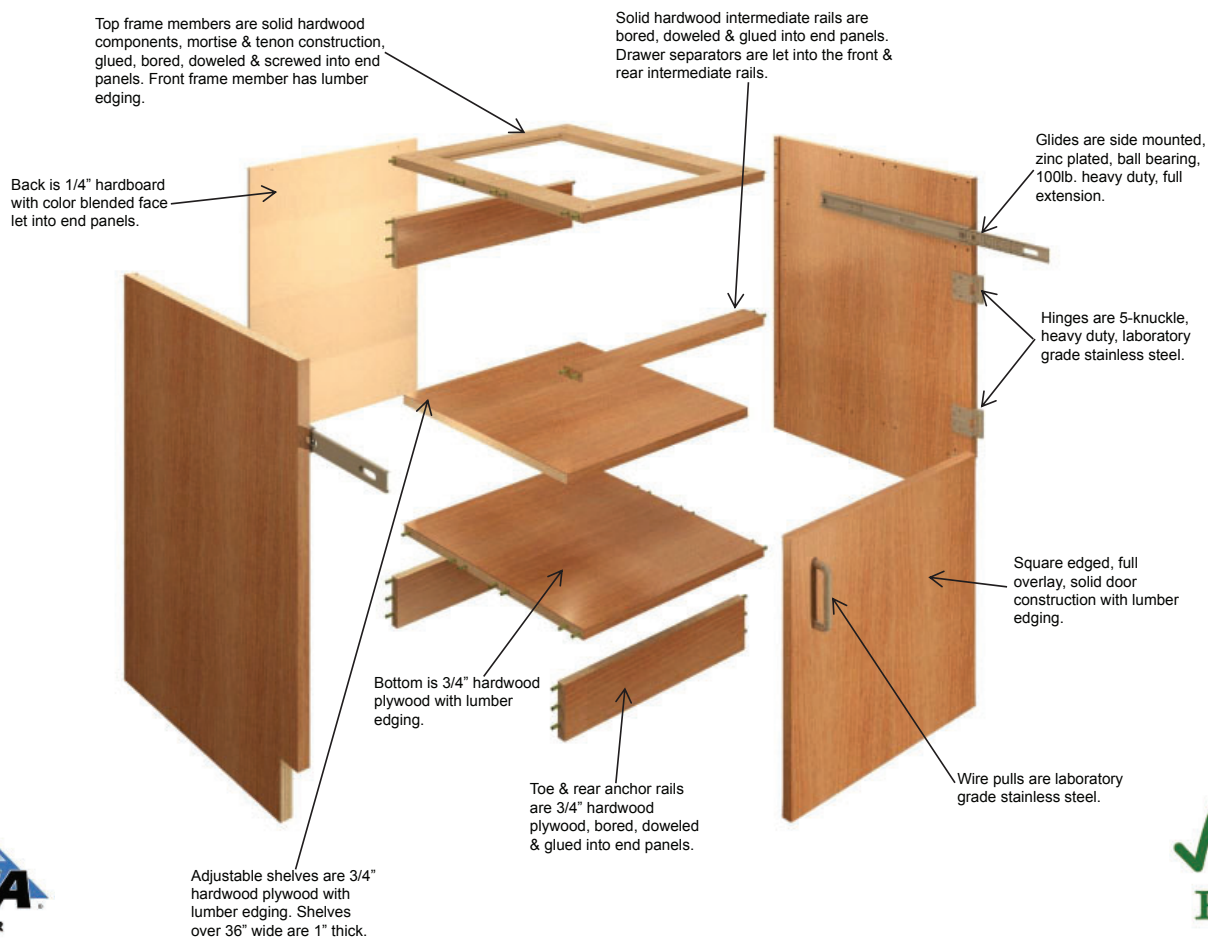

ICI Scientific reserves the right to change or modify our construction detail without notice.



## Stainless Steel Casework

Stainless steel furnishings are designed specifically for research and healthcare laboratories. Stainless steel counter tops and wash areas are also available for labs requiring sanitation and sterilization. Standard construction is a Type-304 stainless with a #4 finish. Our stainless steel cabinets have the same construction detail as our painted steel cabinets. Type-316 stainless cabinet construction is also available. Contact your Furniture Specialist for more information. Lead time is 6-8 weeks.





## Stainless Steel Casework

### Design Appearance:

- Our cabinetry is offered in a flush inset style. All cabinet component parts are of the sectional units are manufactured ensuring uniformity, interchangeability, and accurate alignment.

**Color:**

- Our stainless steel cabinet is Type #304 stainless steel with at #4 finish

### Field Convertible:

- Field convertible design allows for conversion of cabinet door and drawer front styles, drawer body suspension and cabinet horizontal and vertical rails, with the use of simple hand tools.

## LEED Compliance:

- Environmentally compliant paints, glues and adhesives are specifically formulated to safeguard indoor air quality

### Industry Compliance:

- SEFA 8 Metal, NFPA 30, UL listed

### Drawer Slide:

- 100 lbs. full extension, Standard

### Standard Features:

- Stainless Steel Wire Pull
- Stainless Steel Five Knuckle Hinge
- Nylon Roller Door Catch

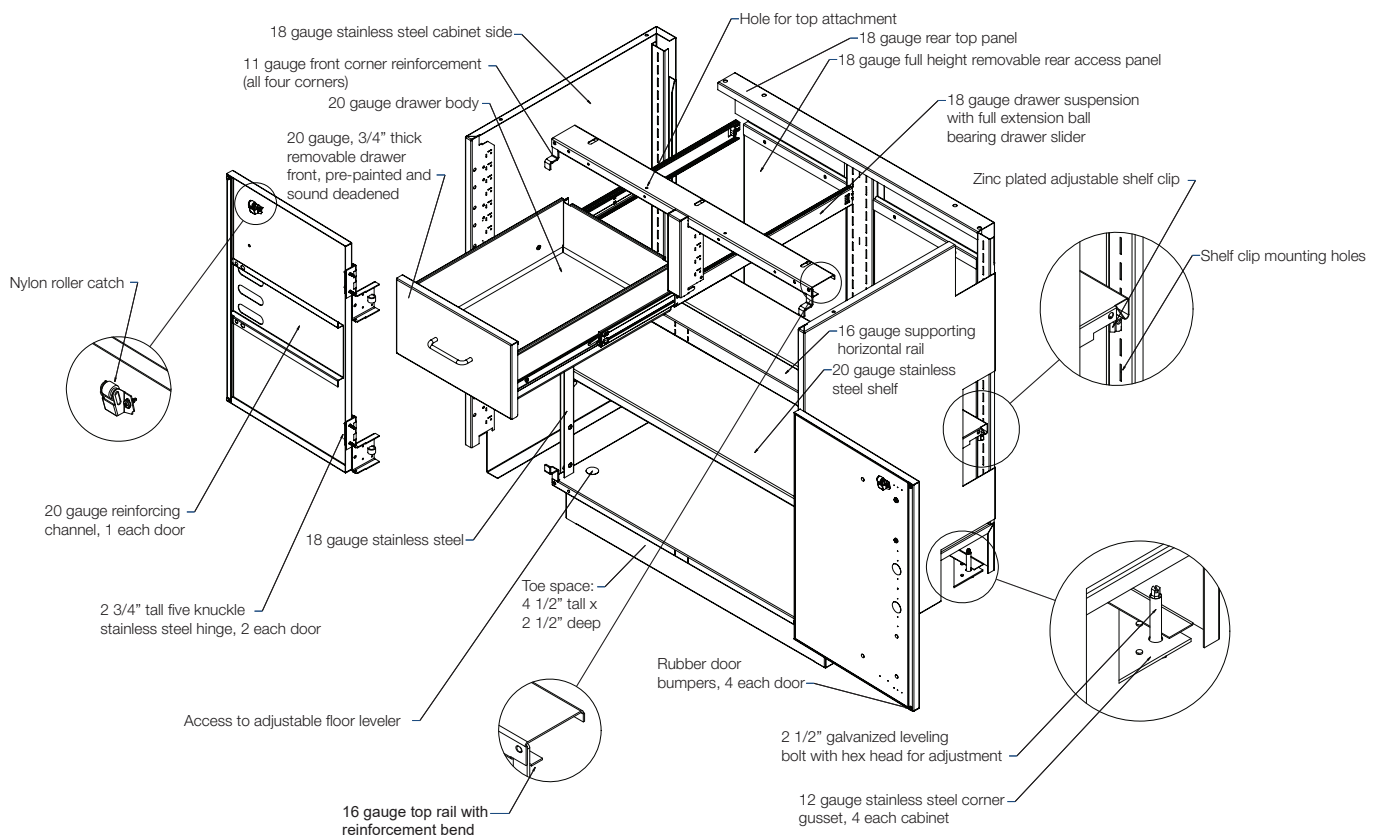

## Phenolic Casework

Phenolic resin casework is designed for rugged use in wet areas where corrosion or rust are of concern. Cabinets will not absorb odors, are easy to clean, and are virtually maintenance free. Any of our work surfaces, including stainless steel, can be combined with these cabinets to provide a complete laboratory solution. Standard cabinet construction is from 1/2" thick chemically resistant phenolic panels in a full overlay style. All colors have a solid black core. Contact your Furniture specialist for assistance. Lead time is 8 weeks.



**Design Appearance:**

- Our phenolic cabinetry is made with impact resistant door and drawers.

**Color:**

- There is a wide selection of colors available. All colors have a black core.

**Drawer Slide:**

- 100 lbs. full extension, Standard

**Standard Features:**

- Stainless Steel Wire Pull
- Stainless Steel Five Knuckle Hinge
- Rust, rot and mold resistant construction
- Removable back for easy access to service chase

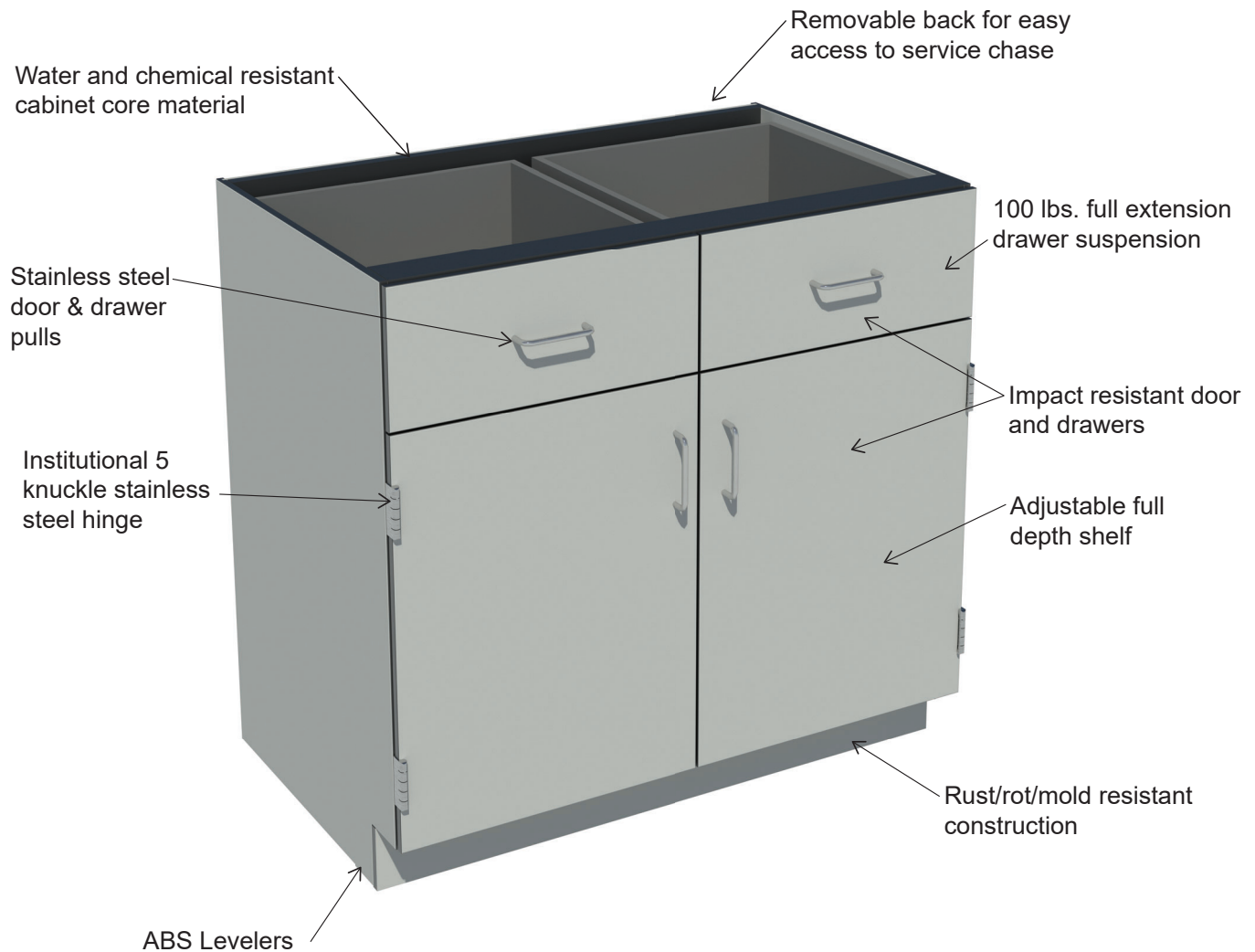



## Fume Hoods

### Hood Design Options to Fit Any Need with Unlimited Customization

**ICI Scientific provides chemical fume hoods with exceptional safety, function, style & adaptability.**

Our complete fume hood offering includes:

- True One Finger Sash Operation
- Easy Maintenance & Long Product Life Cycle
- Traditional Constant Volume
- ADA Accessible
- Full Access Walk-in
- Isotope
- Perchloric Acid
- UL 1805 Listed
- 3-Year Warranty
- CAV, VAV & High Performance Hoods Available
- Distillation
- Demonstration
- Double Sided
- Teaching
- Custom Enclosures
- Lifetime Warranty on Chain & Sprocket Sash Mechanism



## Selecting a Complete Fume Hood

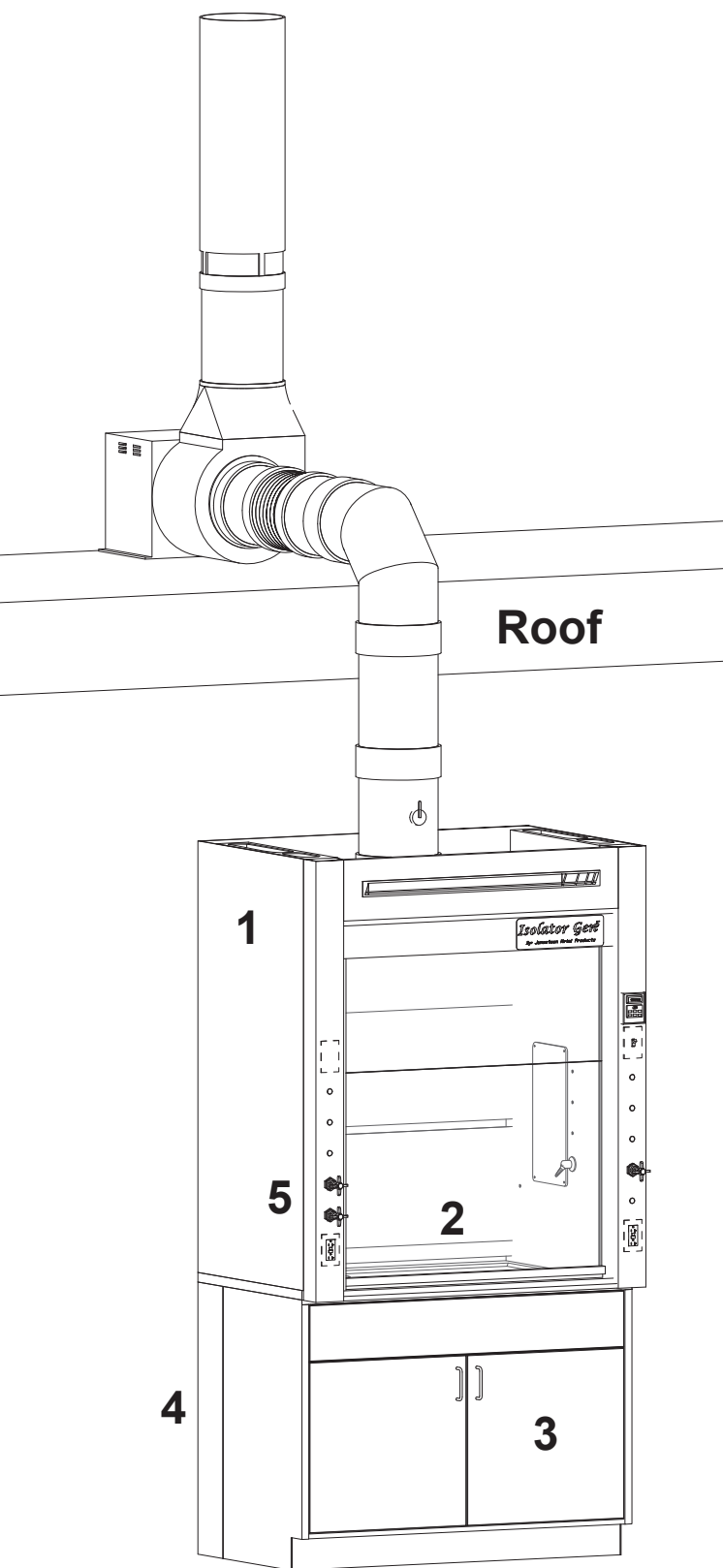

### 1. Select the Fume Hood Style and Size Page

☐ General Purpose Bench Hood 26

☐ 4 ft. ☐ 5 ft. ☐ 6 ft.

☐ General Purpose Walk-In Hood - Standard Depth 28

☐ 4 ft. ☐ 5 ft. ☐ 6 ft. ☐ 8 ft.

☐ General Purpose Walk-In Hood - Extra Deep 28

☐ 4 ft. ☐ 5 ft. ☐ 6 ft. ☐ 8 ft.

### 2. Select a Work Surface and Sink Page

☐ Standard Work Surface 31

☐ 4 ft. ☐ 5 ft. ☐ 6 ft.

☐ Work Surface with Cup Sink 31

☐ 4 ft. ☐ 5 ft. ☐ 6 ft.

☐ Sink Location 31

☐ Left ☐ Right ☐ Both

### 3. Select Base Storage Cabinets Page

☐ Steel Cabinets 9

☐ General ☐ Acid Storage ☐ Solvent Storage

☐ Wood Cabinets 18

☐ General ☐ Acid Storage ☐ Solvent Storage

### 4. Select Cabinet and Hood Trim Page

☐ Steel Cabinet Trim 16

☐ Ceiling Enclosure 31

### 5. Select Service Fittings Page

☐ Standard Fittings 30

☐ Air ☐ Gas ☐ Vac ☐ CW ☐ Nitrogen

☐ CW Gooseneck

☐ Airflow Alarm ☐ Electrical

Detailed information on selecting the right fume hood for your requirements can be found in on page 32.



# Fume Hoods

## High Performance Fume Hood

For over 70 years, ICI has been developing innovative and purpose driven products for the research and healthcare industries. Our highly experienced team of engineers and designers are proud to introduce our latest effort: Isolator<sup>3</sup>. Isolator<sup>3</sup> is the latest generation of energy saving high performance fume hoods, built upon extensive R&D. Utilizing computational fluid dynamics, ICI was able to develop a safe and superior operating environment without the need for additional components to add or inject air into the hood chamber. By controlling baffle pressurization, Isolator<sup>3</sup> achieves the proper capture and containment at a 60 FPM face velocity. Additionally, we do it with a sash opening of 24" (61 cm). JMP's chemical exhaust fume hoods meet or exceed SEFA 1 standards.



### Features:

- 24" (61 cm) deep clear interior
- Low static rectangular exhaust duct
- Integral stainless steel 12" (30.5 cm) round duct transition
- Slotted rear baffle for even plenum balance
- Safe operation at 60 fpm
- Chemically resistant white Poly glass liner
- UL1805 listed, ANSI/ASHRAE 110-1995, UL1275
- Three year hood superstructure warranty
- Chain & Sprocket sash mechanism with the exclusive ICI lifetime warranty
- Exclusive standard 43 1/2" (110.5 cm) tall full view sash area
- Easy conversion from VAV to CAV
- Tempered glass sash with full-length formed steel handle for a neat, clean appearance and streamline air passage
- Standard Color: Pearl White
- Two pre-wired 120V 20 amp GFCI duplex receptacles
- One pre-wired 20 amp light switch
- Pre-wired vapor tight T8 fluorescent light fixture
- Each hood side post and interior is punched and plugged to receive 5 service fixtures
- Upper left side post is punched for optional fan switch
- One pre-wired outlet on roof of hood for an optional alarm
- Upper right side post is punched for optional alarm

			Total CFM & Static Pressure			
Isolator <sup>3</sup> Part Number with frame less vertical sash	Overall Hood Width	Sash Opening Area (Sq Ft)	24" (61 cm) Vertical Opening @ 60 FPM Face Velocity	S.P. Loss	18" (45.7 cm) Vertical Opening @ 80 FPM Face Velocity	S.P. Loss
TSF-350-48G7	4'-0" (121.9 cm)	6.3	380 CFM	0.21"	380 CFM	0.12"
TSF-350-60G7	5'-0" (152.4 cm)	8.3	500 CFM	0.20"	500 CFM	0.11"
TSF-350-72G7	6'-0" (182.9 cm)	10.3	620 CFM	0.31"	620 CFM	0.17"

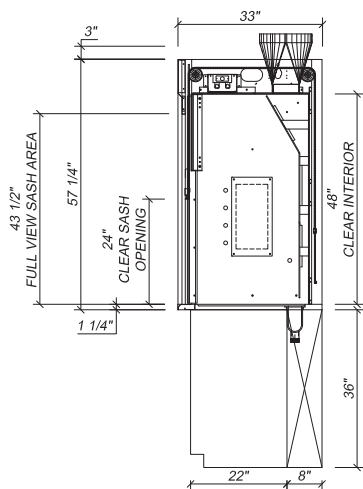

SECTION VIEW

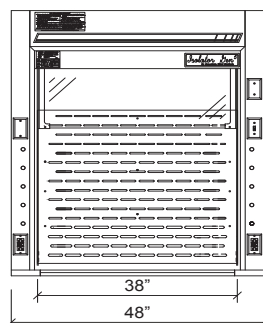

TSF-350-48G7

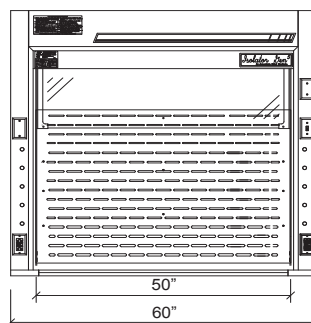

TSF-350-60G7

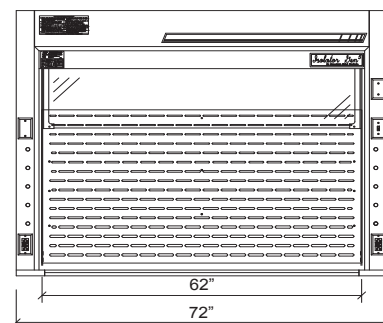

TSF-350-72G7

# Fume Hoods



Full width sash weight at rear of hood



Heavy duty chain and sprocket sash mechanism with an exclusive lifetime warranty

Pre-wired outlet for available alarm



Integral stainless steel 12" (30.5 cm) round duct transition



Exclusive 43 1/2" (110.5 cm) tall "full view" sash area



High performance baffle design, which can be used in both low and standard volume applications



Hood post and interior is punched to receive 5 service fixtures and a fan switch

Acid cabinets are furnished with a chemical resistant lining that has a 1 1/2" (3.8 cm) spill lip. Exhaust vent kit is included.



Full range of standard and specialty storage base cabinets



Hood is fully pre wired with two GFCI duplex outlets, light fixture, light switch and outlet on the roof

# Walk-In Fume Hoods

## Walk-In Fume Hood

The Isolator Gen-5 bypass walk-in fume hood with the frameless vertical sash is similar to the bench style unit in design and function. The top view-pass is clear tempered glass. These units are normally used with tall equipment setups where maximum clarity of vision is a priority. When floor mounted, the walk-in's top fascia aligns with a standard bench hood thus providing a clean look to any design utilizing both types of hood. The Isolator Gen-5 design and construction enhances its value by providing:

- Unparalleled user safety
- Full hood access for easy set ups
- Years of maintenance free service
- Unmatched ease of use with a chain driven sash operation
- Unique design qualities for unlimited customization possibilities
- Field conversion between Constant Air Volume (CAV) and Variable Air Volume (VAV) with a restricted by-pass

### Features:

- Unsurpassed containment (designed and tested to exceed ASHRAE 110-1995)
- Hood is UL1805/CUL certified listed
- Unique chain driven sash mechanism that comes with a lifetime warranty
- Painted steel pan substructure
- 17.25" H. clear observation glass panel, bypass system
- Non-metallic interior
- Vertical sashes provide the greatest hood interior access
- Full view frameless sash with 66-1/2" upper and lower sash openings
- Quality engineering ensures years of reliable service
- White Polyglass liner
- Prewired T8 light and switch
- 2 prewired GFCI duplex outlets
- Prewired duplex outlet on hood roof for optional alarm
- Can be pre-plumbed with remote rod driven fixtures.
- Walk-in hoods are available for shipment in 7-8 weeks
- These hoods are furnished in Pearl White
- Other sash configurations and hood styles available upon request
- Epoxy resin work decks available upon request
- All hoods are available in both a standard 24" depth as well as a 30" deep format (D30)
- 2 pre-wired GFCI Duplex outlets
- Pre-wired T8 light and switch
- Each hood side post and interior is punched and plugged to receive 5 service fixtures
- Upper left side post is punched for optional fan switch
- One pre-wired outlet is provided on roof of hood for an optional alarm
- Upper right side post is punched for optional alarm
- Adjustable baffles

## Walk-In Fume Hood



Our Walk-In hoods are a great choice for large apparatus or procedures to ensure user safety and efficacy of operations.

# Fume Hood Accessories

## Fittings for Fume Hood

- These WaterSaver brand remote control fittings consist of a brass angle valve with a replaceable seat, an epoxy coated brass nylon color-coded panel flange with angle serrated hose connector, a remote control rod assembly with a plastic flange and a tank nipple, locknut and washer.
- Fittings may be used on either side of hood.
- Shipped loose and installed in field.



Fitting Type	Part Number
Air (Orange)	TSL3185N-LR-A
Gas (Dark Blue)	TSL3185N-LR-G
Nitrogen (Brown)	TSL3185N-LR-N
Vacuum (Yellow)	TSL3185N-LR-V

## Cold Water Fitting for Fume Hood

- These WaterSaver brand remote control fittings consist of a brass angle valve with a replaceable seat, and epoxy coated brass nylon color-coded panel flange with a gooseneck with a vacuum breaker, a remote control rod assembly with a plastic flange and a tank nipple, locknut and washer.
- Shipped loose and installed in field.



Fitting Type	Part Number
Cold Water with Vacuum Breaker	TSL3185W-9RSVB

## Fume Hood Alarm

- Each **INSTOCK**® fume hood is pre-punched for the fast and easy installation of this alarm.
- The monitor provides a digital readout of fume hood face velocity and sounds an alarm when the airflow falls below safe levels.
- Consisting of a thermostat sensor (mounted through the side wall of the fume hood) and a monitor (mounted on the fascia), the unit gives both a visual and audible alarm.
- The monitor also contains test/reset button allowing the user to verify alarm readiness.
- This monitor is shipped loose for field installation.



Product	Part Number
Fume Hood Alarm	TSAFA4000

## External Vacuum Breaker

- Shipped loose and installed in field.

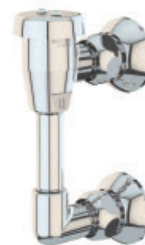

Fitting Type	Part Number
External Vacuum Breaker	TSL112WSA

## Cold Water Fitting for Fume Hood

- These WaterSaver brand remote control fittings consist of a brass angle valve with a replaceable seat, and epoxy coated brass nylon color-coded panel flange with a gooseneck without a vacuum breaker, a remote control rod assembly with a plastic flange and a tank nipple, locknut and washer.
- Shipped loose and installed in field.



Fitting Type	Part Number
Cold Water without Vacuum Breaker	TSL3185W-9RS

## Fan Blower Switch

- Manual fan motor starter switch, toggle style, single pole, with red pilot light, stainless steel cover plate, 1 thermal unit, for 1 or 2 HP maximum motor size



Product	Part Number
For use with a 1 HP fan	TS2510FS1P
For use with a 2 HP fan	TS2510FS2P



## Bench Fume Hood Work Surface

- These 1 1/4" thick modified black epoxy resin work surfaces are required for all bench hoods and are dished to retain spills
- Sinks and cutouts are furnished as options

Bench Fume Hood Width	Part Number
4'-0" (121.9 cm)	TSWL-48B
5'-0" (152.4 cm)	TSWL-60B
6'-0" (182.9 cm)	TSWL-72B

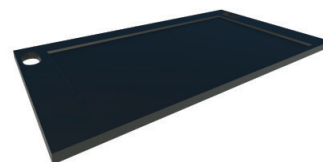

## Bench Fume Hood Work Surface Cup Sink Cutout and Cup Sink

- This includes a cup sink cutout and black polypropylene 3" x 6" cup sink
- Bench Fume Hood Work Surface sold separately

For use with:	Sink and Left Side Cutout	Sink and Right Side Cutout
Bench Fume Hood	TSCS-LS	TSCS-RS



## Adjustable Height Fume Hood Ceiling Enclosure

- These three sided ceiling enclosures are designed to fill the space between the top of the hood and the ceiling up to 24" (61 cm) in height to provide a clean finished appearance.
- The enclosure is cut to fit in the field and includes a slip to fit ceiling finish trim angle.

Fume Hood Width	Part Number
4'-0" (121.9 cm)	TSCE48P-NA-24GG
5'-0" (152.4 cm)	TSCE60P-NA-24GG
6'-0" (182.9 cm)	TSCE72P-NA-24GG



## Gravity Sash Stop

- As a safety or energy conservation measure, a sash stop may be added to any of our hoods.
- It may be mounted at any distance above the lower deflector vane to keep the sash from rising past that point.
- When needed, the stop may be pivoted out of the way.

Product	Part Number
Gravity Sash Stop	TSSP01

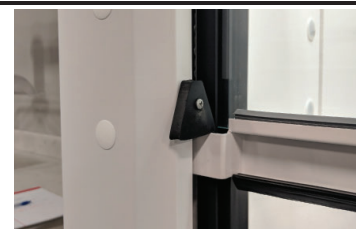

# Fume Hood Accessories

## **Chemical Fume Hood Selection Considerations**

A laboratory fume hood is the most important safety component used to protect laboratory personnel from exposure to hazardous chemicals and agents. Functionally, a chemical hood is a fire and chemical resistant enclosure with a movable window or sash at the face to allow user access to the interior.

### **The choice of a laboratory hood is based upon two important considerations:**

1. The safety of the personnel that will be performing the procedure within the hood
2. The process and procedure that will be performed within it

Thought must be given to the equipment that will be placed within the hood. It needs to be large enough to leave 3" clear at the rear & sides and 6" clear at the front of the hood for the efficient passage of air into the hood and around the equipment. The configuration of the hood needs to be such that containers and implements can pass through the opening and provide a safe & comfortable working environment for the user.

The safe operating efficiency of the hood should also be considered. Laboratory fume hoods consume large quantities of conditioned air that is exhausted through the roof of the building. Choosing the right size, style and sash configuration for a hood can help significantly save an annual operating costs.

### **Operational Face Velocity:**

Reference standards such as OSHA, ACGIH, NFPA, SEFA and ANSI/AIHA Z9.5 suggest average hood face velocities of 60-100 FPM. Note however, that hood face velocity alone doesn't guarantee a level of safety or protection. The design of the hood, it's suitability for the procedure to be performed, the quality of the supply & exhaust air systems and protocol or SOP by which it is used are critical to the overall safety of the user, lab and building. Please consult with your Environmental Health and Safety Officer for further direction.

### **Standard Options:**

- Sash options include vertical rising, horizontal sliding, or a combination of the two
- Work tops include epoxy resin or stainless steel and can include a wide range of sinks.
- Hood liner materials can include polyglass, stainless steel and polyethylene.
- All needed lights, outlets, switches and plumbing services can be positioned to suit requirements.
- Air flow alarms and auto sash controllers are available to monitor air flow and maximize energy savings
- Seismic restraints for bench and walk-in hoods.

## Exhaust System Recommendations

- Exhaust fans should be mounted on the roof so that the ductwork leading to the fan is under negative pressure. Please note that if exhaust fans are mounted inside the building, all ductwork connected to the fan outlet will be under positive pressure, and if leaks should develop in the portion of the ductwork inside the building, hazardous fumes could be forced out of the ductwork and into that area of the building.
- For the lowest possible noise level in the exhaust system, we suggest the following actions:
  - Use vibration isolators for mounting the exhaust fan.
  - Select an exhaust fan that will deliver the desired CFM and static pressure with the lowest practical impeller wheel RPM.
  - Use a flexible connection at the fan inlet to isolate transmission of noise from the duct to the hood.
  - Design the exhaust duct system with the fewest possible elbows or other fittings. Use radius type elbows and avoid square elbows.

## Typical Fume Hood Ventilation System

The diagram below details of the components found in a typical fume hood ventilation system. All of these components as well as others are available within this catalog.

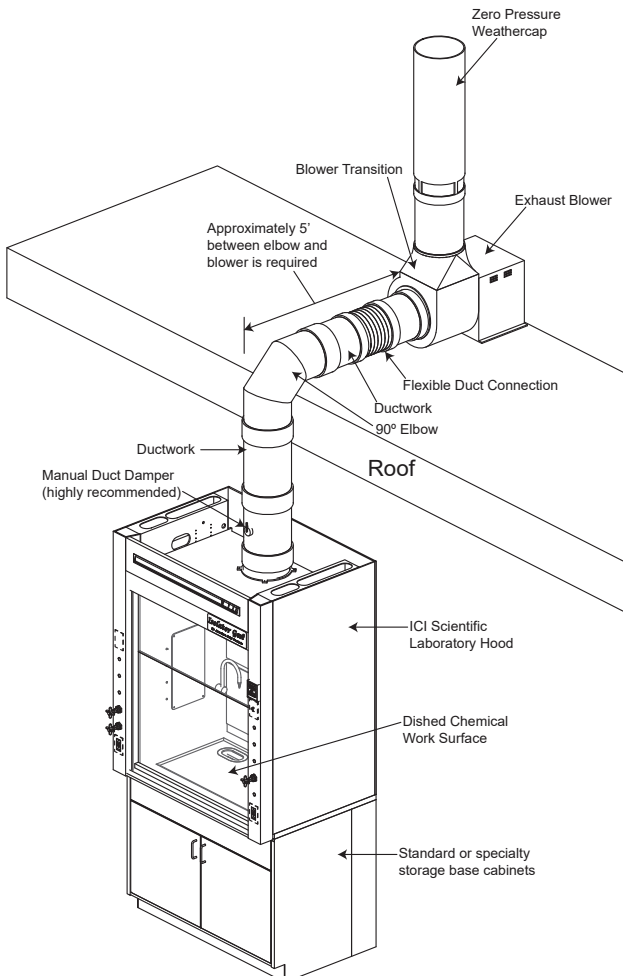

## Hood Exhaust Blower Sizing

When sizing an exhaust blower, it is necessary to include the equivalent air movement resistance factors for all ductwork and accessories in the ventilation system. Contact your HVAC contractor to ensure an accurate supply and exhaust air system.

### Steps to sizing the right hood fan

1. Review the CFM and static pressure loss for the use of the selected fume hood. The catalog details provided for each hood indicate these values.
2. Add up all the equivalent resistance amounts in feet of straight duct of the ductwork, components, fittings and fume hood in your system.
3. Use the fan selection chart to cross reference the total CFM required as well as the system static pressure loss to select the right exhaust blower for your application.
4. Contact your HVAC contractor for assistance.

Duct Diameter	6"	8"	10"	12"	16"
Airflow/ CFM	Static pressure loss in inches of water for each 10' length of ductwork				
250	0.039	0.011	0.003	0.001	-
500	0.147	0.037	0.013	0.005	0.001
750	0.321	0.079	0.026	0.011	0.003
1000	0.557	0.140	0.043	0.018	0.005
1250	0.855	0.210	0.066	0.027	0.008
1500	-	0.300	0.095	0.039	0.012
1750	-	0.380	0.130	0.053	0.016
2000	-	0.485	0.155	0.067	0.020
2500	-	-	0.245	0.109	0.031
3000	-	-	-	0.145	0.042
4000	-	-	-	0.240	0.074
5000	-	-	-	-	0.120

# Exhaust Snorkels

Our exhaust snorkels are made of lightweight anodized aluminum sections, with three adjustable, composite friction joints. Offering strength and durability combined with easy handling. They are suitable for the removal of heat or nuisance fumes. They need to be tied into the general exhaust for the lab. They are a reliable all-round arm for general applications where there is a little risk of electrical discharges.

- Available in 3" diameter with a maximum working radius of 42.9" (109 cm) or 57.1" (145 cm)
- Each arm is furnished with 5.5" mini hood that will accept the optional hoods noted in this section
- The two outermost arm joints can rotate and swivel 360°
- These arms are designed to be mounted from the wall or ceiling. Complete mounting components and hardware is included with each exhaust arm.



**The Original model** is a robust and reliable all-round exhaust snorkel for general applications where there is little risk of electrical discharges or attack by aggressive chemicals.



**The CHEM model** is constructed of anodized aluminum with a white electrophoretic deposition coating making the arm ideal for fume extraction in aggressive environments where corrosion resistance must be assured.

**Air Flow with Resultant Static Pressure Drop and Sound Level**

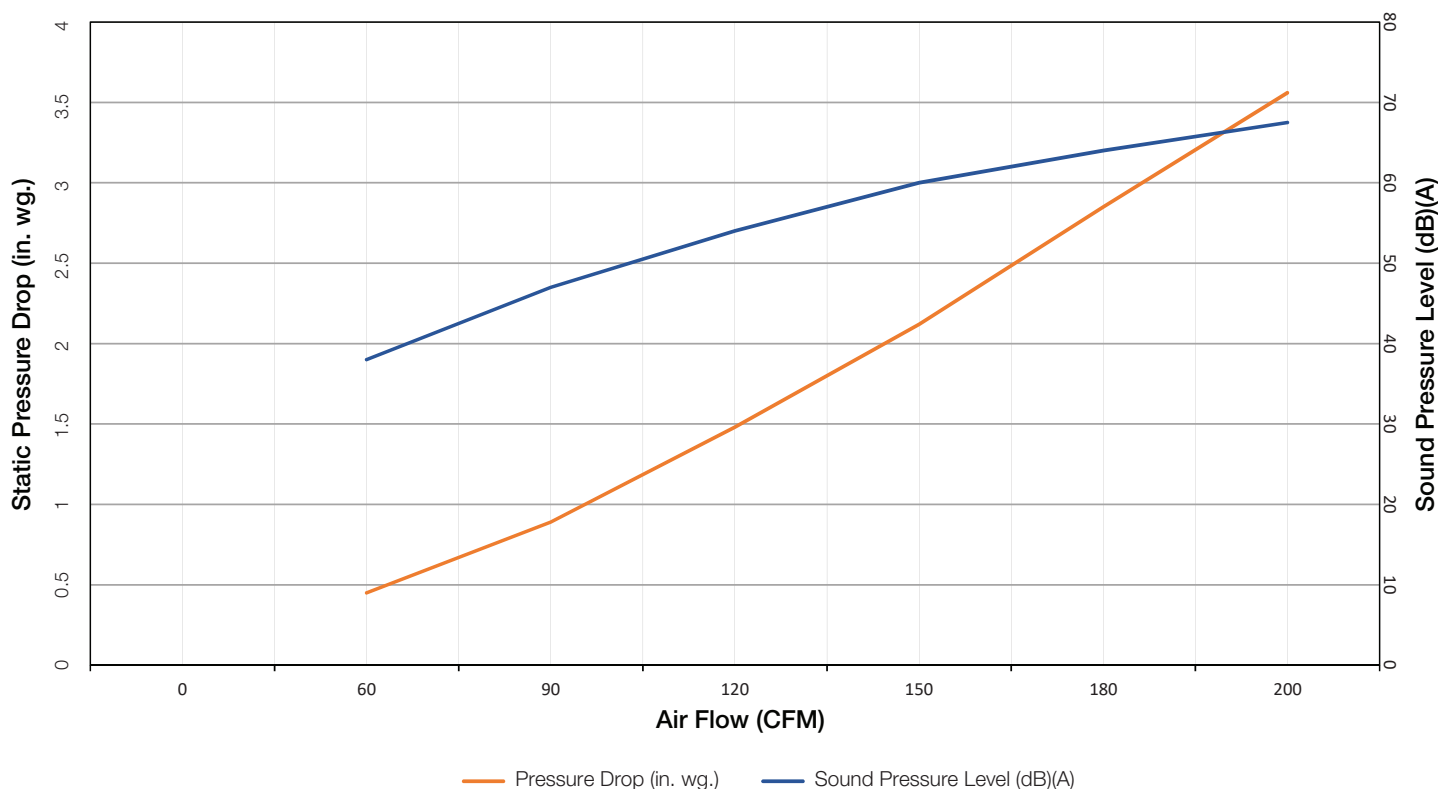

Exhaust Snorkels

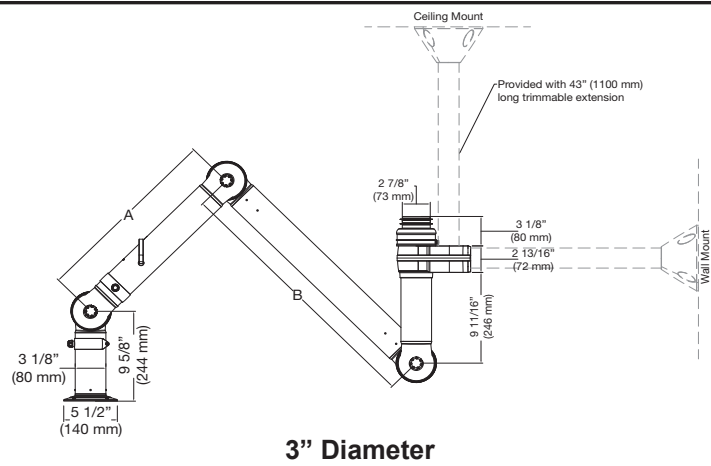

3" Diameter

Part Number	Description	Diameter	A	B	Max. Working Radius
TSOES-3	ORIGINAL Model	3" 75 mm	16.5" (42 cm)	16.5" (42 cm)	42.9" (109 cm)
TSOES-3L	ORIGINAL Model		19.7" (50 cm)	27.5" (70 cm)	57.1" (145 cm)
TSCES-3	CHEM Model		16.5" (42 cm)	16.5" (42 cm)	42.9" (109 cm)
TSCES-3L	CHEM Model		19.7" (50 cm)	27.5" (70 cm)	57.1" (145 cm)

Accessories

Combi Hood



- Transparent combi hood, made of PET-G plastic, arms are designed to capture contaminants with low energy.
- It can be attached directly on mini hood, irrespective of arm size.
- The ergonomics of handle design on both sides of the hood make it easier to maneuver.

Part Number	For Use With:
TS70500144	Original Model
TS70500344	CHEM Model

Dome Hood



- Transparent dome hood, made of PET-G plastic, is designed to capture high dispersion contaminants.
- It can be attached directly on mini hood, irrespective of arm size.
- The ergonomics of handle design on both sides of the hood make it easier to maneuver.

Part Number	For Use With:
TS70376982	Original Model
TS70376984	CHEM Model

Metal Hood



- Powder coated white metal hood, made of aluminum, is designed to capture contaminants in high temperature, aggressive fume where corrosion resistance must be assured or dust splatter.
- It can be attached directly on mini hood, irrespective of arm size.

Part Number	For Use With:
TS70500444	Original Model
	CHEM Model



## Bench and Wall Shelving



**A place for everything and everything in its place**



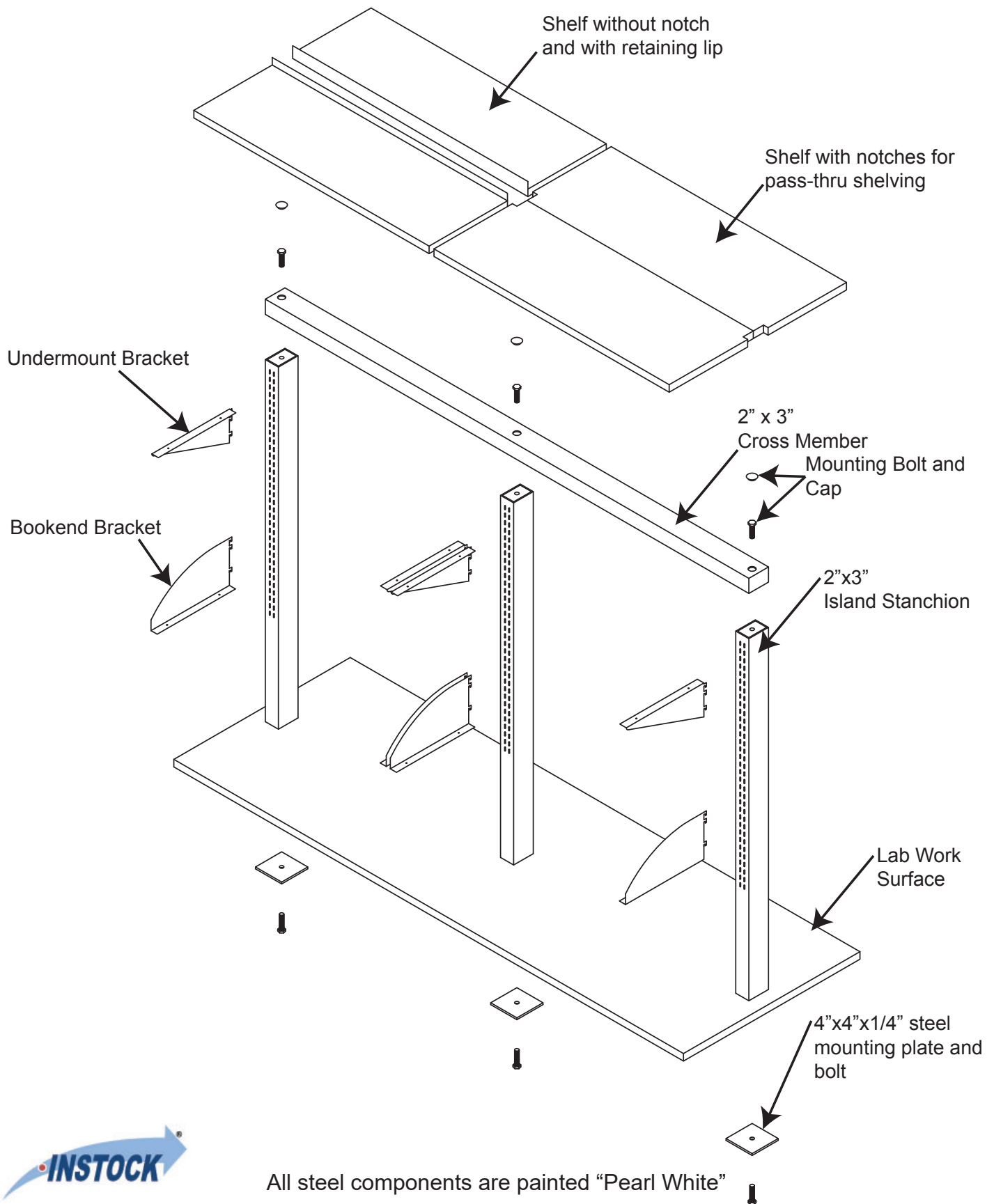

# Shelving Systems

## Island Stanchion

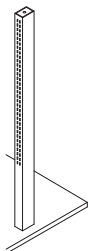

- 48" Tall
- 11 ga.
- All hardware is included

TSFT-23-4B-48A	48" L (121.9 cm)
----------------	---------------------

## Wall Standard



TSFC-1.5X.5-2B-36	36" L (91.4 cm)
TSFC-1.5X.5-2B-48	48" L (121.1 cm)
TSFC-1.5X.5-2B-60	60" L (152.4 cm)
TSFC-1.5X.5-2B-72	72" L (182.9 cm)

## Cross Member

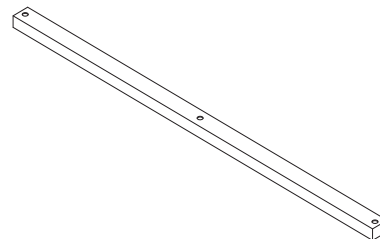

- Cross members are custom made for each project
- Priced in 12" increments
- Welded and caps
- All hardware is included
- Contact us for full details

## Bookend Shelf Bracket

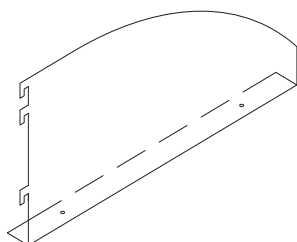

Left Bracket	
TSFTB-14GA-8L	8" D (20.3 cm)
TSFTB-14GA-12L	12" D (30.5 cm)
TSFTB-14GA-16L	16" D (40.6 cm)
Right Bracket	
TSFTB-14GA-8R	8" D (20.3 cm)
TSFTB-14GA-12R	12" D (30.5 cm)
TSFTB-14GA-16R	16" D (40.6 cm)

## Undermount Bracket

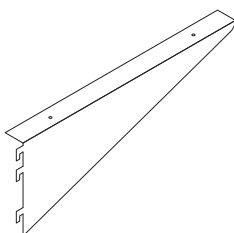

Left Bracket	
TSFTBL-14GA-8L	8" D (20.3 cm)
TSFTBL-14GA-12L	12" D (30.5 cm)
TSFTBL-14GA-16L	16" D (40.6 cm)
Right Bracket	
TSFTBL-14GA-8R	8" D (20.3 cm)
TSFTBL-14GA-12R	12" D (30.5 cm)
TSFTBL-14GA-16R	16" D (40.6 cm)

TSTUB2X3X24	24" W (61 cm)
TSTUB2X3X36	36" W (91.4 cm)
TSTUB2X3X48	48" W (121.9 cm)
TSTUB2X3X60	60" W (152.4 cm)
TSTUB2X3X72	72" W (182.9 cm)
TSTUB2X3X84	84" W (213.4 cm)
TSTUB2X3X96	96" W (243.8 cm)
TSTUB2X3X108	108" W (274.3 cm)
TSTUB2X3X120	120" W (304.8 cm)
TSTUB2X3X132	132" W (335.3 cm)
TSTUB2X3X144	144" W (365.8 cm)

All steel components are painted Pearl White

## Notched Shelving for Island Stanchions

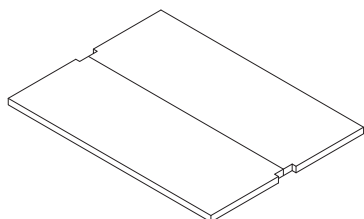

- 1" thick chemical resistant black phenolic resin
- Front edge finished
- Notched around standards to create a pass-thru shelf

8" Deep	12" Deep	16" Deep	Width
TSPSN0824	TSPSN1224	TSPSN1624	24" (61 cm)
TSPSN0830	TSPSN1230	TSPSN1630	30" (76.2 cm)
TSPSN0836	TSPSN1236	TSPSN1636	36" (91.4 cm)
TSPSN0842	TSPSN1242	TSPSN1642	42" (106.7 cm)
TSPSN0848	TSPSN1248	TSPSN1648	48" (121.9 cm)
TSPSN0854	TSPSN1254	TSPSN1654	54" (137.2 cm)
TSPSN0860	TSPSN1260	TSPSN1660	60" (152.4 cm)

## Phenolic Shelving

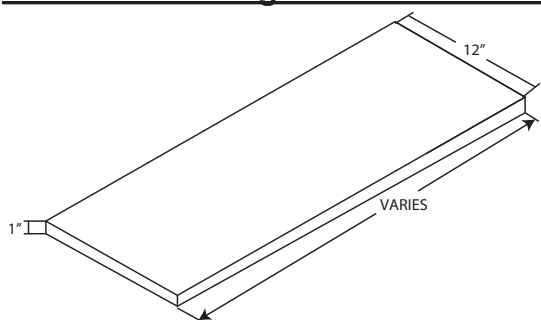

- 1" thick chemical resistant black phenolic resin
- Front edge finished
- **Contact us for custom sizes that can ship in 10 days**

8" Deep	12" Deep	16" Deep	Width
TSPS0824	TSPS1224	TSPS1624	24" (61 cm)
TSPS0830	TSPS1230	TSPS1630	30" (76.2 cm)
TSPS0836	TSPS1236	TSPS1636	36" (91.4 cm)
TSPS0842	TSPS1242	TSPS1642	42" (106.7 cm)
TSPS0848	TSPS1248	TSPS1648	48" (121.9 cm)
TSPS0854	TSPS1254	TSPS1654	54" (137.2 cm)
TSPS0860	TSPS1260	TSPS1660	60" (152.4 cm)

## Rear Retaining Lips

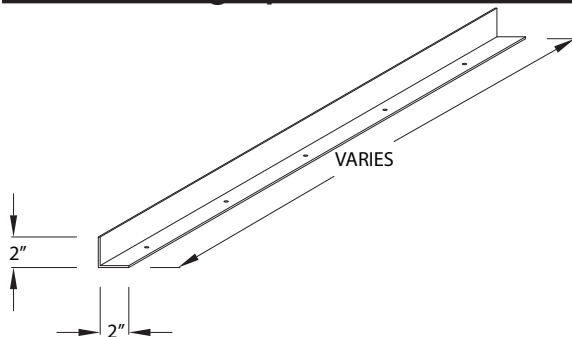

- Provides 1" rear lip for island or peninsula shelving when used with 1" thick shelves
- Attaches to the bottom of shelf
- Holes for attachment spaced at 6" intervals
- Sized to fit shelf
- 16 ga. construction
- Standard color: Pearl White

Painted Steel	Length
TSPSLA24	24" (61 cm)
TSPSLA30	30" (76.2 cm)
TSPSLA36	36" (91.4 cm)
TSPSLA42	42" (106.7 cm)
TSPSLA48	48" (121.9 cm)
TSPSLA54	54" (137.2 cm)
TSPSLA60	60" (152.4 cm)

## Bench Mounted Reagent Poles - Painted



- 1" diameter painted steel pole is threaded at both ends
- Bolts through the work surface for secure mounting
- Poles can stack to create tiered shelves in the center of a bench
- Fastener on the reagent shelf surfaces is recessed
- Hardware is included for each installation
- Standard color: Pearl White

Part Number	Length
TSRP-12	12" (30.5 cm)
TSRP-15	15" (38.1 cm)
TSRP-18	18" (45.7 cm)
TSRP-24	24" (61 cm)



# Shelving Systems

## Shelving Features:

- Chrome wire shelving is made of carbon-steel
- Stainless Steel Units are made of Type 304 Polished Stainless Steel
- Each unit includes: 4 posts, 4 shelves and split-sleeves to attach shelves to posts
- Open wire design minimizes dust accumulation and allows circulation for air
- Shelves can be adjusted at 1" intervals along entire height of the post
- 36"-54" long shelves have a maximum capacity of 800 lbs./each
- 60"-72" long shelves have a maximum capacity of 600 lbs./each
- Each mobile unit has a maximum capacity of 900 lbs., with uniformly distributed load
- Each stationary unit has a maximum capacity of 2,000 lbs., with uniformly distributed load
- Casters: Rubber casters with Poly housing, 5" Swivel, 2 with brake.

## Stationary Wire Shelving



## Mobile Wire Shelving



Chrome	Stainless Steel	Dimensions W x D x H
TSJ1836-74C	TSSS1836	36" x 18" x 74" (91.4 x 45.7 x 187.9 cm)
TSJ1848-74C	TSSS1848	48" x 18" x 74" (121.9 x 45.7 x 187.9 cm)
TSJ1860-74C	TSSS1860	60" x 18" x 74" (152.4 x 45.7 x 187.9 cm)
TSJ1872-74C	TSSS1872	72" x 18" x 74" (182.9 x 45.7 x 187.9 cm)
TSJ2436-74C	TSSS2436	36" x 24" x 74" (91.4 x 61 x 187.9 cm)
TSJ2448-74C	TSSS2448	48" x 24" x 74" (121.9 x 61 x 187.9 cm)
TSJ2460-74C	TSSS2460	60" x 24" x 74" (152.4 x 61 x 187.9 cm)
TSJ2472-74C	TSSS2472	72" x 24" x 74" (182.9 x 61 x 187.9 cm)

Chrome	Stainless Steel	Dimensions
TSMJ1836-79C	TSMSS1836	36" x 18" x 79" (91.4 x 45.7 x 200.7 cm)
TSMJ1848-79C	TSMSS1848	48" x 18" x 79" (121.9 x 45.7 x 200.7 cm)
TSMJ1860-79C	TSMSS1860	60" x 18" x 79" (152.4 x 45.7 x 200.7 cm)
TSMJ1872-79C	TSMSS1872	72" x 18" x 79" (182.9 x 45.7 x 200.7 cm)
TSMJ2436-79C	TSMSS2436	36" x 24" x 79" (91.4 x 61 x 200.7 cm)
TSMJ2448-79C	TSMSS2448	48" x 24" x 79" (121.9 x 61 x 200.7 cm)
TSMJ2460-79C	TSMSS2460	60" x 24" x 79" (152.4 x 61 x 200.7 cm)
TSMJ2472-79C	TSMSS2472	72" x 24" x 79" (182.9 x 61 x 200.7 cm)

## Wire Shelf Dividers



- Keep shelf contents orderly with these 8" high, pressure-fit dividers

Chrome	Stainless Steel	Dimensions L x H
TSJDD18C	TSDD18S	18" x 8" (45.7 x 20.3 cm)
TSJDD24C	TSDD24S	24" x 8" (61 x 20.3 cm)

## Wire Shelf Ledges



- For stationary or mobile installations
- Ledges prevent items from protruding or falling from shelves

Chrome	Stainless Steel	Dimensions L x H
TSJL18N-4C	TSL18N-4S	18" x 4" (45.7 x 10.2 cm)
TSJL24N-4C	TSL24N-4S	24" x 4" (61 x 10.2 cm)
TSJL36N-4C	TSL36N-4S	36" x 4" (91.4 x 10.2 cm)
TSJL48N-4C	TSL48N-4S	48" x 4" (121.9 x 10.2 cm)
TSJL60N-4C	TSL60N-4S	60" x 4" (152.4 x 10.2 cm)
TSJL72N-4C	TSL72N-4S	72" x 4" (182.9 x 10.2 cm)

## Wire Super Slide

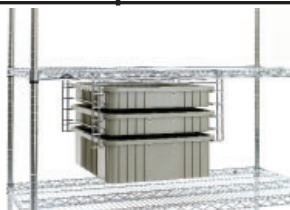

- Finish is nickel-chrome wire with clean protective coating
- Only for 24" deep units

Part Number	Dimensions H x W x L
TSSS2NC	10 1/4" x 20 3/8" x 21 5/8" (26 x 52.3 x 54.9 cm)
<b>Hanging Totes</b>	
TSMTB93030W	3" x 17 1/2" x 22 1/2" (7.6 x 44.5 x 57.2 cm)
TSMTB93060W	6" x 17 1/2" x 22 1/2" (15.2 x 44.5 x 57.2 cm)
TSMTB93080W	8" x 17 1/2" x 22 1/2" (20.3 x 44.5 x 57.2 cm)

## Clear Label Holders

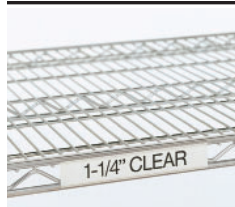

- Clear plastic label
- Holds most commercial 1 1/4" labels

Part Number	Fits Shelf Length	Dimensions W x H
TS9990CL	All	3" x 1 1/4" (7.6 x 3.2 cm)
TS9990CL1	18"	13" x 1 1/4" (33 x 3.2 cm)
TS9990CL2	24"	19" x 1 1/4" (48.3 x 3.2 cm)
TS9990CL3	30"	25" x 1 1/4" (63.5 x 3.2 cm)
TS9990CL4	48"	43" x 1 1/4" (109.2 x 3.2 cm)
TS9990CL5	60"	55" x 1 1/4" (139.7 x 3.2 cm)

# Shelving Systems

## Epoxy Coated Shelving Features:

- Each unit includes 4 posts, 4 shelves and split-sleeves to attach shelves to posts
- Furnished in Metroseal 3 Epoxy
- Corrosion resistant finish for wet or high humidity environments
- Open wire design minimizes dust accumulation and allows free circulation for air
- Shelves can be adjusted at 1" intervals along entire height of the post
- 36"-54" long shelves have a maximum capacity of 800 lbs./each
- 60"-72" long shelves have a maximum capacity of 600 lbs./each
- Each mobile unit has a maximum capacity of 900 lbs., with uniformly distributed load
- Each stationary unit has a maximum capacity of 2,000 lbs., with uniformly distributed load
- 7 year limited warranty against rust and corrosion
- Unit Casters: Rubber casters with Poly housing, 5" Swivel, 2 with brake.

## Epoxy Coated Stationary Wire Shelving



Epoxy Coated	Dimensions W x D x H
TSJ1836-74K	36" x 18" x 74" (91.4 x 45.7 x 187.9 cm)
TSJ1848-74K	48" x 18" x 74" (121.9 x 45.7 x 187.9 cm)
TSJ1860-74K	60" x 18" x 74" (152.4 x 45.7 x 187.9 cm)
TSJ1872-74K	72" x 18" x 74" (182.9 x 45.7 x 187.9 cm)
TSJ2436-74K	36" x 24" x 74" (91.4 x 61 x 187.9 cm)
TSJ2448-74K	48" x 24" x 74" (121.9 x 61 x 187.9 cm)
TSJ2460-74K	60" x 24" x 74" (152.4 x 61 x 187.9 cm)
TSJ2472-74K	72" x 24" x 74" (182.9 x 61 x 187.9 cm)

## Epoxy Coated Mobile Wire Shelving



Epoxy Coated	Dimensions W x D x H
TSMJ1836-79K	36" x 18" x 79" (91.4 x 45.7 x 200.7 cm)
TSMJ1848-79K	48" x 18" x 79" (121.9 x 45.7 x 200.7 cm)
TSMJ1860-79K	60" x 18" x 79" (152.4 x 45.7 x 200.7 cm)
TSMJ1872-79K	72" x 18" x 79" (182.9 x 45.7 x 200.7 cm)
TSMJ2436-79K	36" x 24" x 79" (91.4 x 61 x 200.7 cm)
TSMJ2448-79K	48" x 24" x 79" (121.9 x 61 x 200.7 cm)
TSMJ2460-79K	60" x 24" x 79" (152.4 x 61 x 200.7 cm)
TSMJ2472-79K	72" x 24" x 79" (182.9 x 61 x 200.7 cm)



Our Patriot Table is a value driven, adjustable height, standard duty bench suitable for many basic lab applications. They are available with and without shelving uprights.

# Patriot Tables

## Adjustable Height Patriot Table with Leveling Glides



- Includes leveling glides that have a 1/2" stem and 1 3/4" foot
- Tables have a mechanical bolt style height adjustment
- Work surface is 1" thick black phenolic.
- 1" work surface overhang on front and sides, 1 5/8" work surface overhang on back
- Steel frame color: Pearl White
- All adjustable height benches with leveling glides are rated for 950 lbs. UDL.

Part Number	Dimensions W x D x H
TSPT4830-LG	48" x 30" x 30"-36" (121.9 x 76.2 x 76.2-91.4 cm)
TSPT6030-LG	60" x 30" x 30"-36" (152.4 x 76.2 x 76.2-91.4 cm)
TSPT7230-LG	72" x 30" x 30"-36" (182.9 x 76.2 x 76.2-91.4 cm)

## Adjustable Height Patriot Table with Locking Swivel Casters



- Include 4" locking swivel casters
- Tables have a mechanical bolt style height adjustment
- Work surface is 1" thick black phenolic.
- 1" work surface overhang on front and sides, 1 5/8" work surface overhang on back
- Steel frame color: Pearl White
- All adjustable height benches with leveling glides are rated for 950 lbs. UDL.

Part Number	Dimensions W x D x H
TSPT4830-C	48" x 30" x 30"-36" (121.9 x 76.2 x 76.2-91.4 cm)
TSPT6030-C	60" x 30" x 30"-36" (152.4 x 76.2 x 76.2-91.4 cm)
TSPT7230-C	72" x 30" x 30"-36" (182.9 x 76.2 x 76.2-91.4 cm)



## **Adjustable Height Patriot Table with Leveling Glides, Uprights and One 12" Deep Steel Shelf**



- Includes leveling glides that have a 1/2" stem and 1 3/4" foot.
- Benches have a mechanical bolt style height adjustment.
- Work surface is 1" black phenolic.
- Steel shelf includes a front and rear lip and bookend brackets.
- Steel frame color: Pearl White
- All adjustable height benches with leveling glides are rated for 950 lbs. UDL.

Part Number	Dimensions W x D x H
TSPT4830-ULG	48" x 30" x 30"-36" (121.9 x 76.2 x 76.2-91.4 cm)
TSPT6030-ULG	60" x 30" x 30"-36" (152.4 x 76.2 x 76.2-91.4 cm)
TSPT7230-ULG	72" x 30" x 30"-36" (182.9 x 76.2 x 76.2-91.4 cm)

## **Adjustable Height Patriot Table with Locking Swivel Casters, Uprights and One 12" Deep Steel Shelf**



- Includes 4" locking swivel casters
- Benches have a mechanical bolt style height adjustment.
- Work surface is 1" black phenolic.
- Steel shelf includes a front and rear lip and bookend brackets.
- Steel frame color: Pearl White
- All adjustable height benches with leveling glides are rated for 950 lbs. UDL.

Part Number	Dimensions W x D x H
TSPT4830-UC	48" x 30" x 30"-36" (121.9 x 76.2 x 76.2-91.4 cm)
TSPT6030-UC	60" x 30" x 30"-36" (152.4 x 76.2 x 76.2-91.4 cm)
TSPT7230-UC	72" x 30" x 30"-36" (182.9 x 76.2 x 76.2-91.4 cm)

# Patriot Table Accessories

## Additional 12" Deep Shelf and Brackets



- Includes a painted steel shelf with bookend brackets, front and rear lip and all attachment hardware.
- To be used with Patriot Table with Uprights.
- Standard color: Pearl White

Part Number	For Use with
TSPT48-AS	48" wide Patriot Table
TSPT60-AS	60" wide Patriot Table
TSPT72-AS	72" wide Patriot Table

## LED Task Lighting Assemblies for Patriot Table with Uprights



- Features multiple, state of the art, energy saving components that include touch and hold continuous dimming and 10-hour automatic turnoff.
- 4', 5' and 6' tables include 1 ea. LED task light, magnetic angle mount that allows for up to 25 degrees of adjustment, 60 watt power supply with magnetic mount and 6' white cord.
- Made with anodized aluminum and lasts up to 50,000 hours.

Part Number	Actual Width	For Use with
TSPT48-LED	30.1" (76.5 cm)	48" wide Patriot Table
TSPT60-LED	43.7" (111 cm)	60" wide Patriot Table
TSPT72-LED	57.9" (147.1 cm)	72" wide Patriot Table

## Electrical Outlet Strip and Bin Rail



- Bin rails with electric outlet strips are furnished with all hardware for attachment to Patriot Table with uprights.
- All electrical outlet strips are 24" long and include 20 amp wiring, 8 each 20 amp outlets and a 20 amp circuit breaker
- They include a 6' cord with a 20 amp NEMA 5-20P plug.
- Also available with a NEMA L5-20P plug allowing the work bench to connect to a twist-to-lock receptacle on an over head service panel.
- Rail will accept standard AkroMils Bins

Standard 20 amp plug	Twist-to-Lock 20 amp plug	Bin Rail Length	Number of Outlets
TSPT48-ESBRS	TSPT48-ESBRT	48" (121.9 cm)	8
TSPT60-ESBRS	TSPT60-ESBRT	60" (152.4 cm)	8
TSPT72-ESBRS	TSPT72-ESBRT	72" (182.9 cm)	8

## Bracket for Plumbing Service Fixtures

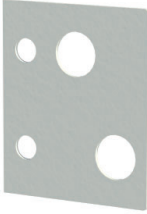

- To be used with the Patriot Table with uprights.
- The painted steel bracket can be used on the left or right upright of the table and is bored to accept 2 plumbing fixtures.
- Standard color: Pearl White

Part Number	For use with
TSPTBSF	Patriot Table with Uprights

## Overhead Service Panel

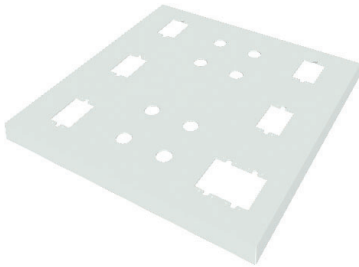

- These painted steel overhead service panels are designed to fit into a 24" x 24" ceiling grid.
- They are made to order based upon services required.
- Components are sold separately and are shipped loose to be installed on site.
- Standard color: Pearl White

Part Number	Number of Service Cutouts
TSENO SP-10	1-10
TSENO SP-20	11-20

## Twist-to-Lock Electrical for Overhead Service Panel

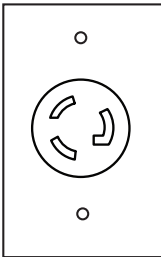

- Includes electrical box, NEMA L5-20R, 120 V, 20 amp twist-to-lock receptacle, and a stainless steel cover plate.

Part Number	NEMA Configuration
TSEN-LEV5-20R	L5-20R

# Patriot Table Accessories

## Patriot Table Complete Plumbing Assemblies



System Service Hose



Male Quick Connect Plug

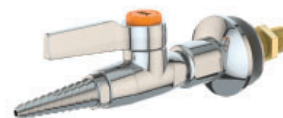

Ball Valve Service Turret

Patriot Table Complete Plumbing Assemblies include a ball valve service turret with shank, a service hose, and a male quick connect fitting. These complete assemblies are designed specifically for use with out workstations in a laboratory environment. All quick connects have 316 stainless steel internal components. Keyed quick connect members will only couple with components of the same key which are identified by a color code. Assemblies consist of 2 major components and are shipped loose to be installed on site.

The service hoses carry services from the overhead service panel, through the upright of the table and to the shank of the fixture. They consist of color coded reinforced PVC 1/4" hose. Air and Nitrogen male quick connects have double end shut off plugs and have an internal valve that shuts off flow when un-coupled. Vacuum has a single end shut off plug and does not have an internal valve. The ball valve is a polished chrome valve with a brass floating cone and integral brass seat. They provide metering control of laboratory gases at pressures up to 60 PSI. The turret shank is bored for the connection of the service hose.

Part Number	Color	Service
TSPTCPA-A	Orange	Air
TSPTCPA-V	Yellow	Vacuum
TSPTCPA-N	Brown	Nitrogen

## Female Quick Connect Fitting



- These female quick connect fittings mount within the overhead service panel and provide the attachment point for the quick connect fittings from the workstation system to the building services.
- All fittings include 3/8" stems and hardware to be attached to the overhead service panel.
- All fitting types are keyed to ensure that they couple only with one of the same service.

Part Number	Color	Service
TSPSQC-A	Orange	Air
TSPSQC-V	Yellow	Vacuum
TSPSQC-N	Brown	Nitrogen

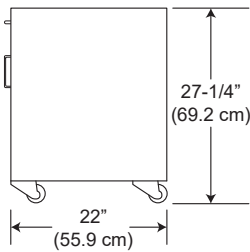

## CornerStone Mobile Cabinet

- Order work surfaces separately
- Provided without locks
- 27 1/4" Tall and 22" Deep
- Standard Color: Pearl White
- Cabinets include 4 each heavy duty 3" casters, the front 2 casters are locking
- Drawer interlock system included and counter weighted anti-tip design.

## Combination Cabinets

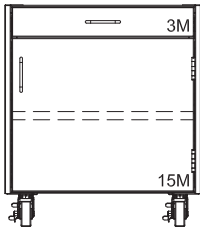

## Drawer Cabinets

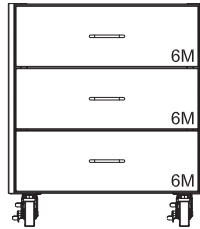

Right Hinged	
TSJTP1068-18	18" W (45.7 cm)
TSJTP1068-24	24" W (61 cm)

TSJTP1072-18	18" W (45.7 cm)
TSJTP1072-24	24" W (61 cm)

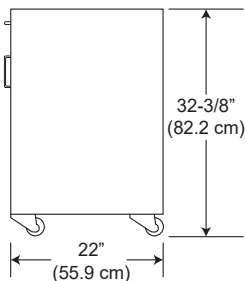

## CornerStone Mobile Cabinet

- Order work surfaces separately
- Provided without locks
- 32 3/8" Tall and 22" Deep
- Standard Color: Pearl White
- Cabinets include 4 each heavy duty 3" casters, the front 2 casters are locking
- Drawer interlock system included and counter weighted anti-tip design.

## Combination Cabinets

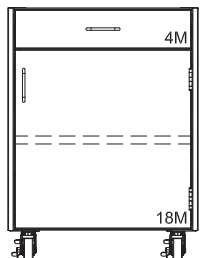

## Drawer Cabinets

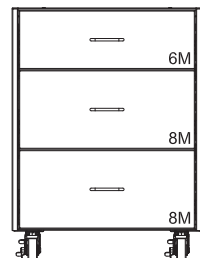

Right Hinged	
TSJTP1018-18	18" W (45.7 cm)
TSJTP1018-24	24" W (61 cm)

TSJTP1021-18	18" W (45.7 cm)
TSJTP1021-24	24" W (61 cm)



## Patriot Table Accessories

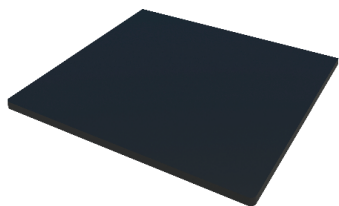

### Mobile Cabinet Work Surface

- Work surface is 3/4" thick black phenolic resin that provide a 1" overhang on the front and a 1/2" overhang at the rear and sides.
- It adds 3/4" to the overall height of the cabinet.
- There is a grip notch included under the front edge of the work surface to help maneuver cabinet

Part Number	For use with:
TSMWS-18	18" (45.7 cm) wide mobile cabinet
TSMWS-24	24" (61 cm) wide mobile cabinet

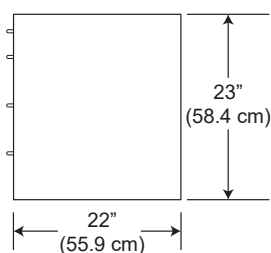

### CornerStone Suspended Cabinet

- 23" Tall and 22" Deep
- Standard Color: Pearl White
- Designed to be hung from an **INSTOCK**® table
- Each suspended cabinet is furnished with complete hanging hardware.

### Drawer Cabinets

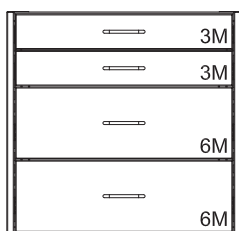

TSJTP820-18	18" W (45.7 cm)
TSJTP820-24	24" W (61 cm)

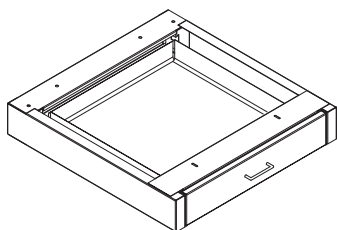

TSPPD1822	18" W (45.7 cm)
-----------	-----------------

### CornerStone Suspended Pencil Drawer

- 3 7/8" Tall and 22" Deep
- Standard Color: Pearl White
- Designed to be hung from an **INSTOCK** table
- Each suspended cabinet is furnished with complete hanging hardware.

## Heavy Duty Steel Tables



Our Heavy Duty Steel Table is one of the most common tables used in laboratory settings and is typically located along the perimeter of a lab. It provides a sturdy and stable platform for your most critical work. It has a fully welded construction and is offered in fixed as well as adjustable heights.

# Heavy Duty Steel Tables



## Fixed Height Heavy Duty Steel Table with Leveling Glides

- Fixed Height Heavy Duty Steel Table with Leveling Glides comes with leveling glides that have a 1/2" stem and 1 3/4" foot.
- Work surface options are 1" black epoxy or 1" black phenolic.
- Steel frame color: Pearl White.
- All fixed height table with leveling glides are rated for 2000 lbs. U.D.L.

Part Number		Dimensions W x D x H
Epoxy Top	Phenolic Top	
TSHD-4824-FE	TSHD-4824-FP	48" x 24" x 36" (121.9 x 61 x 91.4 cm)
TSHD-6024-FE	TSHD-6024-FP	60" x 24" x 36" (152.4 x 61 x 91.4 cm)
TSHD-7224-FE	TSHD-7224-FP	72" x 24" x 36" (182.9 x 61 x 91.4 cm)
TSHD-8424-FE	TSHD-8424-FP	84" x 24" x 36" (213.4 x 61 x 91.4 cm)
TSHD-9624-FE	TSHD-9624-FP	96" x 24" x 36" (243.8 x 61 x 91.4 cm)
TSHD-4830-FE	TSHD-4830-FP	48" x 30" x 36" (121.9 x 76.2 x 91.4 cm)
TSHD-6030-FE	TSHD-6030-FP	60" x 30" x 36" (152.4 x 76.2 x 91.4 cm)
TSHD-7230-FE	TSHD-7230-FP	72" x 30" x 36" (182.9 x 76.2 x 91.4 cm)
TSHD-8430-FE	TSHD-8430-FP	84" x 30" x 36" (213.4 x 76.2 x 91.4 cm)
TSHD-9630-FE	TSHD-9630-FP	96" x 30" x 36" (243.8 x 76.2 x 91.4 cm)

# Heavy Duty Steel Tables



## Fixed Height Heavy Duty Steel Table with Swivel Casters

- Fixed Height Heavy Duty Steel Table with Swivel Casters comes with locking swivel casters.
- Work surface options are 1" black epoxy or 1" black phenolic.
- Steel frame color: Pearl White.
- All fixed height table with swivel casters are rated for 960 lbs. U.D.L.

Part Number		Dimensions W x D x H
Epoxy Top	Phenolic Top	
TSHD-4824-CFE	TSHD-4824-CFP	48" x 24" x 36" (121.9 x 61 x 91.4 cm)
TSHD-6024-CFE	TSHD-6024-CFP	60" x 24" x 36" (152.4 x 61 x 91.4 cm)
TSHD-7224-CFE	TSHD-7224-CFP	72" x 24" x 36" (182.9 x 61 x 91.4 cm)
TSHD-8424-CFE	TSHD-8424-CFP	84" x 24" x 36" (213.4 x 61 x 91.4 cm)
TSHD-9624-CFE	TSHD-9624-CFP	96" x 24" x 36" (243.8 x 61 x 91.4 cm)
TSHD-4830-CFE	TSHD-4830-CFP	48" x 30" x 36" (121.9 x 76.2 x 91.4 cm)
TSHD-6030-CFE	TSHD-6030-CFP	60" x 30" x 36" (152.4 x 76.2 x 91.4 cm)
TSHD-7230-CFE	TSHD-7230-CFP	72" x 30" x 36" (182.9 x 76.2 x 91.4 cm)
TSHD-8430-CFE	TSHD-8430-CFP	84" x 30" x 36" (213.4 x 76.2 x 91.4 cm)
TSHD-9630-CFE	TSHD-9630-CFP	96" x 30" x 36" (243.8 x 76.2 x 91.4 cm)

# Heavy Duty Steel Tables



## Fixed Height Heavy Duty Steel Table with Vibration Isolation Casters

- Fixed Height Heavy Duty Steel Table with Vibration Isolation Casters comes with extra heavy duty vibration isolation locking, swivel casters that have a ratchet style leveling function.
- Work surface options are 1" black epoxy or 1" black phenolic.
- Steel frame color: Pearl White.
- All fixed height table with vibration isolation casters are rated for 2000 lbs. U.D.L.

Part Number		Dimensions W x D x H
Epoxy Top	Phenolic Top	
TSHD-4824-HCFE	TSHD-4824-HCFP	48" x 24" x 36" (121.9 x 61 x 91.4 cm)
TSHD-6024-HCFE	TSHD-6024-HCFP	60" x 24" x 36" (152.4 x 61 x 91.4 cm)
TSHD-7224-HCFE	TSHD-7224-HCFP	72" x 24" x 36" (182.9 x 61 x 91.4 cm)
TSHD-8424-HCFE	TSHD-8424-HCFP	84" x 24" x 36" (213.4 x 61 x 91.4 cm)
TSHD-9624-HCFE	TSHD-9624-HCFP	96" x 24" x 36" (243.8 x 61 x 91.4 cm)
TSHD-4830-HCFE	TSHD-4830-HCFP	48" x 30" x 36" (121.9 x 76.2 x 91.4 cm)
TSHD-6030-HCFE	TSHD-6030-HCFP	60" x 30" x 36" (152.4 x 76.2 x 91.4 cm)
TSHD-7230-HCFE	TSHD-7230-HCFP	72" x 30" x 36" (182.9 x 76.2 x 91.4 cm)
TSHD-8430-HCFE	TSHD-8430-HCFP	84" x 30" x 36" (213.4 x 76.2 x 91.4 cm)
TSHD-9630-HCFE	TSHD-9630-HCFP	96" x 30" x 36" (243.8 x 76.2 x 91.4 cm)



# Heavy Duty Steel Tables



## Adjustable Height Heavy Duty Steel Table with Leveling Glides

- Adjustable Height Heavy Duty Steel Table with Leveling Glides comes with leveling glides that have a 1/2" stem and 1 3/4" foot.
- Mechanical bolt and snap pin adjustment.
- Work surface options are 1" black epoxy or 1" black phenolic.
- Steel frame color: Pearl White.
- All adjustable height tables with leveling glides are rated for 2000 lbs. U.D.L.

Part Number		Dimensions W x D x H
Epoxy Top	Phenolic Top	
TSHD-4824-AE	TSHD-4824-AP	48" x 24" x 30"-36" (121.9 x 61 x 76.2-91.4 cm)
TSHD-6024-AE	TSHD-6024-AP	60" x 24" x 30"-36" (152.4 x 61 x 76.2-91.4 cm)
TSHD-7224-AE	TSHD-7224-AP	72" x 24" x 30"-36" (182.9 x 61 x 76.2-91.4 cm)
TSHD-8424-AE	TSHD-8424-AP	84" x 24" x 30"-36" (213.4 x 61 x 76.2-91.4 cm)
TSHD-9624-AE	TSHD-9624-AP	96" x 24" x 30"-36" (243.8 x 61 x 76.2-91.4 cm)
TSHD-4830-AE	TSHD-4830-AP	48" x 30" x 30"-36" (121.9 x 76.2 x 76.2-91.4 cm)
TSHD-6030-AE	TSHD-6030-AP	60" x 30" x 30"-36" (152.4 x 76.2 x 76.2-91.4 cm)
TSHD-7230-AE	TSHD-7230-AP	72" x 30" x 30"-36" (182.9 x 76.2 x 76.2-91.4 cm)
TSHD-8430-AE	TSHD-8430-AP	84" x 30" x 30"-36" (213.4 x 76.2 x 76.2-91.4 cm)
TSHD-9630-AE	TSHD-9630-AP	96" x 30" x 30"-36" (243.8 x 76.2 x 76.2-91.4 cm)

# Heavy Duty Steel Tables



## Adjustable Height Heavy Duty Steel Table with Swivel Casters

- Adjustable Height Heavy Duty Steel Table with Swivel Casters comes with locking swivel casters.
- Mechanical bolt and snap pin adjustment.
- Work surface options are 1" black epoxy or 1" black phenolic.
- Steel frame color: Pearl White.
- All adjustable height tables with swivel casters are rated for 960 lbs. U.D.L.

Part Number		Dimensions W x D x H
Epoxy Top	Phenolic Top	
TSHD-4824-CAE	TSHD-4824-CAP	48" x 24" x 30"-36" (121.9 x 61 x 76.2-91.4 cm)
TSHD-6024-CAE	TSHD-6024-CAP	60" x 24" x 30"-36" (152.4 x 61 x 76.2-91.4 cm)
TSHD-7224-CAE	TSHD-7224-CAP	72" x 24" x 30"-36" (182.9 x 61 x 76.2-91.4 cm)
TSHD-8424-CAE	TSHD-8424-CAP	84" x 24" x 30"-36" (213.4 x 61 x 76.2-91.4 cm)
TSHD-9624-CAE	TSHD-9624-CAP	96" x 24" x 30"-36" (243.8 x 61 x 76.2-91.4 cm)
TSHD-4830-CAE	TSHD-4830-CAP	48" x 30" x 30"-36" (121.9 x 76.2 x 76.2-91.4 cm)
TSHD-6030-CAE	TSHD-6030-CAP	60" x 30" x 30"-36" (152.4 x 76.2 x 76.2-91.4 cm)
TSHD-7230-CAE	TSHD-7230-CAP	72" x 30" x 30"-36" (182.9 x 76.2 x 76.2-91.4 cm)
TSHD-8430-CAE	TSHD-8430-CAP	84" x 30" x 30"-36" (213.4 x 76.2 x 76.2-91.4 cm)
TSHD-9630-CAE	TSHD-9630-CAP	96" x 30" x 30"-36" (243.8 x 76.2 x 76.2-91.4 cm)

# Heavy Duty Steel Tables



## Adjustable Height Heavy Duty Steel Table with Vibration Isolation Casters

- Adjustable Height Heavy Duty Steel Table with Vibration Isolation Casters comes with extra heavy duty vibration isolation locking, swivel casters that have a ratchet style leveling function.
- Mechanical bolt and snap pin adjustment.
- Work surface options are 1" black epoxy or 1" black phenolic.
- Steel frame color: Pearl White.
- All adjustable height tables with swivel casters are rated for 2000 lbs. U.D.L.

Part Number		Dimensions W x D x H
Epoxy Top	Phenolic Top	
TSHD-4824-HCAE	TSHD-4824-HCAP	48" x 24" x 30"-36" (121.9 x 61 x 76.2-91.4 cm)
TSHD-6024-HCAE	TSHD-6024-HCAP	60" x 24" x 30"-36" (152.4 x 61 x 76.2-91.4 cm)
TSHD-7224-HCAE	TSHD-7224-HCAP	72" x 24" x 30"-36" (182.9 x 61 x 76.2-91.4 cm)
TSHD-8424-HCAE	TSHD-8424-HCAP	84" x 24" x 30"-36" (213.4 x 61 x 76.2-91.4 cm)
TSHD-9624-HCAE	TSHD-9624-HCAP	96" x 24" x 30"-36" (243.8 x 61 x 76.2-91.4 cm)
TSHD-4830-HCAE	TSHD-4830-HCAP	48" x 30" x 30"-36" (121.9 x 76.2 x 76.2-91.4 cm)
TSHD-6030-HCAE	TSHD-6030-HCAP	60" x 30" x 30"-36" (152.4 x 76.2 x 76.2-91.4 cm)
TSHD-7230-HCAE	TSHD-7230-HCAP	72" x 30" x 30"-36" (182.9 x 76.2 x 76.2-91.4 cm)
TSHD-8430-HCAE	TSHD-8430-HCAP	84" x 30" x 30"-36" (213.4 x 76.2 x 76.2-91.4 cm)
TSHD-9630-HCAE	TSHD-9630-HCAP	96" x 30" x 30"-36" (243.8 x 76.2 x 76.2-91.4 cm)

# Heavy Duty Steel Table Accessories

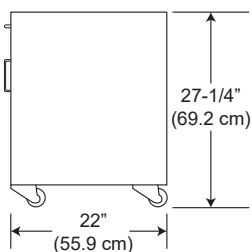

## CornerStone Mobile Cabinet

- Order work surfaces separately
- Provided without locks
- 27 1/4" Tall and 22" Deep
- Standard Color: Pearl White
- Cabinets include 4 each heavy duty 3" casters, the front 2 casters are locking
- Drawer interlock system included and counter weighted anti-tip design.

## Combination Cabinets

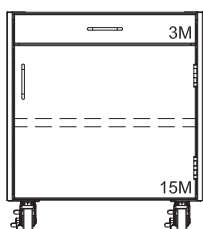

## Drawer Cabinets

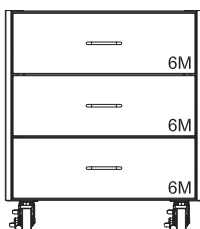

### Right Hinged

TSJTP1068-18	18" W (45.7 cm)
TSJTP1068-24	24" W (61 cm)

TSJTP1072-18	18" W (45.7 cm)
TSJTP1072-24	24" W (61 cm)

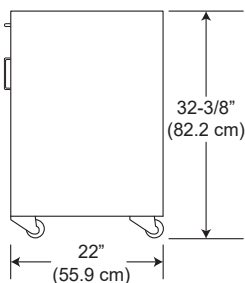

## CornerStone Mobile Cabinet

- Order work surfaces separately
- Provided without locks
- 32 3/8" Tall and 22" Deep
- Standard Color: Pearl White
- Cabinets include 4 each heavy duty 3" casters, the front 2 casters are locking
- Drawer interlock system included and counter weighted anti-tip design.

## Combination Cabinets

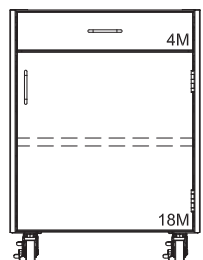

## Drawer Cabinets

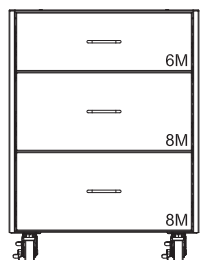

### Right Hinged

TSJTP1018-18	18" W (45.7 cm)
TSJTP1018-24	24" W (61 cm)

TSJTP1021-18	18" W (45.7 cm)
TSJTP1021-24	24" W (61 cm)



# Heavy Duty Steel Table Accessories

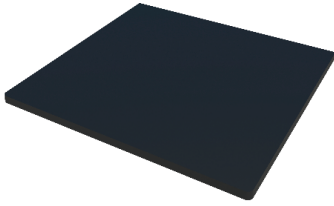

## Mobile Cabinet Work Surface

- Work surface is 3/4" thick black phenolic resin that provide a 1" overhang on the front and a 1/2" overhang at the rear and sides.
- It adds 3/4" to the overall height of the cabinet.
- There is a grip notch included under the front edge of the work surface to help maneuver cabinet

Part Number	For use with:
TSMWS-18	18" (45.7 cm) wide mobile cabinet
TSMWS-24	24" (61 cm) wide mobile cabinet

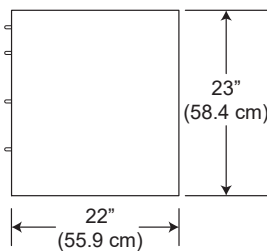

## CornerStone Suspended Cabinet

- 23" Tall and 22" Deep
- Standard Color: Pearl White
- Designed to be hung from an **INSTOCK**® table
- Each suspended cabinet is furnished with complete hanging hardware.

## Drawer Cabinets

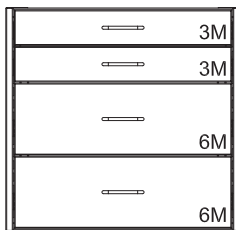

TSJTP820-18	18" W (45.7 cm)
TSJTP820-24	24" W (61 cm)

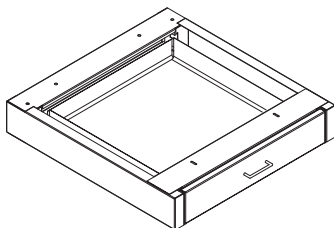

TSPPD1822	18" W (45.7 cm)
-----------	-----------------

## CornerStone Suspended Pencil Drawer

- 3 7/8" Tall and 22" Deep
- Standard Color: Pearl White
- Designed to be hung from an **INSTOCK** table
- Each suspended cabinet is furnished with complete hanging hardware.

# Envision Workstations

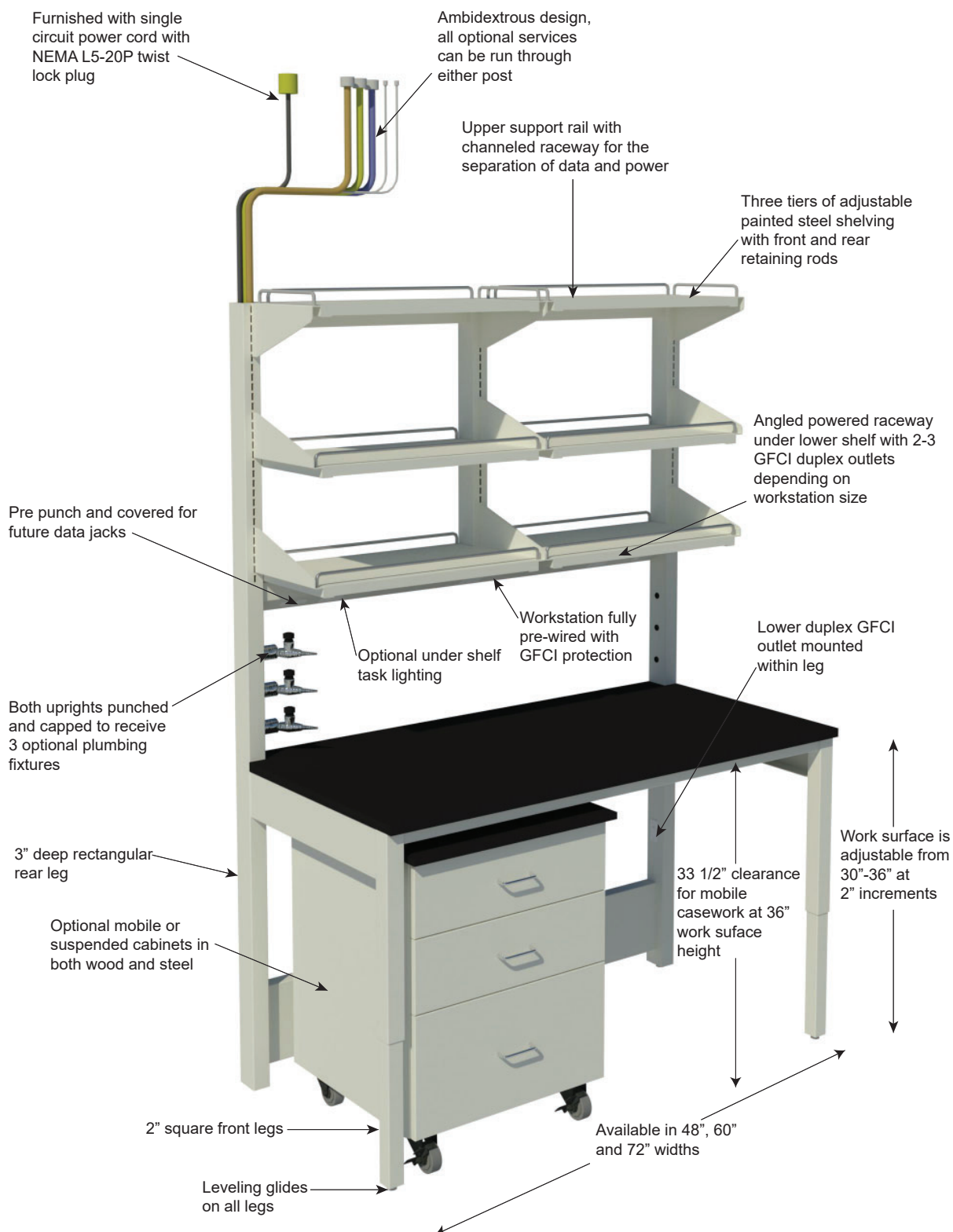

Our Envision Workstation provides plumbed and wired services that are in demand for today's self-contained & feature driven lab workstation. They can be placed in a pod with an overhead service panel or along the perimeter of a lab. An independent back to back design combined with an ambidextrous service layout make this workstation truly adaptable.

## Envision Workstations



- Envision Workstations are 84" tall x 30" deep and are furnished complete with shelving, electrical fixtures and work surfaces.
- Each workstation is provided with one electrical cord to carry power from the top of frame to the overhead service panel. The cords are designed to reach an overhead service carrier at a maximum 48" above the workstation. Each cord has a 125V, 20 amp circuit and includes a twist lock NEMA L5-20P plug.
- Workstations can be outfitted with optional plumbing fixtures and task lighting.
- Each workstation is punched and capped for future data ports.
- Workstations are designed for back to back use for optimal lab layout flexibility.
- The black work surface is adjustable from 30"-36".
- Each workstation includes 3 tiers of 12" deep adjustable steel shelving with front and rear retaining rods.
- The workstations are powder coat painted in Pearl White.

with Epoxy Work Surface	with Phenolic Work Surface	Quantity of Duplex Outlets	Width
TSENO-3048E	TSENO-3048P	3	48" (121.9 cm)



- Envision Workstations are 84" tall x 30" deep and are furnished complete with shelving, electrical fixtures and work surfaces.
- Each workstation is provided with one electrical cord to carry power from the top of frame to the overhead service panel. The cords are designed to reach an overhead service carrier at a maximum 48" above the workstation. Each cord has a 125V, 20 amp circuit and includes a twist lock NEMA L5-20P plug.
- Workstations can be outfitted with optional plumbing fixtures and task lighting.
- Each workstation is punched and capped for future data ports.
- Workstations are designed for back to back use for optimal lab layout flexibility.
- The black work surface is adjustable from 30"-36".
- Each workstation includes 3 tiers of 12" deep adjustable steel shelving with front and rear retaining rods.
- The workstations are powder coat painted in Pearl White.

with Epoxy Work Surface	with Phenolic Work Surface	Quantity of Duplex Outlets	Width
TSENO-3060E	TSENO-3060P	4	60" (152.4 cm)
TSENO-3072E	TSENO-3072P	4	72" (182.9 cm)

# Envision Workstations

## Complete Plumbing Assemblies



Envision Workstation Complete Plumbing Assemblies include a fine control needle valve service turret with shank, a service hose, and a male quick connect fitting. These complete assemblies are designed specifically for use with our workstations in a laboratory environment. All quick connects have 316 stainless steel internal components. Keyed quick connect members will only couple with components of the same key which are identified by a color code. Assemblies consist of 2 major components and are shipped loose to be installed on site.

The service hoses carry services from the overhead service panel, through the upright of the table and to the shank of the fixture. They consist of color coded reinforced PVC 1/4" hose. Air and Nitrogen male quick connects have double end shut off plugs and have an internal valve that shuts off flow when un-coupled. Vacuum has a single end shut off plug and does not have an internal valve. The needle control valve is a 135 degree turret with one polished chrome valve with a brass floating cone and integral brass seat. They provide metering control of laboratory gases at pressures up to 60 PSI. The turret shank is bored for the connection of the service hose.

Service	Color	Left Side Assemblies	Right Side Assemblies
Air	Orange	TSEISV-A-L	TSEISV-A-R
Vacuum	Yellow	TSEISV-V-L	TSEISV-V-R
Nitrogen	Brown	TSEISV-N-L	TSEISV-N-R

## Female Quick Connect Fittings



- These female quick disconnect fittings mount within the overhead service panel and connect the quick disconnect fittings from the table system to the building services.
- All fittings include 3/8" stems and hardware to attach to the overhead service panel.
- All fitting types are "keyed" to ensure that they couple only with one of the same service.

Service	Color	Part Number
Air	Orange	TSQCFL-B-3M-K2
Vacuum	Yellow	TSQCFL-B-3M-K4
Nitrogen	Brown	TSQCFL-B-3M-K8

## Overhead Service Panels - Made to Order

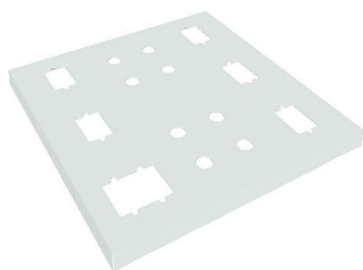

- These painted steel panels are designed to fit into a 24" x 24" ceiling grid.
- They are made to order based upon services required.
- Components are sold separately and shipped loose to be installed on site.
- Standard color: Pearl White

Part Number	Number of Service Cutouts
TSENO SP-10	1-10
TSENO SP-20	11-20

## Twist-to-Lock Electrical for Overhead Service Panel

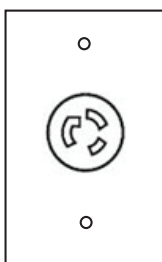

- Includes an electrical box, NEMA 5-20R, 120V, 20 amp twist-to-lock receptacle, and a stainless steel cover plate.
- Components are shipped loose to be installed on site.

Part Number	NEMA Configuration
TSEN-LEV5-20R	5-20R

## Task Lighting for Envision Workstation



- Features multiple, state of the art, energy saving components that include touch and hold continuous dimming and 10-hour automatic turnoff.
- Part number for 48" wide workstations include one LED task light, magnetic angle mount, 60 watt power supply with magnetic mount and 6' white cord.
- Part number for 60" and 72" wide workstations include two LED task lights, magnetic angle mounts, 60 watt power supply with magnetic mount, an 8" interlink cord and 6' white cord.
- Made with anodized aluminum and lasts up to 50,000 hours.

For use with:	Quantity of Lights	Actual Width of Light	Part Number
48" Wide Workstation	1	30.1" (76.5 cm)	TSTLEW-48
60" Wide Workstation	2	20.3" (51.6 cm)	TSTLEW-60
72" Wide Workstation	2	20.3" (51.6 cm)	TSTLEW-72



# Envision Workstations

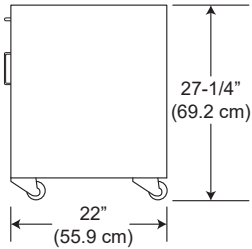

## CornerStone Mobile Cabinet

- Order work surfaces separately
- Provided without locks
- 27 1/4" Tall and 22" Deep
- Standard Color: Pearl White
- Cabinets include 4 each heavy duty 3" casters, the front 2 casters are locking
- Drawer interlock system included and counter weighted anti-tip design.

## Combination Cabinets

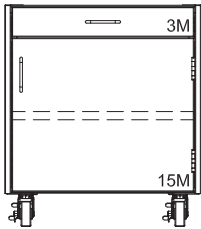

Right Hinged	
TSJTP1068-18	18" W (45.7 cm)
TSJTP1068-24	24" W (61 cm)

## Drawer Cabinets

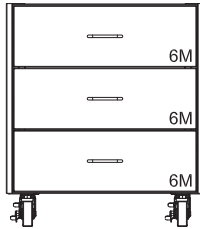

TSJTP1072-18	18" W (45.7 cm)
TSJTP1072-24	24" W (61 cm)

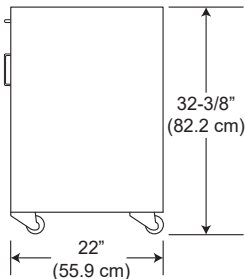

## CornerStone Mobile Cabinet

- Order work surfaces separately
- Provided without locks
- 32 3/8" Tall and 22" Deep
- Standard Color: Pearl White
- Cabinets include 4 each heavy duty 3" casters, the front 2 casters are locking
- Drawer interlock system included and counter weighted anti-tip design.

## Combination Cabinets

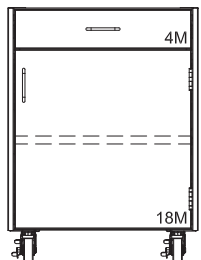

Right Hinged	
TSJTP1018-18	18" W (45.7 cm)
TSJTP1018-24	24" W (61 cm)

## Drawer Cabinets

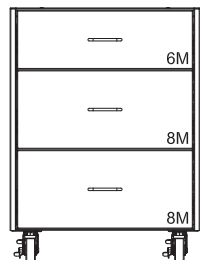

TSJTP1021-18	18" W (45.7 cm)
TSJTP1021-24	24" W (61 cm)

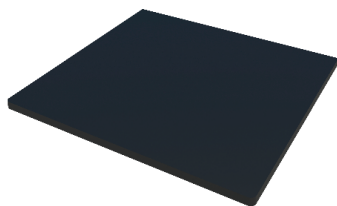

## Mobile Cabinet Work Surface

- Work surface is 3/4" thick black phenolic resin that provide a 1" overhang on the front and a 1/2" overhang at the rear and sides.
- It adds 3/4" to the overall height of the cabinet.
- There is a grip notch included under the front edge of the work surface to help maneuver cabinet

Part Number	For use with:
TSMWS-18	18" (45.7 cm) wide mobile cabinet
TSMWS-24	24" (61 cm) wide mobile cabinet

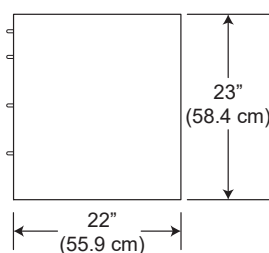

## CornerStone Suspended Cabinet

- 23" Tall and 22" Deep
- Standard Color: Pearl White
- Designed to be hung from an **INSTOCK**® table
- Each suspended cabinet is furnished with complete hanging hardware.

## Drawer Cabinets

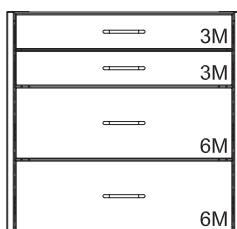

TSJTP820-18	18" W (45.7 cm)
TSJTP820-24	24" W (61 cm)

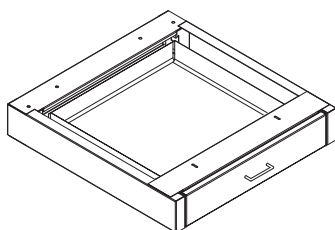

## CornerStone Suspended Pencil Drawer

- 3 7/8" Tall and 22" Deep
- Standard Color: Pearl White
- Designed to be hung from an **INSTOCK** table
- Each suspended cabinet is furnished with complete hanging hardware.

TSPPD1822	18" W (45.7 cm)
-----------	-----------------

## Work Surfaces

### Choose the right lab work surface to complete your project

We offer many work surfaces options, from **INSTOCK**® products to custom fabricated work surfaces. Our **INSTOCK** work surfaces include epoxy resin and phenolic resin tops. These materials can also be special ordered to meet specific size and space requirements. Other materials are available for custom fabrication, including hardwood, and stainless steel.

Work surfaces can be ordered in different depths, with special edge details, with extra high backsplashes, or a variety of cutouts. One of our Furniture Specialists can assist you in selecting the correct work surface material and style to meet your particular needs.

Most black epoxy and phenolic tops can be fabricated within 10 days after receipt of approved drawings. Complete specifications and samples of work surface materials are available from your Furniture Specialist. Delivery of stainless steel or hardwood tops is 7-8 weeks, after receipt of approved drawings.

Material	Appearance and Color	Composition	Chemical Resistance	Applications
Phenolic Resin	Black or Grey, hard, smooth non-glare surface	1" thick cellulose fiber reinforced phenolic resin core with a polyurethane copolymer surface.	Good chemical resistance to wide range of acids, alkalis and solvents	Use wherever a high degree of chemical resistance is required.
Epoxy Resin	Black, smooth non-porous surface	1" thick molded epoxy resin	Good resistance to practically all acids, alkalis and solvents. Highly resistant to heat and normal physical abuse.	Use wherever a high degree of chemical resistance is required.
Stainless Steel	Silver No. 4 finish	1 1/2" thick Type 304 furnished as standard, but other types are available when specified.	Good chemical resistance to a wide range of reagents	Recommended for sterile and radiological laboratories
Hardwood, Oak or Maple	Natural varnish, or penetrating oil finish	2 1/4" thick solid edge grain Maple or Oak strips, glued together electronically, and finished with baked on clear synthetic varnish or penetrating oil.	Marginal chemical resistance, not recommended for use in chemical laboratories	Excellent top material for Physics tables, Electronic benches, and other areas where mechanical or physical work levels are prevalent

## Custom Manufactured Work Surfaces

We offer custom laboratory work surfaces in 1" thick black epoxy and black phenolic. These custom quick ship work surfaces are designed and engineered to suit your specific needs. Use the part numbers below as a reference point. Contact us for assistance.

Black Epoxy	Black Phenolic	Unit
TSCMWSSF-E	TSCMWSSF-P	Per Square Foot
TSCMWSSC-E	TSCMWSSC-P	Sink Cutout
TSCMWSB-E	TSCMWSB-P	Fixture Boring or Cutout

## Work Surfaces without Cutouts

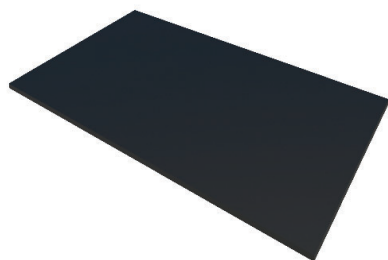

- Chemical resistant black epoxy or phenolic resin
- 1" (2.5 cm) thick
- Curb must be ordered separately
- Front edge finished, all other edges are square

Width	Depth	Epoxy Work Surface	Phenolic Work Surface
36" (91.4 cm)	30" (76.2 cm)	TSLE3630-1	TSLP3630-1
48" (121.9 cm)	30" (76.2 cm)	TSLE4830-1	TSLP4830-1
60" (152.4 cm)	30" (76.2 cm)	TSLE6030-1	TSLP6030-1
72" (182.9 cm)	30" (76.2 cm)	TSLE7230-1	TSLP7230-1
96" (243.8 cm)	30" (76.2 cm)	TSLE9630-1	TSLP9630-1

## Work Surfaces without Cutouts

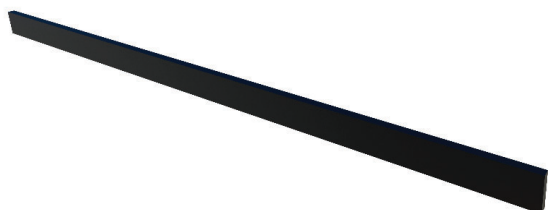

- Cut to fit at job site

Width	Epoxy Work Surface	Phenolic Work Surface
96" (243.8 cm)	TSLE9604-1	TSLP9604-1

# Faucets

## Mixing Faucets

- Mixing faucets are deck-mounted and have an option for a vacuum breaker
- They come with four-arm or blade handles
- They are chrome plated brass with an 8" swivel gooseneck
- Valves are self-contained units with replaceable stainless steel seats

### Four-arm Handle with Vacuum Breaker



Part Number	Type
TSL412-8VB	Four-arm handle with vacuum breaker

### Four-arm Handle without Vacuum Breaker

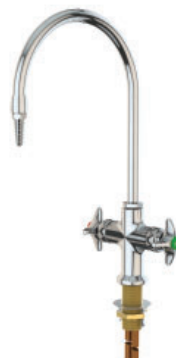

Part Number	Type
TSL412-8	Four-arm handle without vacuum breaker

### Blade Handle with Vacuum Breaker



Part Number	Type
TSL412-8VB-BH	Blade handle with vacuum breaker

### Blade Handle without Vacuum Breaker



Part Number	Type
TSL412-8-BH	Blade handle without vacuum breaker



## Cold Water Faucets

- Cold water faucets are deck-mounted and have an option for a vacuum breaker.
- They come with a four arm or blade handle
- They are chrome plated brass with an 8" swivel gooseneck
- Valves are self-contained units with replaceable stainless steel seats

### Four-arm Handle with Vacuum Breaker



Part Number	Type
TSL611-8VB	Four-arm handle with vacuum breaker

### Four-arm Handle without Vacuum Breaker



Part Number	Type
TSL611-8	Four-arm handle without vacuum breaker

### Blade Handle with Vacuum Breaker



Part Number	Type
TSL611-8VB-BH	Blade handle with vacuum breaker

### Blade Handle without Vacuum Breaker



Part Number	Type
TSL611-8-BH	Blade handle without vacuum breaker

# Faucets

## Foot Operated Faucet



- Foot operated faucet is deck mounted with a vacuum breaker.
- Faucet is chrome plated brass with 8" swivel gooseneck.
- Valves are self-contained units with replaceable stainless steel seats.
- Faucet has a floor mounted foot operated valve.

Part Number	Type
TSL084-3001-BH	Foot operated with vacuum breaker

## DI/RO Faucet



- DI/RO faucet is deck mounted for distilled, deionized or reverse osmosis water.
- Faucet with a 6" spread and has exterior brass casing and interior lining of inert polypropylene.
- Faucet has a diaphragm-type valve.
- The handle is a nylon toggle-style lever and a combination manual/self-closing

Part Number	Type
TSL7833MSC	DI/RO

## Aerator



- This aerator is 3/8" NPS male inlet.
- It replaces a serrated hose end and most faucets.

Part Number	Type
TSBO055	Aerator

## Laboratory Ball Valves

- Laboratory Ball Valves are deck mounted turret base
- They are chrome plated brass
- It is quarter-turn open/close.
- The lever is forged brass with color-coded index button/cap.

### One Turret



Part Number	Service
TSL4200131WSAG	Gas
TSL4200131WSAA	Air
TSL4200131WSAN	Nitrogen
TSL4200131WSAV	Vacuum

### Two Turrets, 90°

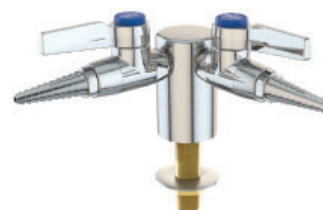

Part Number	Service
TSL4200132AWSAG	Gas
TSL4200132AWSAA	Air
TSL4200132AWSAN	Nitrogen
TSL4200132AWSAV	Vacuum

### Two Turrets, 180°



Part Number	Service
TSL4200132SWSAG	Gas
TSL4200132SWSAA	Air
TSL4200132SWSAN	Nitrogen
TSL4200132SWSAV	Vacuum

### Four Turrets



Part Number	Service
TSL4200134WSAG	Gas
TSL4200134WSAA	Air
TSL4200134WSAN	Nitrogen
TSL4200134WSAV	Vacuum

# Service Valves

## Laboratory Needle Valves

- Laboratory needle valves are deck mounted turret base.
- They are straight pattern forged brass.
- It has a floating stainless steel needle and replaceable stainless steel seat.
- The handle is a four-arm handle with a color coded index button/cap.

### One Turret



Part Number	Service
TSL2880131WSAG	Gas
TSL2880131WSAA	Air
TSL2880131WSAN	Nitrogen
TSL2880131WSAV	Vacuum

### Two Turrets, 90°



Part Number	Service
TSL2880132AWSAG	Gas
TSL2880132AWSAA	Air
TSL2880132AWSAN	Nitrogen
TSL2880132AWSAV	Vacuum

### Two Turrets, 180°



Part Number	Service
TSL2880132SWSAG	Gas
TSL2880132SWSAA	Air
TSL2880132SWSAN	Nitrogen
TSL2880132SWSAV	Vacuum

### Four Turrets

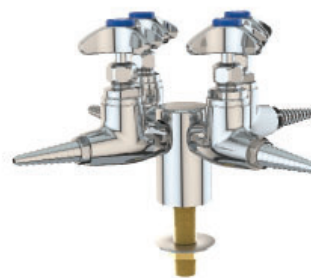

Part Number	Service
TSL2880134WSAG	Gas
TSL2880134WSAA	Air
TSL2880134WSAN	Nitrogen
TSL2880134WSAV	Vacuum

## Eyewash



- Eyewash mounts on counter next to a sink.
- It swivels 90°
- Water flow is activated by flag handle.
- Each head has a flip open dust cover.
- The eyewash is chrome plated brass.

Part Number	Type
TSEW806	Right Hand Mounting
TSEW806LH	Left Hand Mounting

## Low Profile Eyewash



- Eyewash mounts on counter next to a sink.
- It swivels 90°
- Water flow is activated by swinging the spray head over sink.
- Each head has a flip open dust cover.
- The eyewash is chrome plated brass.

Part Number	Type
TSEW805	Right Hand Mounting
TSEW805LH	Left Hand Mounting

## Eyewash/Drench Hose



- Deck mounted dual purpose eyewash/drench hose.
- Water flow is activated by stainless steel lever handle.
- A back flow preventer is included on the inlet of the supply hose.
- Each head has a flip open dust cover.

Part Number	Type
TSEW1022BP	Eyewash/Drench Hose



# Drench Shower/Eyewash Stations

## Drench Shower/Eyewash



- Free-standing drench shower made of orange ABS plastic.
- Ball valve operated by a rigid pull rod and easy grip handle.
- Eyewash fixture with stainless steel bowl is provided with four gentle spray heads and a "Push to Operate" ball valve.
- Eyewash and shower operated independently.
- Overall height is 80"

Part Number	Type
TSSS909	Drench Shower/Eyewash

## ADA Drench Shower/Eyewash



- Free-standing drench shower made of orange ABS plastic.
- Ball valve operated by a rigid pull rod and easy grip handle.
- Eye wash fixture with stainless steel bowl is provided with four gentle spray heads and a "Push to Operate" ball valve.
- Eyewash and shower operated independently.
- Overall height is 80".
- Unit complies with ADA requirements for accessibility by handicapped persons (maximum height and reach, minimum knee clearance and distance from obstructions).

Part Number	Type
TSSSBF909	Drench Shower

## Drench Shower



- Emergency shower head assembly is wall mounted.
- It includes a 10" diameter orange ABS plastic shower head.
- Operated by a rigid pull-rod and easy to grip handle.

Part Number	Type
TSES643	Drench Shower

## Stainless Steel Pegboard

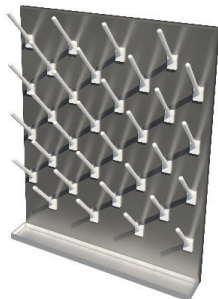

- This pegboard is made of Type 304 stainless steel pegboard with 1/2" diameter, 6" long white polypropylene pegs
- Pegboard is 30" tall and is furnished with a 4" wide stainless steel drip trough and clear plastic drain tube.

Part Number	Number of Pegs	Dimensions
TSV2430	32	24" W x 30" H (61 x 76.2 cm)
TSV3630	60	36" W x 30" H (91.4 x 76.2 cm)
<b>with Finished Back</b>		
TSV2430FB	32	24" W x 30" H (61 x 76.2 cm)
TSV3630FB	60	36" W x 30" H (91.4 x 76.2 cm)

## Phenolic Resin Pegboard



- This pegboard is made of black phenolic resin with 6" long black polypropylene pegs and a finished back.
- Pegboard is 30" tall and is furnished with a 4" wide stainless steel drip trough and clear plastic drain tube.

Part Number	Number of Pegs	Dimensions
TSPB-PR2430	39	24" W x 30" H (61 x 76.2 cm)
TSPB-PR3030	46	30" W x 30" H (76.2 x 76.2 cm)

# Sinks

## Drop-In Epoxy Resin Sinks

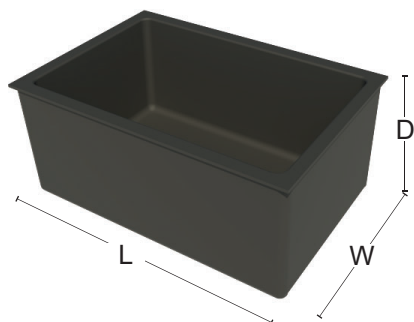

- These durable black epoxy sinks are chemically resistant, come with coved corners and are pitched to a corner or center drain.
- All tub sinks are furnished complete with a tail piece and strainer.
- Drop in sinks can be converted to be undermount sinks, however cabinet sink supports will be required.

Part Number	Dimensions (L x W x D)	Outlet
TSD-30	18" x 15" x 11" (45.7 x 38.1 x 27.9 cm)	Center
TSD-50	24" x 16" x 8" (61 x 40.6 x 20.3 cm)	Center
TSD-55	25" x 15" x 10" (63.5 x 38.1 x 25.4 cm)	Corner
TSD-59	28" x 15" x 11.8" (71.1 x 38.1 x 30 cm)	Corner
TSA-55 (ADA Sink)	25" x 15" x 4.8" (63.5 x 38.1 x 12.2 cm)	Corner

## Cup Sink



- This cup sink is of black polypropylene construction.
- Sink is a drop in and includes strainer, cap and drain pipe.

Part Number	Dimensions (L x W x D)	Outlet
TSLB-U04	6" x 3" x 3.7" (15.2 x 7.6 x 9.4 cm)	Center

### Drop-In Stainless Steel Sinks



- These stainless steel sinks are of a seamless die-drawn construction of 18 gauge, Type 304 stainless steel.
- Interior surfaces are polished to a non-porous finish.
- The underside is fully coated and insulated for sound deadening and reduced condensation.
- Self-rimming top mount with stainless steel mounting channels.
- The sink bottoms are pitched to a center drain.
- Crumb strainer and tail piece included.

Part Number	Dimensions (L x W x D)
TSS-1721-A-GR	21" x 17" x 7.5" (53.3 x 43.2 x 19.1 cm)
TSS-1925-A-GR	25" x 19" x 7.5" (63.5 x 48.3 x 19.1 cm)
TSSX-1925-A-GR	25" x 19" x 10.5" (63.5 x 48.3 x 26.7 cm)

### Undermount Stainless Steel



- These stainless steel sinks are of a seamless die-drawn construction of 18 gauge, Type 304 stainless steel.
- Interior surfaces are polished to a non-porous finish.
- The underside is fully coated and insulated for sound deadening and reduced condensation.
- The sink bottoms are pitched to a center drain.
- Crumb strainer and tail piece included.
- Sink support required and ordered separately.

Part Number	Dimensions (L x W x D)
TSUSX-1618-A	18" x 16" x 10.5" (45.7 x 40.6 x 26.7 cm)
TSUS-1824-A	24" x 18" x 7.5" (61 x 45.7 x 19.1 cm)
TSUSX-1824-A	24" x 18" x 10.5" (61 x 45.7 x 26.7 cm)
TSUSX-1830-A	30" x 18" x 10.5" (76.2 x 45.7 x 26.7 cm)

# Electrical Pedestals

## Single Gang Electrical Pedestal



- This unit is single gang, double faced.
- It is 120 V and 20 amp.
- Supplied with black outlets and stainless steel cover plates.
- The box is cast aluminum and is powder coated with a black textured epoxy finish.

Part Number	Type
TSE433WS	Standard Outlets
TSE433WS-GFI	GFI Outlets

## Double Gang Electrical Pedestal



- This unit is double gang, double faced.
- It is 120 V and 20 amp.
- Supplied with black outlets and stainless steel cover plates.
- The box is cast aluminum and is powder coated with a black textured epoxy finish.

Part Number	Type
TSE633WS	Standard Outlets
TSE633WS-GFI	GFI Outlets

## Custom Electrical Pedestal

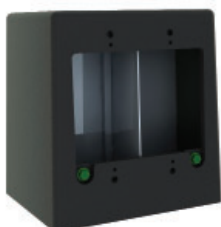

- This electrical pedestal is double faced and can accommodate a variety of styles and configurations.
- As many as 4 duplex outlets can be installed.
- The chambered design minimizes RF interference when combining electrical and data outlets in this fixture.
- Outlets and cover plates supplied separately.
- The box is cast aluminum and is powder coated with a black textured epoxy finish.

Part Number	Type
TSE800WS	Custom



## Customizable Seating

Select from thousands of seating options, including chairs specifically designed for laboratory, clean room and ESD applications. Select the height, materials, features and colors that are most appropriate for your specific tasks or environment. Ergonomics are critical, so our chairs and stools are designed to allow user to make adjustments to seats and backs and to add arms and foot rings where appropriate to provide optimal comfort and support.

### Laboratory



### Industrial



Visit our chair configurator

[SEATING.INSTOCKLABS.COM](https://seating.instocklabs.com)

Build the seat that is right for you

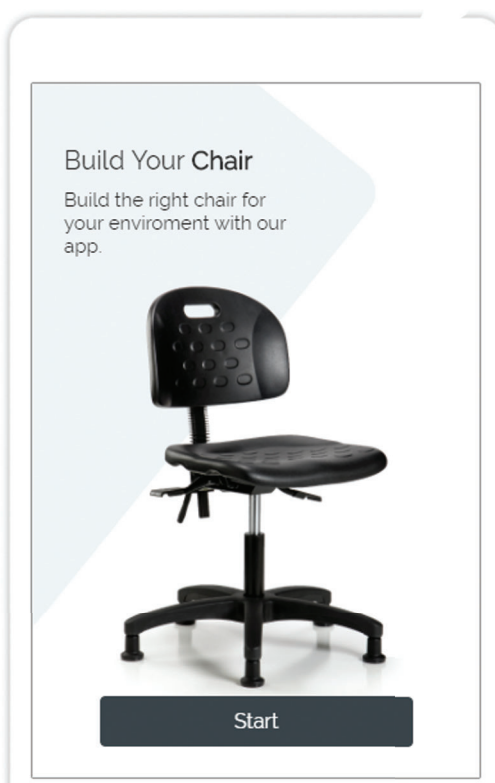

# Seating

## Vinyl Chair - Desk Height



Shown in Burgundy

- Designed for use at desks that are 31" tall or under
- 19"-24" Adjustable height, measured from the top of the seat to the floor.
- Medium back height of 18"
- Highly durable molded polyurethane foam cushioning covered with easily cleaned antibacterial/antimicrobial vinyl.
- Black, non-marring casters suitable for both hard and carpeted floors
- 25" wide 5-leg nylon reinforced fiberglass base
- Weight capacity of 300 lbs.
- Does not include a foot ring.

Part Number	Vinyl Color
TSVDCMBRC8546	Blue
TSVDCMBRC8605	Gray
TSVDCMBRC8540	Black
TSVDCMBRC8569	Burgundy
TSVDCMBRC8582	Navy

**Arm rests can be added to the model by including "A1" at the end of the part number**

## Polyurethane Chair - Desk Height



- Designed for use at desks that are 31" tall or under
- 17"-22" Adjustable height, measured from the top of the seat to the floor
- Standard back height of 10-1/4"
- Rugged polyurethane that is self-skinning, chemical- and puncture-resistant, easily cleaned, and soil resistant
- Black, non-marring casters suitable for both hard and carpeted floors
- 25" wide 5-leg nylon reinforced fiberglass base
- Weight capacity of 300 lbs.
- Does not include a foot ring

Part Number	Vinyl Color
TSPDHCH-RC	Black

**Arm rests can be added to the model by including "A1" at the end of the part number**

## Vinyl Stool - Desk Height



Shown in Blue

- Designed for use at desks that are 31" tall or under
- 18"-23" Adjustable height, measured from the top of the seat to the floor
- Backless stool
- Highly durable molded polyurethane foam cushioning covered with easily cleaned antibacterial/antimicrobial vinyl.
- Black, non-marring casters suitable for both hard and carpeted floors
- 25" wide 5-leg nylon reinforced fiberglass base
- Weight capacity of 300 lbs.
- Does not include foot ring

Part Number	Vinyl Color
TSVDHSORGRC8546	Blue
TSVDHSORGRC8605	Gray
TSVDHSORGRC8540	Black
TSVDHSORGRC8569	Burgundy
TSVDHSORGRC8582	Navy

**Vinyl Chair - Medium Height**

Shown in Blue

- Designed for use at work surfaces that are 32" - 36" tall
- 22"-29" Adjustable height, measured from the top of the seat to the floor
- Standard back height of 11-1/2"
- Highly durable molded polyurethane foam cushioning covered with easily cleaned antibacterial/antimicrobial vinyl.
- Black, non-marring casters suitable for both hard and carpeted floors
- 25" wide 5-leg nylon reinforced fiberglass base
- Weight capacity of 300 lbs.
- Includes 20" diameter chrome foot ring

Part Number	Vinyl Color
TSVMCCFRC8546	Blue
TSVMCCFRC8605	Gray
TSVMCCFRC8540	Black
TSVMCCFRC8569	Burgundy
TSVMCCFRC8582	Navy

**Arm rests can be added to the model by including "A1" at the end of the part number**

**Polyurethane Chair - Medium Height**

- Designed for use at work surfaces that are 32" - 36" tall
- 19-1/2" – 27-1/2" Adjustable height, measured from the top of the seat to the floor
- Standard back height of 10-1/4"
- Rugged polyurethane that is self-skinning, chemical- and puncture-resistant, easily cleaned, and soil resistant
- Black, non-marring casters suitable for both hard and carpeted floors
- 25" wide 5-leg nylon reinforced fiberglass base
- Weight capacity of 300 lbs.
- Includes 20" diameter chrome foot ring

Part Number	Vinyl Color
TSPMBCH-CF-RC	Black

**Arm rests can be added to the model by including "A1" at the end of the part number**

**Vinyl Stool - Medium Height**

Shown in Black

- Designed for use at work surfaces that are 32" - 36" tall
- 20-1/2" – 28" Adjustable height, measured from the top of the seat to the floor
- Backless stool
- Highly durable molded polyurethane foam cushioning covered with easily cleaned antibacterial/antimicrobial vinyl.
- Black, non-marring casters suitable for both hard and carpeted floors
- 25" wide 5-leg nylon reinforced fiberglass base
- Weight capacity of 300 lbs.
- Includes 20" diameter chrome foot ring

Part Number	Vinyl Color
TSVMBSOCFRC8546	Blue
TSVMBSOCFRC8605	Gray
TSVMBSOCFRC8540	Black
TSVMBSOCFRC8569	Burgundy
TSVMBSOCFRC8582	Navy

# Lab Furniture Accessories

## Garment Racks - Stainless Steel



Upright

- Electro-polished, Type 304 Stainless Steel hangers are included. Hangers are spaced 3" (7.6 cm) intervals
- Open wire construction promotes laminar air flow
- Unique hanger capture mechanism provides theft deterrence
- Easy to assemble
- Adjustable stainless steel triangular foot plates provided for floor mounting
- Upright unit is non-conductive.

Wall Mount	Upright	Dimensions W x D	Number of Hangers
TSGRW2436S	TSGRU2436S	36" x 24" (91.4 x 61 cm)	11
TSGRW2448S	TSGRU2448S	48" x 24" (121.9 x 61 cm)	15



Wall Mount

## Gowning Bench - Stainless Steel



- Heavy-duty, solid top bench provides a sturdy and comfortable gowning fixture. All benches are 18" (45.7 cm) tall
- Top is manufactured from 14 gauge, Type 304 stainless steel
- Adjustable stainless steel foot plates provided for floor mounting
- Unit is non-conductive

Part Number	Dimensions W x D
TSGB1636S	36" x 16" (91.4 x 40.6 cm)
TSGB1648S	48" x 16" (121.9 x 40.6 cm)
TSGB1660S	60" x 16" (152.4 x 40.6 cm)
TSGB1672S	72" x 16" (182.5 x 40.6 cm)

## MetroMax Utility Cart



Three Shelf Model

- Corrosion proof shelves, posts and Type 304 stainless steel handle
- 5" (12.7 cm) swivel casters, polyurethane wheels, poly housing and stainless steel axles
- Donut bumpers included with casters
- Furnished complete as a 2 shelf or 3 shelf unit

Part Number	Description	Dimensions W x D x H
TSMXUC1830-25	2 Shelves	18" x 30" x 39" (45.7 x 76.2 x 99.1 cm)
TSMXUC2436-25	2 Shelves	24" x 36" x 39" (61 x 91.4 x 99.1 cm)
TSMXUC1830-35	3 Shelves	18" x 30" x 39" (45.7 x 76.2 x 99.1 cm)
TSMXUC2436-35	3 Shelves	24" x 36" x 39" (61 x 91.4 x 99.1 cm)

## Security Units

- Durable chrome finish will not chip or flake
- Double doors each open 270° and can be secured along the sides of the unit
- Mobile units (4) 5" polyurethane swivel casters with bumpers
- Unit comes with top and bottom shelves and 2 internal wire shelves.
- Stationary Units are 67" tall. Mobile units are 68" tall.



Stationary Unit



Mobile Unit

Part Number	Dimensions W x D x H
TSJSEC53	36" x 24" x 67" (91.4 x 61 x 170.2cm)
TSJSEC55	48" x 24" x 67" (121.9 x 61 x 170.2 cm)
TSJSEC56	60" x 24" x 67" (152.4 x 61 x 170.2 cm)

Part Number	Dimensions W x D x H
TSMJSEC53	36" x 24" x 68" (91.4 x 61 x 172.7 cm)
TSMJSEC55	48" x 24" x 68" (121.9 x 61 x 172.7 cm)
TSMJSEC56	60" x 24" x 68" (152.4 x 61 x 172.7 cm)

## Deep Ledge Polymer Utility Cart



- Specially designed with a 2 3/4" deep ledge to contain product and spills
- Polymer shelves are easy to clean and corrosion proof
- On units with 3 shelves the center shelf adjusts at 1" increments
- Weight capacity is 400 lbs
- Blue units have built-in Microban antimicrobial product protection

Grey	Black	Blue	Dimensions W x D x H
<b>2 Shelves</b>			
TSBC2030-2DG	TSBC2030-2DBL	TSBC2030-2DMB	21 1/2" x 33 3/4" x 33 1/4" (54.6 x 85.7 x 84.5 cm)
TSBC2636-2DG	TSBC2636-2DBL	TSBC2636-2DMB	27" x 39 1/2" x 33 1/4" (68.5 x 100.3 x 84.5 cm)
<b>3 Shelves</b>			
TSBC2030-3DG	TSBC2030-3DBL	TSBC2030-3DMB	21 1/2" x 33 3/4" x 33 1/4" (54.6 x 85.7 x 84.5 cm)
TSBC2636-3DG	TSBC2636-3DBL	TSBC2636-3DMB	27" x 39 1/2" x 33 1/4" (68.5 x 100.3 x 84.5 cm)



# Lab Furniture Accessories

## Polymer Utility Cart



- Each cart comes with two labels for easy identification
- All-polymer shelves will never corrode
- Impact resistant shelves are designed to withstand daily abuse
- 7/16" (1.1 cm) shelf's edge retains small spills and prevents items from sliding off during transport
- Blue units have built-in Microban antimicrobial product protection

Grey	Black	Blue	Dimensions W x L x H
<b>2 Shelves</b>			
TSMY1627-24G	TSMY1627-24BL	TSMY1627-24BU	18 5/16" x 31 1/2" x 35 1/2" (46.5 x 80 x 90.2 cm)
TSMY2030-24G	TSMY2030-24BL	TSMY2030-24BU	23 7/16" x 34 3/8" x 35 1/2" (59.5 x 87.3 x 90.2 cm)
TSMY2636-25G	TSMY2636-25BL	TSMY2636-25BU	27 11/16" x 40 1/4" x 36 7/8" (70.3 x 102.2 x 93.7 cm)
<b>3 Shelves</b>			
TSMY1627-34G	TSMY1627-34BL	TSMY1627-34BU	18 5/16" x 31 1/2" x 35 1/2" (46.5 x 80 x 90.2 cm)
TSMY2030-34G	TSMY2030-34BL	TSMY2030-34BU	23 7/16" x 34 3/8" x 35 1/2" (59.5 x 87.3 x 90.2 cm)
TSMY2636-35G	TSMY2636-35BL	TSMY2636-35BU	27 11/16" x 40 1/4" x 36 7/8" (70.3 x 102.2 x 93.7 cm)

## Stainless Steel Work Tables with Bottom Shelf



- Seamless 14 gauge Type 304 stainless steel work surface and support structure
- Stationary work tables are 34" tall with stationary posts and leveling feet

Part Number	Dimensions D x L x H
TSWT305FS	30" x 48" x 34" (76.2 x 121.9 x 76 cm)
TSWT306FS	30" x 60" x 34" (76.2 x 152.4 x 76 cm)
TSWT307FS	30" x 72" x 34" (76.2 x 182.9 x 76 cm)
TSWT309FS	30" x 96" x 34" (76.2 x 243.8 x 76 cm)
TSWT366FS	36" x 60" x 34" (91.4 x 152.4 x 76 cm)
TSWT367FS	36" x 72" x 34" (91.4 x 182.9 x 76 cm)
TSWT369FS	36" x 96" x 34" (91.4 x 243.8 x 76 cm)
TSWT446FS	44" x 60" x 34" (111.8 x 152.4 x 76 cm)
TSWT447FS	44" x 72" x 34" (111.8 x 182.9 x 76 cm)
TSWT449FS	44" x 96" x 34" (111.8 x 243.8 x 76 cm)



## Stainless Steel Work Tables with 3-sided Frame



- Seamless 14 gauge Type 304 stainless steel work surface and support structure
- Stationary work tables are 34" tall with stationary posts and leveling feet

Part Number	Dimensions D x L x H
TSWT305US	30" x 48" x 34" (76.2 x 121.9 x 76 cm)
TSWT306US	30" x 60" x 34" (76.2 x 152.4 x 76 cm)
TSWT307US	30" x 72" x 34" (76.2 x 182.9 x 76 cm)
TSWT309US	30" x 96" x 34" (76.2 x 243.8 x 76 cm)
TSWT366US	36" x 60" x 34" (91.4 x 152.4 x 76 cm)
TSWT367US	36" x 72" x 34" (91.4 x 182.9 x 76 cm)
TSWT369US	36" x 96" x 34" (91.4 x 243.8 x 76 cm)
TSWT446US	44" x 60" x 34" (111.8 x 152.4 x 76 cm)
TSWT447US	44" x 72" x 34" (111.8 x 182.9 x 76 cm)
TSWT449US	44" x 96" x 34" (111.8 x 243.8 x 76 cm)

## Mobile Stainless Steel Work Tables



- Seamless 14 gauge Type 304 stainless steel work surface and support structure
- Mobile work tables are 34" tall with special posts and 4 poly casters (2 swivel/2 brake)

Part Number	Dimensions D x L x H
TSMWT305US	30" x 48" x 34" (76.2 x 121.9 x 76 cm)
TSMWT306US	30" x 60" x 34" (76.2 x 152.4 x 76 cm)
TSMWT307US	30" x 72" x 34" (76.2 x 182.9 x 76 cm)
TSMWT309US	30" x 96" x 34" (76.2 x 243.8 x 76 cm)

## Balance Table



- Balance tables provide a stable and vibration resistant workspace for sensitive procedures
- Work top is 2" thick
- Top, sides and middle supports are all constructed from epoxy black resin material

Part Number	Dimensions W x D x H
TSBT3624	36" x 24" x 30" (91.4 x 61 x 76.2 cm)
TSBT4824	48" x 24" x 30" (121.9 x 61 x 76.2 cm)

# Lab Furniture Accessories

## Electrical Wire Raceways



- Pre-wired single channel aluminum wire raceway with 120V, 20 amp, standard outlets or with 120V, 20 amp, GFI outlets.
- Includes 8' black power cord with plug.
- Power plug available as NEMA 5-20P straight blade or NEMA L5-20 twist-to-lock

Raceway Length	Number of Outlets	GFCI Outlets with Straight Blade Plug	GFCI Outlets with Twist-to-Lock Plug	Standard Outlet with Straight Blade Plug	Standard Outlet with Twist-To-Lock Plug
48" (121.9 cm)	4	TSEWR48GFI-S	TSEWR48GFI-T	TSEWR48-S	TSEWR48-T
60" (152.4 cm)	6	TSEWR60GFI-S	TSEWR60GFI-T	TSEWR60-S	TSEWR60-T
72" (182.9 cm)	6	TSEWR72GFI-S	TSEWR72GFI-T	TSEWR72-S	TSEWR72-T
84" (213.4 cm)	8	TSEWR84GFI-S	TSEWR84GFI-T	TSEWR84-S	TSEWR84-T
96" (243.8 cm)	8	TSEWR96GFI-S	TSEWR96GFI-T	TSEWR96-S	TSEWR96-T

## Task Lighting



- Features multiple, state of the art, energy saving components that include touch and hold continuous dimming and 10-hour automatic turnoff.
- Made with anodized aluminum and lasts up to 50,000 hours.
- **Starter Units** include 1 ea LED task light, magnetic angle mount that allows for up to 25 degrees of adjustment, 60 watt power supply with magnetic mount and 6' white cord.
- **Add On** units include 1 ea LED task light, magnetic angle mount and 1 ea interlink cord to connect to Starter Unit.
- Units for use with phenolic shelves will include a painted metal strip to attach to underside of the phenolic shelf to receive the magnet mounts.

Part Number		Actual Width of Light	For Use with
Starter Unit	Add On Unit		
TSLED-36S	TSLED-36AO	23.3" (59.2 cm)	36" Wide Metal Cabinet
TSLED-48S	TSLED-48AO	30.1" (76.5 cm)	48" Wide Metal Cabinet
TSLED-24S	TSLED-24AO	16.4" (41.7 cm)	24" Wide Phenolic Shelf
TSLED-3036S	TSLED-3036AO	23.3" (59.2 cm)	30" or 36" Wide Phenolic Shelf
TSLED-4248S	TSLED-4248AO	30.1" (76.5 cm)	42" or 48" Wide Phenolic Shelf
TSLED-60S	TSLED-60AO	43.7" (111 cm)	60" Wide Phenolic Shelf

## Chase Support Assembly



- An adjustable height floor mounted, support assembly for work surfaces as well as drain line and a plumbing chase for piping

Part Number	Dimensions H x D
TSCSA3108	27"-31" x 8" (68.6-78.7 x 20.3 cm)
TSCSA3708	33"-37" x 8" (83.8-94 x 20.3 cm)

## Cabinet Base Molding



- Base molding is installed directly on the toe-kick of a base cabinet and is the final step in installing a lab to create a finished look
- The base molding has a self-adhesive back for easy application

Part Number	Dimensions H x L
TSVBM48	4" x 48" (10.2 x 121.9 cm)

## Wall Mounted Cylinder Restraints

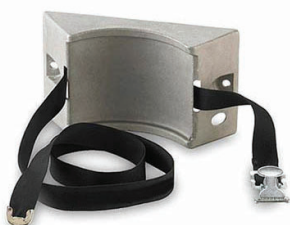

- Cast aluminum, wall mounted cylinder restraint
- Includes mounting hardware and a nylon strap
- The restraints can be placed adjacent to each other to secure a group of cylinders

Part Number	Cylinder Diameter
TSCRWM	4"-14" (10.2 - 35.6 cm)

## Free Standing Cylinder Restraints



- The free standing cylinder restraint is constructed from 2" x 2" tubular steel
- A fully welded design provides for the proper restraint of cylinders
- Includes security chains

Part Number	Number of Cylinders	Dimensions W x D x H
TSCRFM2X1 (2 Cylinders x 1 bay)	2	30" x 16" x 30" (76.2 x 40.6 x 76.2 cm)
TSCRFM2X2 (2 Cylinders x 2 bay)	4	30" x 32" x 30" (76.2 x 81.3 x 76.2 cm)
TSCRFM2X3 (2 Cylinders x 3 bay)	6	30" x 48" x 30" (76.2 x 121.9 x 76.2 cm)
TSCRFM3X1 (3 Cylinders x 1 bay)	3	45" x 16" x 30" (114.3 x 40.6 x 76.2 cm)
TSCRFM3X2 (3 Cylinders x 2 bay)	6	45" x 32" x 30" (114.3 x 81.3 x 76.2 cm)
TSCRFM3X3 (3 Cylinders x 3 bay)	9	45" x 48" x 30" (114.3 x 121.9 x 76.2 cm)

# What's Important for Designing a Lab Space

Your project might involve the renovation of an old lab or building a new one. Our experienced team is ready and available to help lead you through the process. The pages that follow provide an overview of this process. We are looking to help build your information base and to make your interaction with our team more productive.

### Part 1 - Understand the space being considered

Survey the area being considered for the laboratory. Think of the overall amount of space that will be required for the people, process and equipment that will occupy the lab. Be careful to ensure that all the necessary utility services and sanitary or chemical drains will be available. If you'll need a fume hood, make sure you review an exit route for ducting. Always consider the future needs of your facility.

### Part 2 - Select a Casework Layout

Select a casework layout that best suits your space and complies with established safety guidelines. Please pull our team in as required to help generate some sample layouts.

### Part 3 - Outfitting Your Lab

Make a list of all the components your lab will need. Remember to include cabinets, countertops, fixtures, fume hoods, biological safety cabinets, cold rooms, cleanrooms, water purification systems, bench top equipment, refrigerators, seating, etc. One of our Lab Furnishing Specialists will help you complete the project planning, prepare a pricing proposal and be the one point of contact for your project through the installation process.

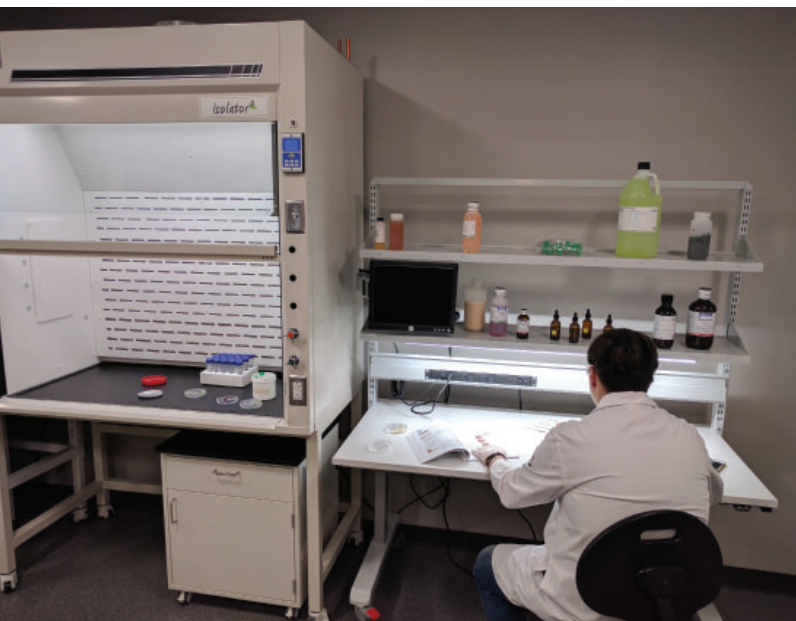

# Laboratory Layout & Design Considerations

Following is a basic set of considerations for general laboratory layout & design. It is not intended to be a comprehensive, but it will be helpful in the review of the needs & requirements for most laboratories. This information will form a sound foundation for the interaction with our lab design team on the layout of furnishings for your lab.

1. Determine the general purpose of each lab, support or work space
  - Number of people
  - Amount of bench required per person or per operation
  - Number of fume hoods or biological safety cabinets needed
2. Confirm the rough lab spaces & sizes needed and their locations within the building
  - Review service runs required
  - Confirm the floor to deck space in the labs
  - Inspect proposed mechanical distribution and passageways
3. Engage your Environmental Health & Safety person as well as Facilities Operations & Maintenance for input
4. Develop a lab equipment listing reflecting the sizes of each piece, service requirements and respective heat loss
  - Confirm if the equipment will fit on the bench or floor. Consider your future operations.
  - All equipment should be placed into a plan view drawing to confirm fit
  - Review overall voltages and total amperage needed for the project
  - Review venting requirements, data connections, and any ancillary equipment needed
5. Examine the proposed lab layout & workflow
  - Confirm that the lab will fit the process
6. Review the need for flexible, open, lab space in the lab layout, consider future needs
7. From a historical perspective, review what's working and not working in the current lab
8. Review specific needs within the lab for:
  - Radioactive or biological materials
  - Hazardous operations
  - ADA compliance
  - Access for rolling equipment
9. Confirm the need for ancillary lab space or other space that makes the rest of the lab work more efficiently:
  - Sample receiving
  - Work in process
  - Glass wash/prep areas
  - Equipment support space
  - Offices or desk spaces
10. Examine lab storage needs
  - Supplies
  - Glassware
  - Chemicals
  - Samples
  - Receiving
11. Review hood selection and distribution in the lab
  - They should be sized to safely fit the purpose
  - Provide access for people, equipment, & process
  - Positioned correctly within the lab
  - Confirm plumbed and wired service needs
  - Confirm the HVAC requirements and the need for both supply and exhaust air systems
12. Confirm the effective separation of lab areas:
  - Lab and Office
  - Higher and Lower areas of hazard or chemical use
  - Sinks & electronics
  - Safety showers & electronics
  - Centrifuges and balances
13. Review needed availability & service distribution in the lab
  - Deck mounted pedestals
  - Wall mounted fittings
  - Overhead service panels
14. Review lab lighting & orientation for effective illumination of the work spaces
15. For sinks, review location, size, purpose & services needed
16. Confirm locations for:
  - Coat racks
  - Safety Glasses
  - Gloves
  - Shoe covers
  - Tack mats
17. Review room air changes needed within the lab and storage spaces
18. Review aisle way clearances
  - Code considerations
  - Passage of equipment
  - Avoid back to back chair arrangements
19. Confirm the placement of all lab safety fixtures and equipment
  - Eye washes
  - Safety showers
  - Fire blankets
20. Review the need for controlled access to the lab and support spaces



# Developing Project Goals

Your project timeline could be as little as a few weeks to as much as a few years. We are here to help minimize this process. We can help to formulate a clear understanding of the project goals and navigate normal project pitfalls.

### A Project Team Needs to be Selected

The team will need a captain to ensure that the project will run smoothly. The team should consist of the people who understand all elements of the project, from the fundamental design to how it will suit current objectives and future requirements. The team will be responsible for establishing budgets and developing schedules.

### The Team Should Include:

1. Facilities Operations and Management - These are the people to help determine if the design meets facility guidelines, maintenance requirements, and available utilities.
2. The Health and Safety Officer at the facility to ensure compliance with site, state and federal safety codes and guidelines
3. Laboratory Management for the lab space
4. Individuals that will be using the lab space
5. One of our Lab Furniture Specialists

The team captain needs to organize the members and guide them on their contribution to the project. That person will document details, developments, changes, and keep the project on track.





Your lab project starts with an understanding of all room dimensions and details. We can help refine the rough initial details gathered and create an accurate drawing of the space. Pictures of the lab space can help communicate with the project team and keep a record of activity.

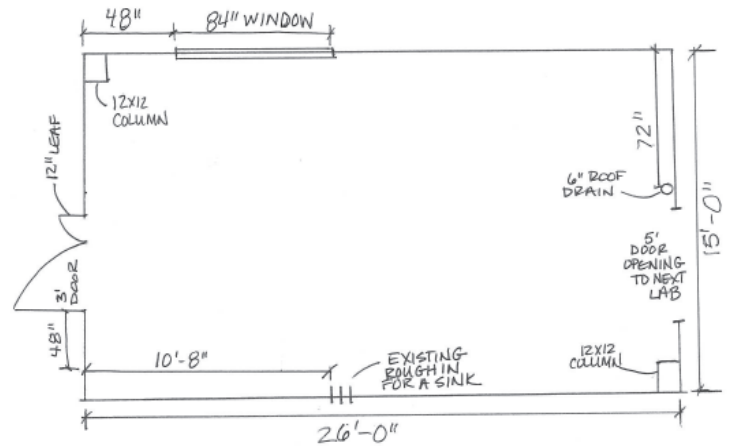

1. Measure all walls and confirm the ceiling height
2. Confirm the sizes and positions of all doors and windows. For the windows it's important to note their height off the floor
3. Measure and mark all:
  - Columns
  - Floor drains
  - Utility connections on the wall or floor
  - Other obstructions within the room

Remember, layers of information will need to be gathered on any project. A member of our CAD team can quickly take a hand sketch and create a scaled drawing for further comment or action.

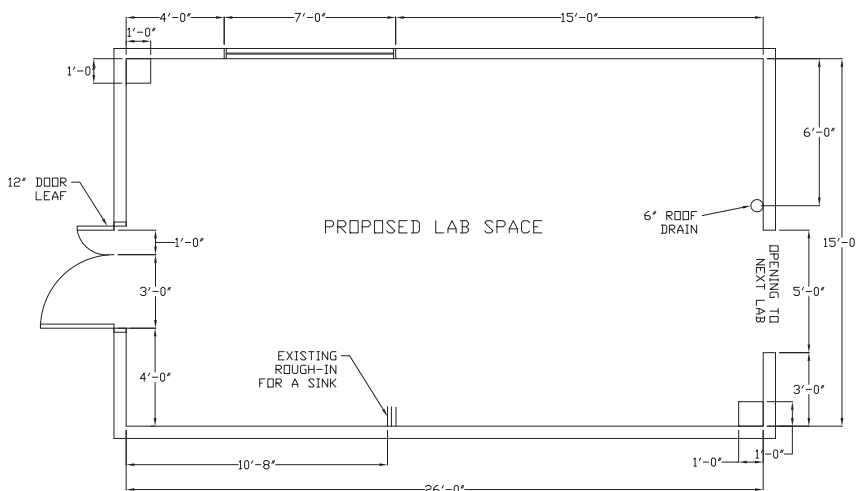

91

## Elements of a Safe and Efficient Lab

One of our Lab Furniture Specialists is available to assist with the programming of your lab project.

### Work Areas

- Provide adequate space at each bench for equipment to be placed and the process to be performed.
- Provide adequate space within the lab and between each bench for planned and future workflow and required egress and ingress.
- Consider all planned and future free standing lab equipment

### Storage and Equipment Areas

- Storage and equipment areas should have appropriate ventilation and be sufficient in size
- All equipment should include a grounded plug. Review any older equipment to be used.

### Chemical Storage Areas

- A chemical use assessment should be performed for the project
- Chemical storage should be secure but provide for safe and convenient retrieval
- Provide space adequate for the segregation and ventilation of chemicals
- Separate storage should be provided for flammables, acids, and corrosives

### Safety Equipment

- Install eyewash stations within 10 seconds of unobstructed walking time from the location of a hazard
- Install safety showers within 10 seconds of unobstructed walking time from the location of a hazard

### Services and Utilities

- A free standing and bench top equipment spreadsheet should be generated. Among other details, this spreadsheet should include information on all services required by equipment item number.
- Consideration should be given to electricity, plumbed and bottled gas, hot and cold water, and drainage required for equipment.
- Consider centralized safety and servicing shutoffs for all utilities
- Consider telephone, data and low voltage systems

### Traffic Patterns and Spaces

- All rooms should have at least two forms of egress
- Minimum aisleway clearance is 42"
- Fume hoods should be located away from main traffic aisles or doorways
- Doors should be inset and open outward

### Lab Ventilation

- Understand the use of all chemicals and biological elements for the lab space
- Chemical fume hoods require a supply air source and are vented to the exterior of the building
- Ventilation should be considered based upon the procedure or equipment being used
- The equipment listing mentioned in the Services and Utilities section should include the potential heat gain to the lab. This heat gain needs to be considered when sizing the HVAC system for the project
- Lab ventilation should be a minimum of 4 exchanges per hour
- Exhaust fans should be located outside and on the roof of the building

## Lab Reference Sources

The references in print as well as the websites listed provide a wealth of detailed information. Whether you are building a new laboratory space or updating an old one, these references will help with developing good laboratory layouts that are safe and are compliant with regulations.

### Printed Resources

#### American Chemical Society, Safety in Academic Chemistry Laboratories American Chemical Society

This guide is available from the American Chemical Society's Office of Society Services by calling 800-227-5558. (Note: Available free from ACS)

#### Laboratory Design Handbook

By: E. Crawley Cooper

The Laboratory Design Handbook describes the process, motivation, constraints, challenges, opportunities, and specific design data related to the creation of a modern research laboratory. The information presented is based on a large pool of experience in the development of new and renovated laboratory buildings for universities, teaching hospitals, pharmaceutical companies, start-up biotechnology companies, and other types of industrial technology. CRC Press, ISBN 9780849389962 - CAT# 8996

#### Prudent Practices in the Laboratory: Handling and Management of Chemical Hazards

Prudent Practices in the Laboratory has served for decades as the standard for chemical laboratory safety practice. Developed by experts from academia and industry, with specialties in such areas as chemical sciences, pollution prevention, and laboratory safety. It provides guidance on planning procedures for the handling, storage, and disposal of chemicals. Designed to promote safety and includes practical information on assessing hazards, managing chemicals, disposing of wastes. National Academies Press, ISBN 0309138647, 9780309138642

### Web Resources

#### Lab Planning

[www.labplan.org](http://www.labplan.org)

This website (the result of a planning study performed by the National Science Foundation) suggests a planning process and offers criteria and standards that can help determine what additional or improved facilities are needed for programs. This interactive website follows the structure of the planning process and provides the tools, guidelines, and data necessary to plan and design high school science, math, and technology education teaching spaces

#### Americans with Disabilities Act (ADA)

[www.ada.gov](http://www.ada.gov)

Information on the ADA including relevant publications, federal resources, ADA design standards, technical assistance program, enforcements, code certification, business connections, status reports, new and proposed regulations, and the ADA program.

#### Occupational Safety and Health Organization (OSHA)

[www.osha.gov](http://www.osha.gov)

Complete reference source for OSHA compliance including assistance, grants, cooperative programs, safety and health topics, statistics, US-EU cooperation, and service standards.

#### National Science Teacher's Association

[www.nsta.org](http://www.nsta.org)

Information provided focuses on the teaching environment, from elementary to college classrooms. Paid membership enables access to journals and books. NSTA recommendations, the latest news, conventions, supplier's guide, and discussion boards.

#### American National Standards Institute (ANSI)

[www.ansi.org](http://www.ansi.org)

This is a paid membership website that offers documents on laboratory ventilation (Z9.5) for both rooms and fume hoods as well as information on American National Standards including procedures, guides and forms, accreditation requirements, appeals requirements, audit requirements, and governance committees. The site also provides information on IEC programs, regional programs, ISO programs, the standards boards, and panels.

#### National Science Education Leadership Association

[www.nsela.org](http://www.nsela.org)

This official website of the NSELA is dedicated to providing national leadership in efforts to improve science education. The quarterly newsletter is posted along with operations manuals, by-laws, career postings, and publications.

#### National Fire Protection Association (NFPA)

[www.nfpa.org](http://www.nfpa.org)

Website dedicated to providing research information, public education, professional development as well as fire protection information, and flammable materials storage guidelines. This paid subscriber services offers many of the NFPA codes online.

#### Scientific Equipment and Furniture Association (SEFA)

[www.sefalabs.com](http://www.sefalabs.com)

This official website for SEFA gives paying members guidelines on construction and performance of laboratory equipment and furniture. Links to member companies offering laboratory products and laboratory design are provided.

## General Plumbing Details

### Minimum Spacing Between Fixtures

The drawing below show the allowable minimum spacing between service fittings on laboratory bench top.

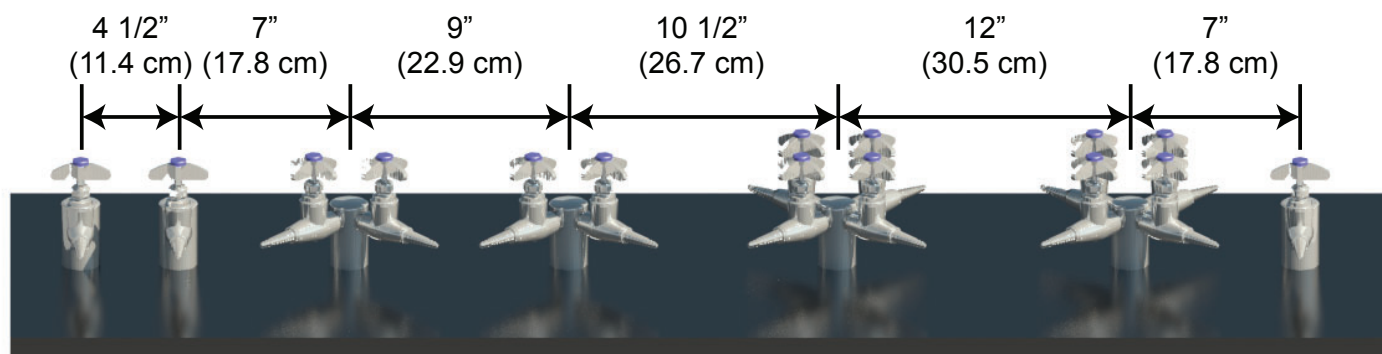

### Service and Rough-In Designations and Color Coding

Designation	Service	Color
E	Electric (120 Volt AC)	-
DT	Data	-
A	Air	Orange
G	Gas	Dark Blue
V	Vacuum	Yellow
N	Nitrogen	Brown
O	Oxygen	Light Green
S	Steam	Black
CW	Cold Water	Green
HW	Hot Water	Red
DW	Distilled Water	White
W	Waste	-
WV	Waste Vent	-

### Recommended Supply Line Pressures

Service	Pressure
Hot and Cold Water	Local Pressure
Gas	0.216 psi
Air (Ordinary)	15 psi
Air (Air Powered Stirrer Operation)	40 psi
Vacuum (Ordinary)	18-22" of Mercury
Vacuum (High)	28.5" of Mercury
Steam (Low Pressure)	0-15 psi as required
Steam (High Pressure)	15-30 psi as required

## NFPA Labeling and NEMA Details

### NFPA Chemical Container Labeling

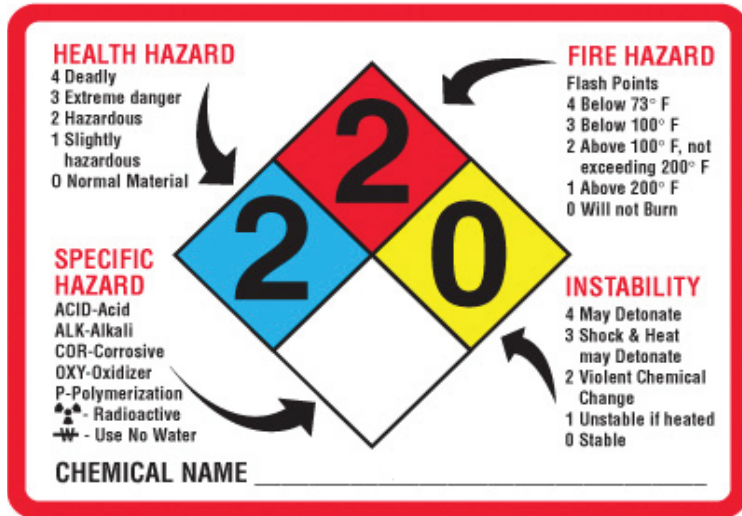

### Conversion Chart

To Convert From	To	Multiply By
Milliliters	Ounces	0.03381497
Millimeters	Inches	0.039370079
Ounces	Liters	0.029572702
Liters	Gallons	0.2641794
Pounds	Kilograms	0.45359237
Centimeters	Inches	0.39370079
Cubic Feet	Liters	28.31605
Cu. ft./min.	Liters/sec.	0.4719342
Cu. meters/min.	Liters/min.	999.972
Feet	Centimeters	30.48
Feet/minute	Meters/sec	0.00508
Gallons	Liters	3.785306
Gal./sec	Liters/min.	227.1183
Horsepower	Btu/hr	2547.16
Horsepower	Watts	746
Inches	Centimeters	2.54
Kilograms	Pounds	2.2046226
Kilowatts	Btu/hr	3414.43
Meters/sec	Feet/min.	196.85039
Watts	Btu/hr	3.41443

### NEMA Electrical Information

	Receptacle	Plug
120 Volts AC 15 amps	 5-15R	 5-15P
120 Volts AC 20 amps	 5-20R	 5-20P
120 Volts AC 30 amps	 5-30R	 5-30P
250 Volts AC 15 amps	 6-15R	 6-15P
250 Volts AC 20 amps	 6-20R	 6-20P
250 Volts AC 30 amps	 6-30R	 6-30P
120 Volts AC 20 amps Twist Lock Single Circuit	 L5-20R	 L5-20P
120 Volts AC 20 amps Twist Lock Double Circuit	 L14-20R	 L14-20P





**Contact Us:**  
1654 High Hill Road.  
Swedesboro, NJ 08085  
**Phone:** 800-345-2100  
[www.thomassci.com](http://www.thomassci.com)

